

**DEPTH TO HATCH OPTIONS, INCORPORATING ADDITIONAL BACK BOARD WITH ADJUSTABLE STEPS**

DEPTH TO HATCH FROM TOP OF STAIR UNIT CASING	BILCO UNIT OPTION
UP TO 1000mm	BL-ZBOXBB1: BACKBOARD UP TO 1000mm HIGH x UP TO 1200mm WIDE, WHITE COATED MULTIPLEX BOARD, FITTED WITH ADDITIONAL TREADS (2-3), WITH GRAB RAILS
1001mm TO 1250mm	BL-ZBOXBB2: BACKBOARD 1001mm TO 1250mm HIGH x UP TO 1200mm WIDE, WHITE COATED MULTIPLEX BOARD, FITTED WITH ADDITIONAL TREADS (3-4), WITH GRAB RAILS
1251mm TO 1500mm	BL-ZBOXBB3: BACKBOARD 1251mm TO 1500mm HIGH x UP TO 1200mm WIDE, WHITE COATED MULTIPLEX BOARD, FITTED WITH ADDITIONAL TREADS (4-5), WITH GRAB RAILS
1501mm TO 2000mm	BL-ZBOXBB4: BACKBOARD 1501mm TO 2000mm HIGH x UP TO 1200mm WIDE, WHITE COATED MULTIPLEX BOARD, FITTED WITH ADDITIONAL TREADS (5-6), WITH GRAB RAILS

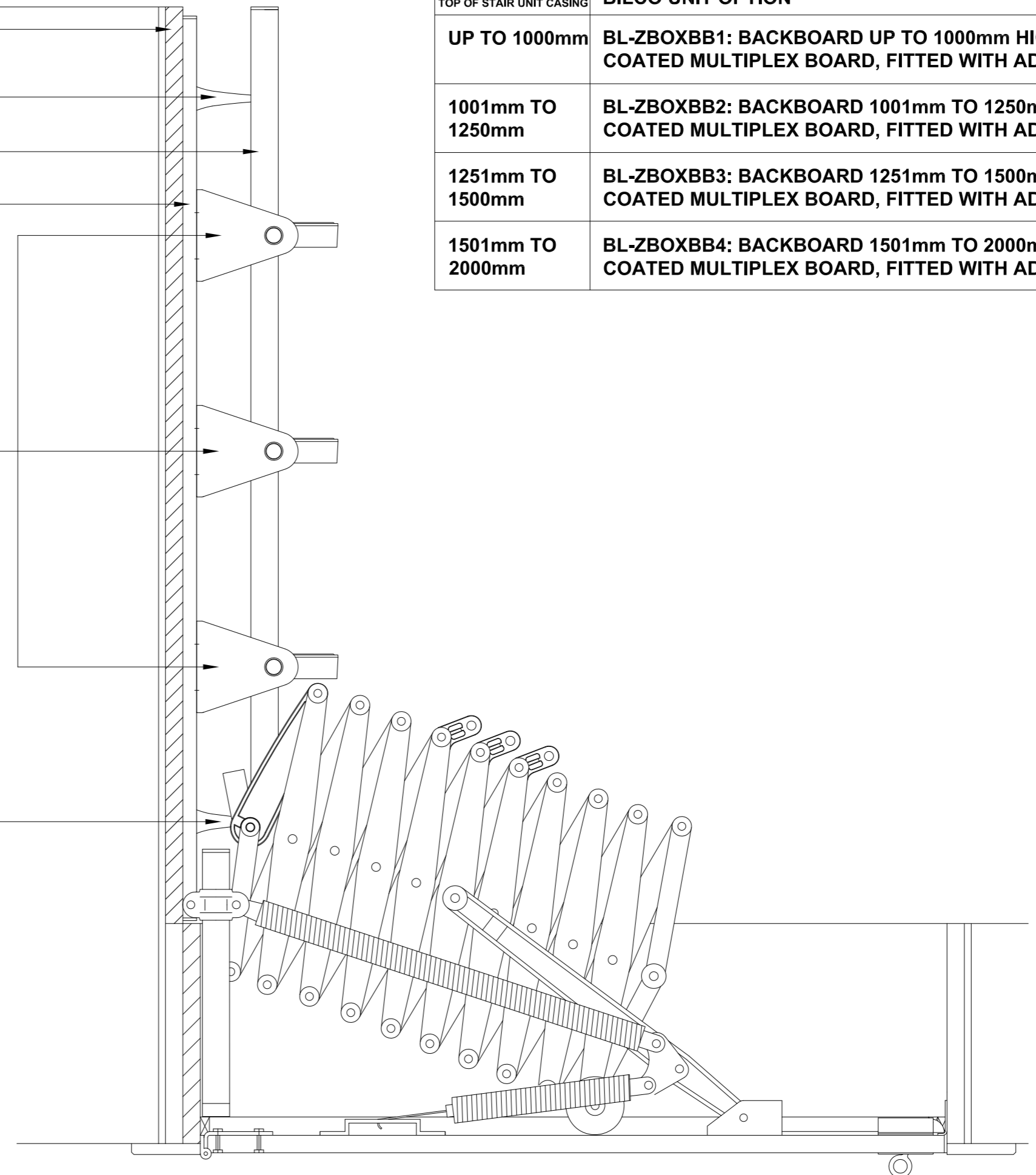

Bilco UK Ltd.  
Park Farm Business Centre  
Fornham St. Genevieve  
Bury St Edmunds  
Suffolk  
IP28 6TS

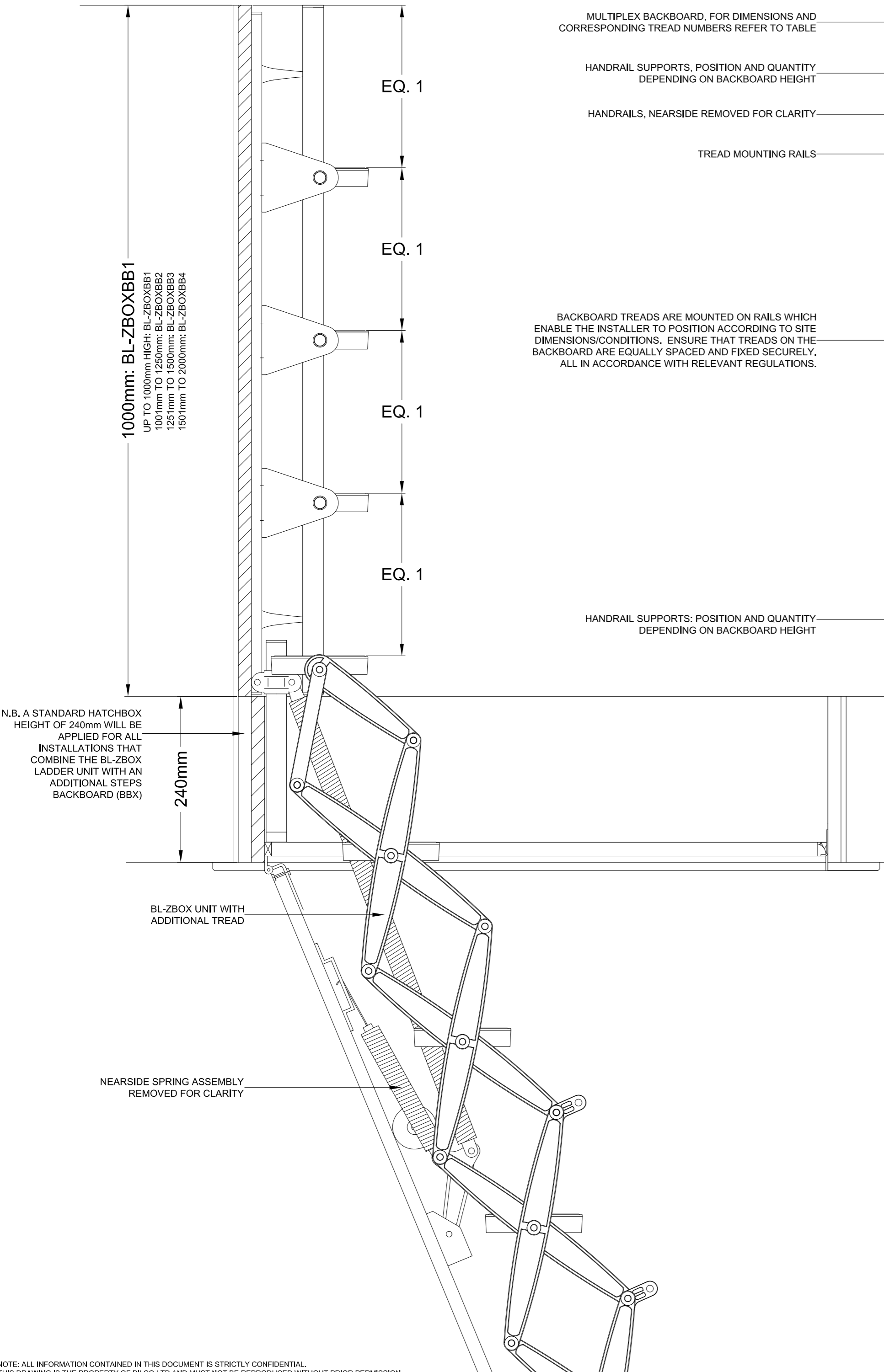

Issue status:		Drawing Title:		Scale:
		BL-ZBOXBB1: UP TO 1000mm HIGH BL-ZBOXBB2: 1001mm TO 1250mm BL-ZBOXBB3: 1251mm TO 1500mm BL-ZBOXBB4: 1501mm TO 2000mm		1:1
		All dimensions in mm		Sheet: PLOT AT A2 1:5 Issue:
First Issue	09/2015	J.P.	© All rights reserved	Do not scale drawings
Issue	Description	Date	Name	Filename: BL-ZBOXBB1-BB4.DWG
				Project: Standard Issue

NOTE: ALL INFORMATION CONTAINED IN THIS DOCUMENT IS STRICTLY CONFIDENTIAL. THIS DRAWING IS THE PROPERTY OF BILCO LTD AND MUST NOT BE REPRODUCED WITHOUT PRIOR PERMISSION.