

ROOF ACCESS
HATCHES

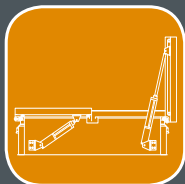

SMOKE VENTS

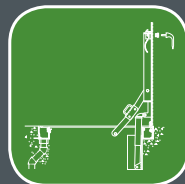

FLOOR ACCESS



SAFETY
PRODUCTS



LADDERS

The Worldwide Source for Speciality Access Products



BILCO HISTORY

The Bilco Company was established in America in 1926 and has for many decades designed and supplied access products for construction and engineering industries all over the world. The company has been a pioneer in the development of a unique line of horizontal access products and in 1989 Bilco UK & Europe was formed and has since built a reputation amongst architects, engineers, specifiers and the construction trades for providing the right access solutions.

Since June 2016, Bilco has been a part of Tyman PLC and remains committed to delivering excellent service and products to its markets.

BILCO TODAY

Based in Suffolk, Bilco can supply the trade with a range of standard roof hatches, smoke vents, ladders and floor doors in various sizes and materials direct from stock, delivered by a nationwide palletline system or dedicated consignment. Standard items are delivered anywhere in the UK in 3-4 working days and best of all, there's no extra charge. If a special product is required, the fast-track shop allows delivery in an industry-leading 4-6 weeks.

Bilco also provides technical assistance for more complex product requirements. The technical department will assist you to develop a creative design solution for your unique applications. Quality access products comply with current Building Regulations & Legislation, and are engineered to provide many years of trouble-free service.

OUR COMMITMENT

Bilco products are designed and fabricated to consistently high quality standards to ensure complete customer satisfaction. As part of its commitment, Bilco has implemented a company-wide quality system, which has achieved ISO 9001 and 14001 accreditation. The Bilco Company is committed to producing access products that are unequalled in quality, design and workmanship.

OUR GUARANTEE

Warranty is for a minimum period of ten years from the date of purchase. Electric motors, special finishes and other special equipment, if applicable, are covered separately.



QR CODES - HOW TO USE AND WHY



Throughout this brochure there are a series of QR codes which you can simply scan with your smart phone and they will take you through to further information on the product, from informative videos to full technical details such as BIM details, CAD drawings and NBS specifications.



Bilco UK, Bury St. Edmunds, Suffolk, England

CONTENTS

ROOF ACCESS HATCHES	4-11, 62-64
SMOKE VENTS	12-19, 62-64
FLOOR ACCESS	20-43, 65
SAFETY PRODUCTS	44-45
LADDER PRODUCTS	46-55
STEP-OVER LADDERS	56-57
ROOF MOUNTED WALKWAY	58-59
ROOF EDGE PROTECTION	60-61

ROOF ACCESS SOLUTIONS

Ladder Access,
Types S, E and GS



LADDER ACCESS SOLUTIONS

Roof Hatches Type S, Type E	6
Roof Hatches Type GS	7
Other roof access products	8-11
Fixed Vertical Ladders	48-50
Retractable Ladders	52-53
Ladder up Safety Post	44
Bil-Guard® Hatch Rail System	45
Additional Options	62-64

Companionway
Type CS



ACCESS SOLUTIONS

Roof Hatches Type CS	8
Companionway Ladders	51
Retractable Ladders	52-53
Bil-Guard® Hatch Rail System	45
Additional Options	62-64

Service Stair,
Type L, Type SSY



SERVICE STAIR ACCESS SOLUTIONS

Roof Hatches Type L, Type SSY	9
Bil-Guard® Hatch Rail System	45
Additional Options	62-64



Roof Hatches

New enhanced specification on all roof access hatches

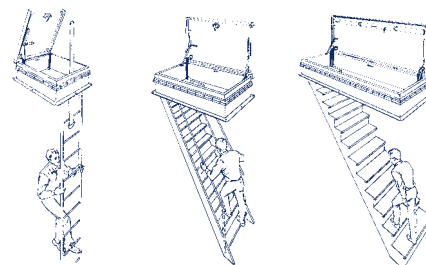

Ladder Access, Companionway and Service Stair products all have optional extras available.

Bilco roof hatches provide safe and convenient roof access by means of an interior ladder, ship stair, or service stair. Larger sized hatches are also available to facilitate the easy movements of equipment to and from a building. Each aluminium hatch comes with a 10 year guarantee. The curb upstand is manufactured with a cap-flashing that includes the Bilclip® flashing system which accepts a variety of felts and membranes. As a result installation time and related costs are greatly reduced and a more effective mechanical termination which does not rely on adhesives alone is provided. Alternatively a metal curb liner can be specified to make site installation easier, ideally suited for hot-works, wet applied waterproofing and standing seam roofs. Customised designs are also available which can feature security options, motorised operation, a range of paint finishes and safety aids.



Key Features and Benefits

- Weathertight construction
- Thermally broken construction
- Fully insulated and gasketed for energy efficiency
- Lift assistance for smooth, easy, one-hand operation
- Corrosion-resistant hardware
- Bilclip® Flashing System for ease of installation
- Custom sizes and options are readily available
- Meets the requirements of manual handling regulations
- Hatches can be specified with curb liners.

Typical Applications

- Banks
- Prisons
- Factories
- Fast Food Restaurants
- Gymnasiums
- Hospitals
- Hotels
- High-Rise Housing
- Office Buildings
- Manufacturing Plants
- Schools
- Shopping Centres
- Storage Facilities
- Distribution Depots
- Warehouses
- Care Homes





Heavy duty slam latch securely locks cover in the closed position. Interior and exterior hasps provide additional security.



Rugged hold-open arm automatically locks the cover in the open position. Grip handle allows for easy, one-hand release and closing.



Aluminium construction with thermal breaks to minimise heat transfer between inside and outside



Curb Liners - Hatches can be fitted with curb liners to make site installation easier. See suffix CL.



Top side latch with turn handle and padlock hasp.

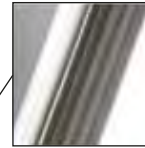

Newly designed closed cell EPDM sponge gasket, helps meet Building Regulations air leakage targets by providing a better seal of the cover to the curb, ensuring complete weather-tightness. Air leakage performance $4.83\text{m}^3/\text{hr}/\text{m}^2 @ 600 \text{ Pa}$. Tested to BS EN 12207: 2000.



Fully enclosed compression springs counter balance the cover for smooth, easy and controlled operation regardless of cover size or weight. Bilco hatches meet the requirements of Manual Handling Regulations.



Insulated curb with cap flashing and Bilclip® flashing system. Installation is simply a matter of placing the hatch over the roof opening and securing it to the roof deck through the holes provided in the base flange. The integral cap flashing readily accepts roofing membranes reducing installation time and costs.



TESTED AT THE NATIONAL PHYSICAL LABORATORY

PERFORMANCE

BS EN 12207:2000	Air Permeability $4.83\text{m}^3/\text{hour}/\text{m}^2$ at 600Pa
BS EN 12208:2000	Water Tightness Class 9A
BS EN 12210:2000	Wind Resistance Class E2400
BS EN 1991-1	Snow Load 1200Pa for 1 hour
BS 8200	Impact Resistance Pass
BS EN ISO 140	Acoustic 25dB
BS EN 1627 - 1630	Security Pass
Wind Speed	With Open Cover 30m/s

Fully insulated cover and curb. 75mm thick faced rigid polyisocyanurate thermal insulation board. U value of $0.278\text{Wm}^2/\text{K}$ (homogeneous situation).



Ladder Access

Type S-50TB and Type E-50TB. Aluminium

Easy one-handed operation to fully open or closed position provides the user the security of having one hand firmly on the ladder at all times.

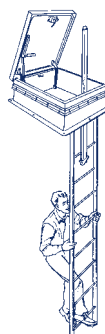

S-50TB



E-50TB



Type S-50TB

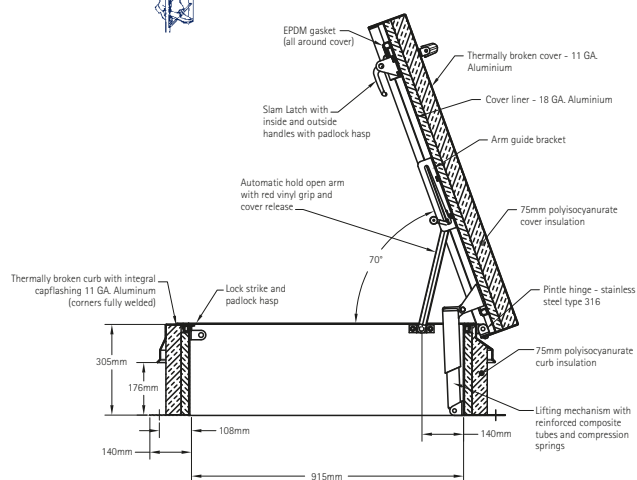

SPECIFICATIONS

Furnish and install where indicated on plans, thermally broken metal roof hatch. Length denotes hinge side. These roof hatches shall be single leaf. The roof hatch shall be pre-assembled from the manufacturer.

Performance characteristics: Cover and curb shall be thermally broken to prevent heat transfer between interior and exterior surfaces.

Cover shall be reinforced to support a minimum live load of 195kg/m² with a maximum deflection of 1/150th of the span or 97kg/m² wind uplift.

Operation of the cover shall be smooth and easy with controlled operation throughout the entire arc of opening and closing.

Operation of the cover shall not be affected by temperature.

Entire hatch shall be weather tight with fully welded corner joints on cover and curb

Cover: Shall be 2.3mm aluminium with a 127mm beaded flange with formed reinforcing members. Interior and exterior surfaces shall be thermally broken to minimize heat transfer and to resist condensation. Cover shall have a heavy extruded EPDM rubber gasket bonded to the cover interior to assure a continuous seal when compressed to the top surface of the curb.

Cover insulation: Shall be 75mm thick polyisocyanurate fully covered and protected by a 1mm aluminium liner.

Curb: Shall be 305mm in height and of 2.3mm aluminium. Interior and exterior surfaces shall be thermally broken to minimize heat transfer and to resist condensation. The curb shall be formed with a 140mm flange with 11mm holes provided for securing to the roof deck. The curb shall be equipped with an integral metal capflashing of the same gauge and material as the curb, fully welded at the corners, that features the Bil-Clip® flashing system, including stamped tabs, 153mm on center, to be bent inward to hold single ply roofing membrane securely in place.

Curb insulation: Shall be 75mm thick polyisocyanurate.

Lifting mechanisms: Manufacturer shall provide compression spring operators enclosed in telescopic tubes to provide, smooth, easy, and controlled cover operation throughout the entire arc of opening and closing. The upper tube shall be the outer tube to prevent accumulation of moisture, grit, and debris inside the lower tube assembly. The lower tube shall interlock with a flanged support shoe welded to the curb assembly.

Hardware: Heavy stainless steel pintle hinges shall be provided. Cover shall be equipped with a spring latch with interior and exterior turn handles. Roof hatch shall be equipped with interior and exterior padlock hasps. The latch strike shall be a stamped component bolted to the curb assembly. Cover shall automatically lock in the open position with a rigid hold open arm equipped with a 25mm diameter red vinyl grip handle to permit easy release for closing. Compression spring tubes shall be an anti-corrosive composite material and all other hardware shall be zinc plated and chromate sealed (for installation in highly corrosive environments or when prolonged exposure to hot water or steam is anticipated, specify Type 316 stainless steel hardware). Cover hardware shall be bolted into heavy gauge channel reinforcing welded to the underside of the cover and concealed within the insulation space.

Finish: Factory finish shall be mill finish aluminium.

Options: See pages 62-64 and Ladders pages 46-55.

STANDARD SIZES and WEIGHTS

Type	Size - clear internal dimensions	Overall dimensions	Weight
S-50TB	915mm x 760mm (H)	1195mm x 1040mm	60kg
S-50TB CL	915mm x 760mm (H)	1195mm x 1040mm	66kg
E-50TB	915mm x 915mm	1195mm x 1195mm	63kg
E-50TB CL	915mm x 915mm	1195mm x 1195mm	70kg

50 - Aluminium (H) - Hinge Side CL - Curb Liner



Ladder Access

Type GS-50TB. Aluminium

All the security and convenience of the Type S roof hatch with the added benefits of a skylight.

GS Roof Hatches feature aluminium construction and virtually indestructible polycarbonate domes.



GS-50TB



Type GS-50TB

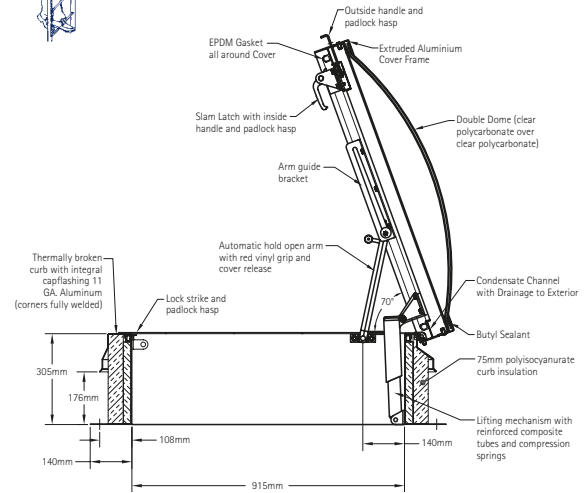
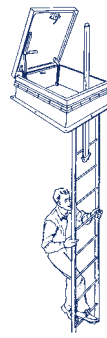

SPECIFICATIONS

Furnish and install where indicated on plans, thermally broken metal roof hatch. Length denotes hinge side. The roof hatch shall be single leaf. The roof hatch shall be pre-assembled from the manufacturer.

Performance characteristics: Curb shall be thermally broken to prevent heat transfer between interior and exterior surfaces.
Cover shall be reinforced to support a minimum live load of 195kg/m² with a maximum deflection of 1/150th of the span or 97kg/m² wind uplift.
Operation of the cover shall be smooth and easy with controlled operation throughout the entire arc of opening and closing.
Operation of the cover shall not be affected by temperature.
Entire hatch shall be weather tight with fully welded corner joints on cover and curb.

Cover: Aluminium extrusion with built in drainage channel and double skin clear polycarbonate dome. Cover shall have a heavy extruded EPDM rubber gasket bonded to the cover interior to assure a continuous seal when compressed to the top surface of the curb.

Curb: Shall be 305mm in height and of 2.3mm aluminium. Interior and exterior surfaces shall be thermally broken to minimize heat transfer and to resist condensation. The curb shall be formed with a 140mm flange with 11mm holes provided for securing to the roof deck. The curb shall be equipped with an integral metal capflashing of the same gauge and material as the curb, fully welded at the corners, that features the Bil-Clip® flashing system, including stamped tabs, 153mm on center, to be bent inward to hold single ply roofing membrane securely in place.

Curb insulation: Shall be 75mm thick polyisocyanurate.

Lifting mechanisms: Manufacturer shall provide compression spring operators enclosed in telescopic tubes to provide, smooth, easy, and controlled cover operation throughout the entire arc of opening and closing. The upper tube shall be the outer tube to prevent accumulation of moisture, grit, and debris inside the lower tube assembly. The lower tube shall interlock with a flanged support shoe welded to the curb assembly.

Hardware: Heavy stainless steel pintle hinges shall be provided. Cover shall be equipped with a spring latch with interior and exterior turn handles.
Roof hatch shall be equipped with interior and exterior padlock hasps.
The latch strike shall be a stamped component bolted to the curb assembly.
Cover shall automatically lock in the open position with a rigid hold open arm equipped with a 25mm diameter red vinyl grip handle to permit easy release for closing.
Compression spring tubes shall be an anti-corrosive composite material and all other hardware shall be zinc plated and chromate sealed (for installation in highly corrosive environments or when prolonged exposure to hot water or steam is anticipated, specify Type 316 stainless steel hardware).
Cover hardware shall be bolted into heavy gauge channel reinforcing welded to the underside of the cover and concealed within the insulation space.

Finish: Factory finish shall be mill finish aluminium.

Options: See pages 62-64 and Ladders pages 46-55.

STANDARD SIZES and WEIGHTS

Type	Size - clear internal dimensions	Overall dimensions	Weight
GS-50TB	915mm x 760mm (H)	1195mm x 1040mm	64kg
GS-50TB CL	915mm x 760mm (H)	1195mm x 1040mm	70kg
GSS-50TB	Special sizes on request		

50 - Aluminium (H) - Hinge Side CL - Curb Liner
Special sizes available on request.





Companionway Access

Type CS-50TB. Aluminium

Ideal for installations where frequent use may be expected. Permits easier movement of maintenance personnel, tools and equipment.

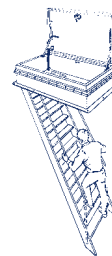

CS-50TB

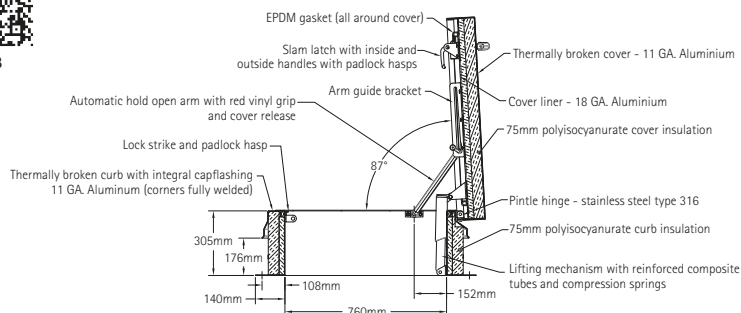

Type CS-50TB

SPECIFICATIONS

Furnish and install where indicated on plans, thermally broken metal roof hatch. Length denotes hinged side. The roof hatch shall be single leaf. The roof hatch shall be pre-assembled from the manufacturer.

Performance characteristics: Cover and curb shall be thermally broken to prevent heat transfer between interior and exterior surfaces.

Cover shall be reinforced to support a minimum live load of 195kg/m² with a maximum deflection of 1/150th of the span or 97kg/m² wind uplift.

Operation of the cover shall be smooth and easy with controlled operation throughout the entire arc of opening and closing.

Operation of the cover shall not be affected by temperature.

Entire hatch shall be weather tight with fully welded corner joints on cover and curb.

Cover: Shall be 2.3mm aluminium with a 127mm beaded flange with formed reinforcing members. Interior and exterior surfaces shall be thermally broken to minimize heat transfer and to resist condensation. Cover shall have a heavy extruded EPDM rubber gasket bonded to the cover interior to assure a continuous seal when compressed to the top surface of the curb.

Cover insulation: Shall be 75mm thick polyisocyanurate fully covered and protected by a 1mm aluminium liner.

Curb: Shall be 305mm in height and of 2.3mm aluminium. Interior and exterior surfaces shall be thermally broken to minimize heat transfer and to resist condensation. The curb shall be formed with a 140mm flange with 11mm holes provided for securing to the roof deck. The curb shall be equipped with an integral metal capflashing of the same gauge and material as the curb, fully welded at the corners, that features the Bil-Clip® flashing system, including stamped tabs, 153mm on center, to be bent inward to hold single ply roofing membrane securely in place.

Curb insulation: Shall be 75mm thick polyisocyanurate.

Lifting mechanisms: Manufacturer shall provide compression spring operators enclosed in telescopic tubes to provide, smooth, easy, and controlled cover operation throughout the entire arc of opening and closing. The upper tube shall be the outer tube to prevent accumulation of moisture, grit, and debris inside the lower tube assembly. The lower tube shall interlock with a flanged support shoe welded to the curb assembly.

Hardware: Heavy stainless steel pintle hinges shall be provided. Cover shall be equipped with a spring latch with interior and exterior turn handles. Roof hatch shall be equipped with interior and exterior padlock hasps. The latch strike shall be a stamped component bolted to the curb assembly.

Cover shall automatically lock in the open position with a rigid hold open arm equipped with a 25mm diameter red vinyl grip handle to permit easy release for closing. Compression spring tubes shall be an anti-corrosive composite material and all other hardware shall be zinc plated and chromate sealed (for installation in highly corrosive environments or when prolonged exposure to hot water or steam is anticipated, specify Type 316 stainless steel hardware).

Cover hardware shall be bolted into heavy gauge channel reinforcing welded to the underside of the cover and concealed within the insulation space.

Finish: Factory finish shall be mill finish aluminium

Options: See pages 62-64 and Ladders pages 46-55.

STANDARD SIZES and WEIGHTS

Type	Size - clear internal dimensions	Overall dimensions	Weight
CS-50TB	760mm x 1500mm (H)	1040mm x 1780mm	81kg
CS-50TB CL	760mm x 1500mm (H)	1040mm x 1780mm	89kg

50 - Aluminium (H) - Hinge Side CL - Curb Liner

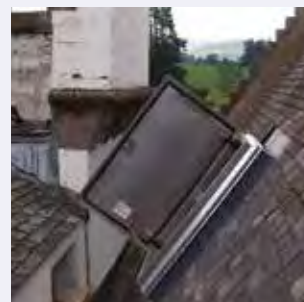

Service Stair Access

Type L-50TB and SSY-50TB. Aluminium

For where frequent use may be expected.
Permits easier movement of maintenance personnel,
tools and equipment from a full size stairway.

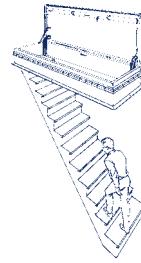

L-50TB



SSY-50TB

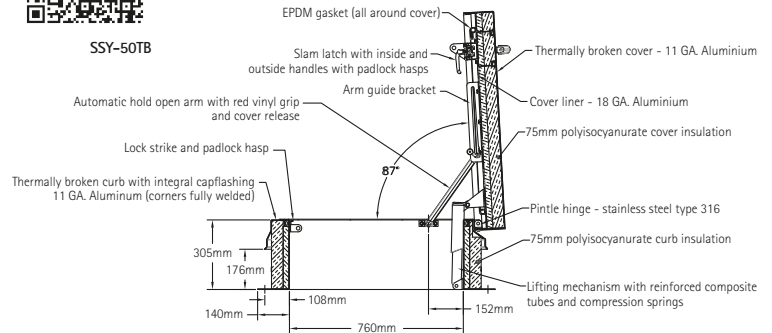

SPECIFICATIONS

Furnish and install where indicated on plans, thermally broken metal roof hatch. Length denotes hinged side. These roof hatches shall be single leaf. The roof hatch shall be pre-assembled from the manufacturer.

Performance characteristics:	<p>Cover and curb shall be thermally broken to prevent heat transfer between interior and exterior surfaces.</p> <p>Cover shall be reinforced to support a minimum live load of 195kg/m² with a maximum deflection of 1/150th of the span or 97kg/m² wind uplift.</p> <p>Operation of the cover shall be smooth and easy with controlled operation throughout the entire arc of opening and closing.</p> <p>Operation of the cover shall not be affected by temperature.</p> <p>Entire hatch shall be weather tight with fully welded corner joints on cover and curb.</p>
Cover:	<p>Shall be 2.3mm aluminium with a 127mm beaded flange with formed reinforcing members. Interior and exterior surfaces shall be thermally broken to minimize heat transfer and to resist condensation. Cover shall have a heavy extruded EPDM rubber gasket bonded to the cover interior to assure a continuous seal when compressed to the top surface of the curb.</p>
Cover insulation:	<p>Shall be 75mm thick polyisocyanurate with a fully covered and protected by a 1mm aluminium liner.</p>
Curb:	<p>Shall be 305mm in height and of 2.3mm aluminium. Interior and exterior surfaces shall be thermally broken to minimize heat transfer and to resist condensation. The curb shall be formed with a 140mm flange with 11mm holes provided for securing to the roof deck. The curb shall be equipped with an integral metal capflashing of the same gauge and material as the curb, fully welded at the corners, that features the Bil-Clip® flashing system, including stamped tabs, 153mm on center, to be bent inward to hold single ply roofing membrane securely in place.</p>
Curb insulation:	<p>Shall be 75mm thick polyisocyanurate.</p>

Lifting mechanisms: Manufacturer shall provide compression spring operators enclosed in telescopic tubes to provide, smooth, easy, and controlled cover operation throughout the entire arc of opening and closing. The upper tube shall be the outer tube to prevent accumulation of moisture, grit, and debris inside the lower tube assembly. The lower tube shall interlock with a flanged support shoe welded to the curb assembly.

Hardware: Heavy stainless steel pintle hinges shall be provided. Cover fitted with enclosed two point spring latch with interior and exterior turn handles. Roof hatch shall be equipped with interior and exterior padlock hasps. The latch strike shall be a stamped component bolted to the curb assembly. Cover shall automatically lock in the open position with a rigid hold open arm equipped with a 25mm diameter red vinyl grip handle to permit easy release for closing. Compression spring tubes shall be an anti-corrosive composite material and all other hardware shall be zinc plated and chromate sealed (for installation in highly corrosive environments or when prolonged exposure to hot water or steam is anticipated, specify Type 316 stainless steel hardware. Cover hardware shall be bolted into heavy gauge channel reinforcing welded to the underside of the cover and concealed within the insulation space.

Finish: Factory finish shall be mill finish aluminium.
Options: See pages 62-64.

STANDARD SIZES and WEIGHTS

Type	Size - clear internal dimensions	Overall dimensions	Weight
L-50TB	760mm x 2440mm (H)	1040mm x 2720mm	138kg
L-50TB CL	760mm x 2440mm (H)	1040mm x 2720mm	151kg
SSY-50TB	760mm x 3360mm (H)	1040mm x 3640mm	176kg
SSY-50TB CL	760mm x 3360mm (H)	1040mm x 3640mm	192kg

50 - Aluminium (H) - Hinge Side CL - Curb Liner





Plant Access

Type F-50TB, Type SS-50TB and Type D-50T

There are a wide range of options for plant access making it easy to install or remove equipment from a building.



F-50TB



D-50T

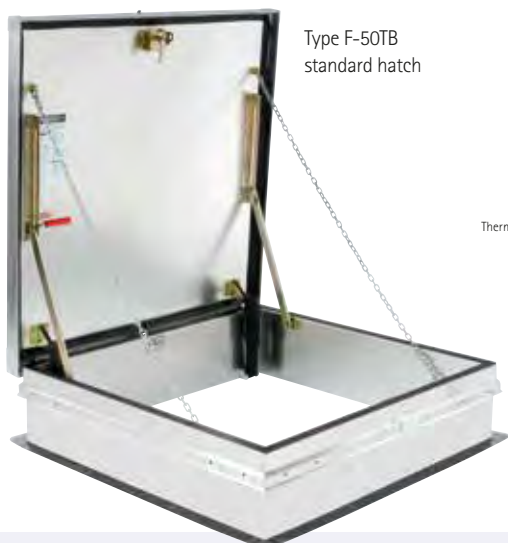

Type F-50TB standard hatch

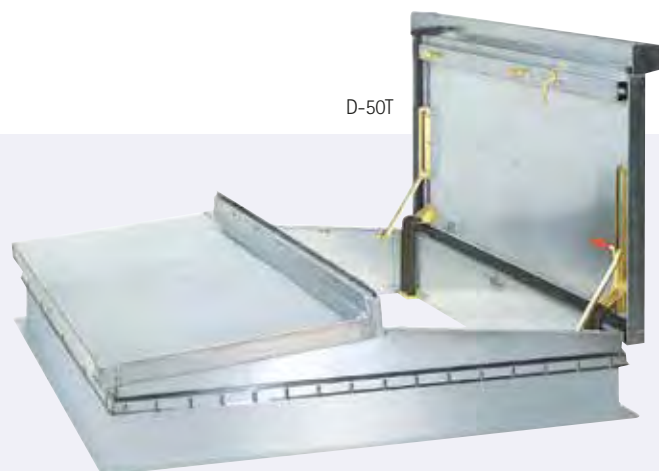
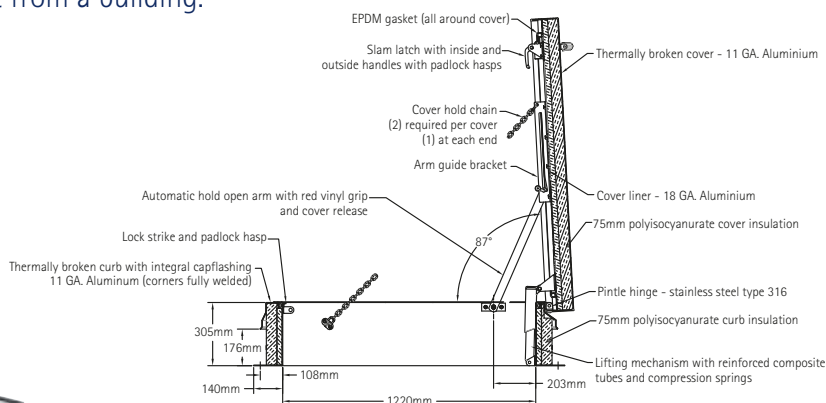

D-50T

SPECIFICATIONS

Furnish and install where indicated on plans, thermally broken metal roof hatch. These roof hatches shall be single leaf and shall be pre-assembled from the manufacturer.

Performance characteristics: Cover and curb shall be thermally broken to prevent heat transfer between interior and exterior surfaces.

Cover shall be reinforced to support a minimum live load of 195kg/m² with a maximum deflection of 1/150th of the span or 97kg/m² wind uplift.

Operation of the cover shall be smooth and easy with controlled operation throughout the entire arc of opening and closing.

Operation of the cover shall not be affected by temperature.

Entire hatch shall be weather tight with fully welded corner joints on cover and curb

Cover: Shall be 2.3mm aluminium with a 127mm beaded flange with formed reinforcing members. Interior and exterior surfaces shall be thermally broken to minimize heat transfer and to resist condensation. Cover shall have a heavy extruded EPDM rubber gasket bonded to the cover interior to assure a continuous seal when compressed to the top surface of the curb.

Cover insulation: Shall be 75mm (D-50T is 50mm) thick polyisocyanurate fully covered and protected by a 1mm aluminium liner.

Curb: Shall be 305mm in height and of 2.3mm aluminium. Interior and exterior surfaces shall be thermally broken to minimize heat transfer and to resist condensation. The curb shall be formed with a 140mm flange with 11mm holes provided for securing to the roof deck. The curb shall be equipped with an integral metal capflashing of the same gauge and material as the curb, fully welded at the corners, that features the Bil-Clip® flashing system, including stamped tabs, 153mm on center, to be bent inward to hold single ply roofing membrane securely in place.

Curb insulation: Shall be 75mm (D-50T is 50mm) thick polyisocyanurate.

Lifting mechanisms: Manufacturer shall provide compression spring operators enclosed in telescopic tubes to provide, smooth, easy, and controlled cover operation throughout the entire arc of opening and closing. The upper tube shall be the outer tube to prevent accumulation of moisture, grit, and debris inside the lower tube assembly. The lower tube shall interlock with a flanged support shoe welded to the curb assembly.

If used with fixed vertical ladder, it is recommended to have motorised option. Call office for details.

Hardware:

Heavy stainless steel pintle hinges shall be provided.

Cover shall be equipped with a spring latch with interior and exterior turn handles.

Roof hatch shall be equipped with interior and exterior padlock hasps.

The latch strike shall be a stamped component bolted to the curb assembly.

Cover shall automatically lock in the open position with a rigid hold open arm equipped with a 25mm diameter red vinyl grip handle to permit easy release for closing.

Compression spring shall be an anti-corrosive composite material and all other hardware shall be zinc plated and chromate sealed (for installation in highly corrosive environments or when prolonged exposure to hot water or steam is anticipated, specify Type 316 stainless steel hardware).

Cover hardware shall be bolted into heavy gauge channel reinforcing welded to the underside of the cover and concealed within the insulation space.

Finish: Factory finish shall be mill finish aluminium.

Options: See pages 62-64 and Ladders pages 46-55.

STANDARD SIZES and WEIGHTS

Type	Size - clear internal dimensions	Overall dimensions	Weight
F-50TB	1220mm x 1220mm	1500mm x 1500mm	126kg
F-50TB CL	1220mm x 1220mm	1500mm x 1500mm	136kg
SS-50TB	Special sizes on request		
D-50T	Special sizes on request		

50 - Aluminium CL - Curb Liner Special sizes available on request.

Powered Access Sliding Roof Hatch/Skylight

Type SKY-ACCESS

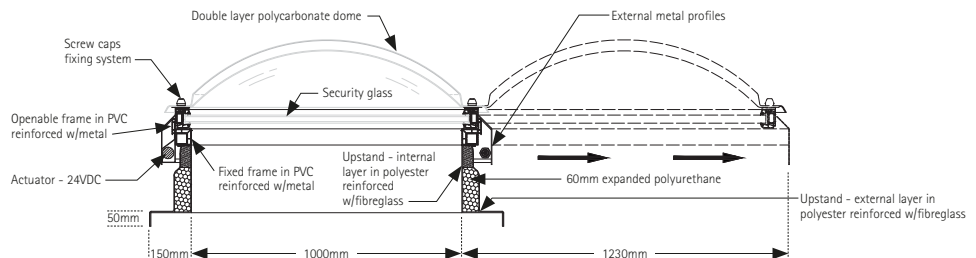

SPECIFICATIONS

Powered single leaf access, pre-assembled from the manufacturer.

- Performance characteristics:** Dome has been tested for impact resistance to EN1873 Class SB1200. Operation of the cover shall not be affected by temperature. Entire hatch shall be weathertight. U-value 1.02 W/m²K.
- Cover:** Shall be a double-layer thermoformed polycarbonate dome assembled on a fully welded PVC frame, in which a double-layer security glass (classified 2(B)2 according to EN 12600:2004) shall be inserted. Cover shall have extruded EPDM rubber gasket to ensure a continuous seal when compressed in the front and in the back of the vent.
- Curb:** Shall be 250mm in height and of double-layer (internal and external) polyester resin reinforced with fibreglass. The curb shall be formed with a 150mm flange with 9mm holes provided for securing to the roof deck.
- Curb insulation:** Shall be extruded polyurethane of 60mm thickness.

Operating mechanism: A single rotating actuator mounted on a sliding carriage capable of opening the cover to open position of 180 degrees (note: roof obstructions should be considered).

- Finishes:** Factory finish shall be:
 Polycarbonate: Clear Finish
 Glass: Clear Finish
 PVC Profiles: White
 Metal Profiles: White Powder Coating
 Upstand: White
- Options:** See Ladders pages 46-55.

STANDARD SIZES and WEIGHTS

Type	Size – clear internal dimensions	Overall dimensions	Weight
SKY-ACCESS	1000mm x 1500mm	1300mm x 1800mm	170kg

Special sizes available on request.

Refurbishment

Type VersaMount®

The VersaMount® is ideal for refurbishment projects where a weatherproof upstand is existing. Easy to fit the anchor clip system and versatile frame design helps complete the job efficiently.



S-50VMTB

Type S-50VMTB

SPECIFICATIONS: These roof hatches are single leaf.

VERSAMOUNT®

- Curb:** Shall be 140mm in height and of 2.3mm aluminium. The curb shall be formed with a 117mm flange and a 38mm apron, fully welded at corners. Stainless Steel anchor clips are included. Bilco recommend maximum upstand width is 110mm.
- Curb insulation:** Shall be polyisocyanurate of 75mm thickness.

VERSAMOUNT® STANDARD SIZES and WEIGHTS

Type	Size – clear internal dimensions	Overall dimensions	Weight	Open angle
S-50VMTB	915mm x 760mm (H)	1195mm x 1040mm	50kg	87°

50 - Aluminium (H) - Hinge Side

Special size not available.



Smoke Vents



Natural Smoke and Heat Exhaust Ventilators (NSHEV)

Bilco smoke ventilators are fully compliant to the Construction Products Directive 89/106/EEC and EU Regulation No 305/2011. The evaluation is based upon the requirements of EN12101-2 2003-09.

Under the requirements of the Regulation it is mandatory that CE marking is provided with the product and that a Declaration of Conformity is provided by the manufacturer.

EN12101-2 sets out the performance and test methods for natural smoke and heat exhaust ventilators which are intended to be installed as a component of a natural smoke and heat exhaust system. Bilco smoke vents can also be used as dual function vents to provide comfort ventilation to manage the internal temperature within a building. Bilco can also provide control equipment for smoke control systems, comfort ventilation and access.

Both single and double leaf vents manufactured by Bilco offer excellent thermal and air leakage performance and can be manufactured to suit project specific requirements for size, curb options and paint finishes.

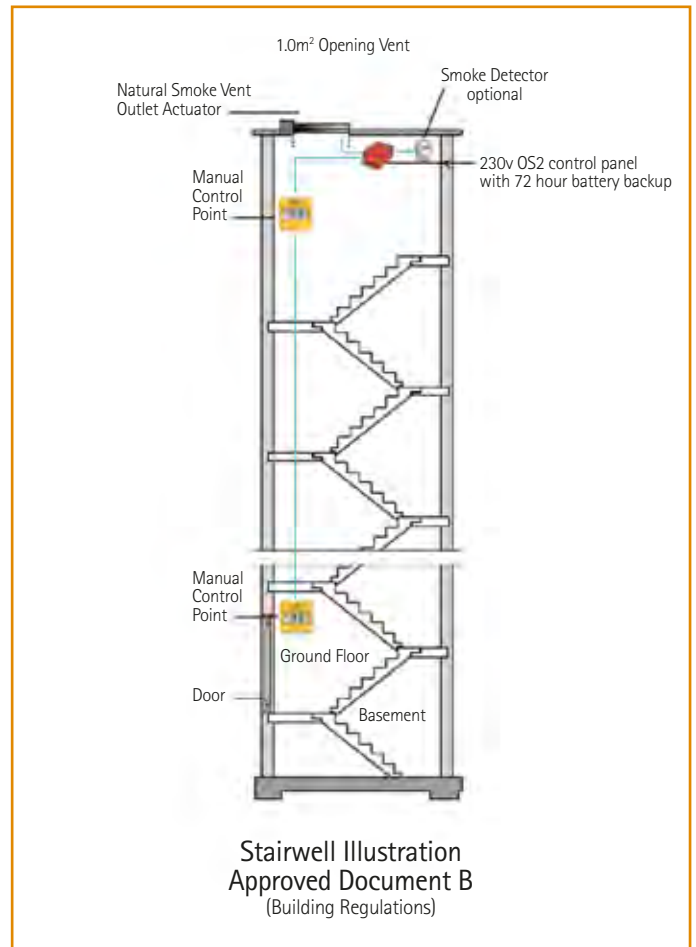

Key Features and Benefits

- Increased evacuation time and decreased risk of smoke inhalation and damage
- Enhanced visibility to allow firefighters to quickly locate the fire
- Protection against secondary ignitions and lateral fire spread
- Exhausting of noxious and potentially explosive fumes
- Structure protection from damaging heat
- Reduce damage to building contents
- Can be used for access and comfort ventilation.

Typical Applications

- High-Rise Housing
- Offices and Commercial Buildings
- Aircraft Hangars
- Auditoria
- Concert Halls and Theatres
- Convention Centres
- Gymnasiums
- Manufacturing Plants
- Retail Centres
- Schools
- Hospitals
- Distribution Depots
- Warehouses
- Care Homes



Newly designed closed cell EPDM sponge gasket, helps meet Building Regulations air leakage targets by providing a better seal of the cover to the curb, ensuring complete weather-tightness



A single linear actuator mounted on a pivoting carriage capable of opening the cover to the fire open position of 140 degrees within 60 seconds



Enclosed hinge assembly



Fully insulated cover and curb. 50mm thick faced rigid polyisocyanurate thermal insulation board.

Standard product - clear vent areas of 1m² and 1.5m²



Flange with pre-drilled fixing points for easy installation



Wind deflector to protect open vent against wind loads



Curb mounted junction box with terminal block enclosed for power cable connection



Insulated curb with cap flashing and Bilclip® flashing system. Installation is simply a matter of placing the vent over the roof opening and securing it to the roof deck through the holes provided in the base flange. The integral capflashing readily accepts roofing felts reducing installation time and costs.

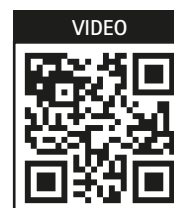

VIDEO



Type ESW-50REM

Typically positioned at the head of a stairwell. The vent will act as a chimney clearing the building of heat and smoke.

Bilclip® Flashing System

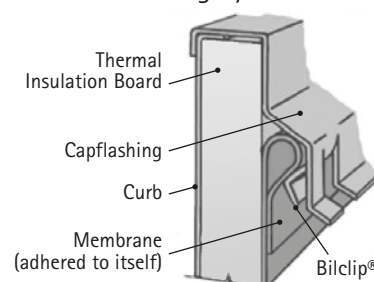



Stairwell (NSHEV)

Type ESW-50REM Smoke Vent - Single Leaf 140°



ESW-50REM

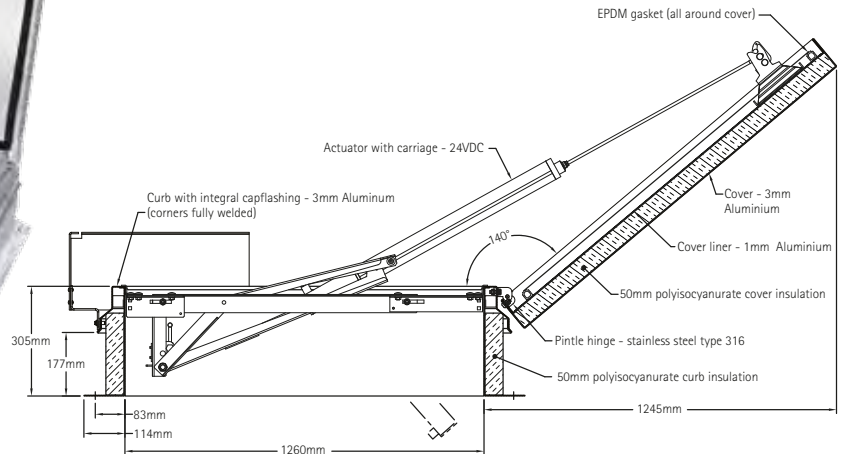

SPECIFICATIONS

The smoke vent shall be single leaf and provide 1.0m² clear vent area. The smoke vent shall be pre-assembled from the manufacturer.

Performance characteristics: Cover shall be reinforced to support a minimum live load of 195 kg/m² with a maximum deflection of 1/150th of the span. Operation of the cover shall be through a 24VDC battery backed control system that will open the cover to the fire open position within 60 seconds and be capable of closing the cover. Operation of the cover shall not be affected by temperature. Entire vent shall be weathertight with fully welded corner joints on cover and curb.

Cover: Shall be 3mm aluminium with a 100mm beaded flange with formed reinforcing members. Cover shall have a heavy extruded EPDM rubber gasket that is bonded to the cover interior to ensure a continuous seal when compressed to the top surface of the curb.

Cover insulation: Shall be polyisocyanurate of 50mm thickness. Insulation shall be fully covered and protected by an aluminium liner.

Curb: Shall be 305mm in height and of 3mm aluminium. The curb shall be formed with a 114mm flange with 11mm holes provided for securing to the roof deck. The curb shall be equipped with an integral metal capflashing of 2mm aluminium, fully welded at the corners, that features the Bil-Clip® flashing system, including stamped tabs, 153mm on centre, to be bent inward to hold single ply roofing membrane securely in place.

Wind deflectors: Wind deflectors shall be 4mm aluminium with 3mm EPDM gasket.

Curb insulation: Shall be polyisocyanurate of 50mm thickness.

Operating mechanism: A single linear actuator mounted on a pivoting carriage capable of opening the cover to the fire open position of 140° (note – roof obstructions should be considered).

Hardware: Heavy pintle hinges shall be provided. Curb mounted junction box with a terminal block enclosed for power cable connection.

Finish: Factory finish shall be mill finish aluminium.

Controls: See pages 18 and 19.

Options: See pages 62-64.

PERFORMANCE CHARACTERISTICS to EN12101-2

Free Aerodynamic area	1.0m ²
Reliability	RE 1000 (10,000*)
Snow Load	SL 400
Low Ambient Temp	T (-15)
Wind Load	WL 1500
Resistance to Heat	B 300

*10,000 when used as a day to day ventilator.

STANDARD SIZES and WEIGHTS

Type	Size – clear internal dimensions	Overall dimensions	Weight	Clear Vent Area
ESW-50REM	1260mm x 1260mm	1488mm x 1488mm	140kg	1.0m ²
ESW-50REM CL	1260mm x 1260mm	1488mm x 1488mm	150kg	1.0m ²

Special sizes available on request.

Sliding Single Leaf Vent/Skylight (NSHEV)

Type SKY-1M and Type SKY-SS

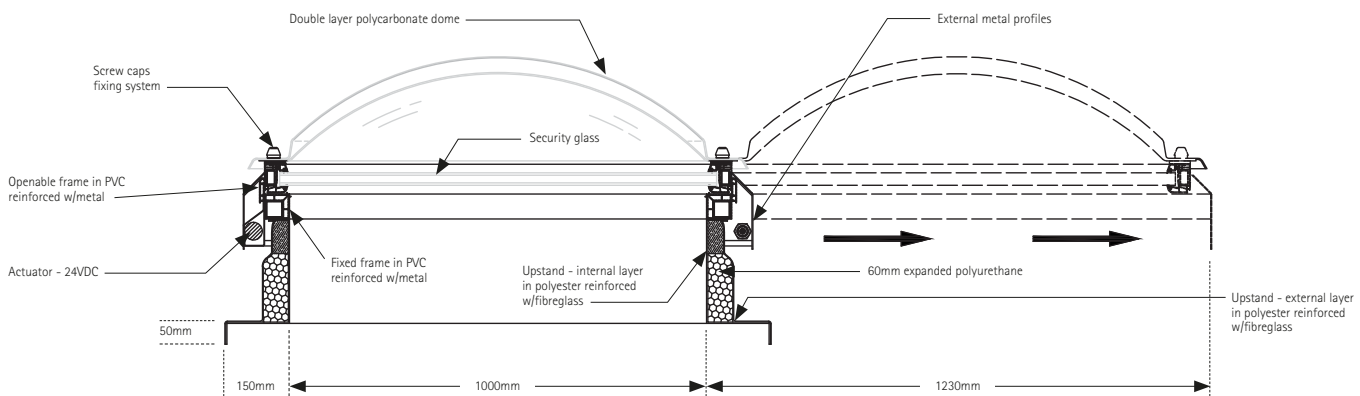

SPECIFICATIONS

The smoke vent shall be single leaf, provide 1m² clear vent area and be pre-assembled from the manufacturer.

Performance characteristics: Dome has been tested for impact resistance to EN1873 Class SB1200.
Operation of the cover shall be through a 24VDC battery backed control system that will open the cover to the fire open position within 60 seconds and be capable of closing the cover.
Operation of the cover shall not be affected by temperature.
Entire vent shall be weathertight.
U-value 1.02 W/m²K.

Cover: Shall be a double-layer thermoformed polycarbonate dome assembled on a fully welded PVC frame, in which a double-layer security glass (classified 2(B)2 according to EN 12600:2004) shall be inserted. Cover shall have extruded EPDM rubber gasket to ensure a continuous seal when compressed in the front and in the back of the vent.

Cover insulation: Not applicable.

Curb: Shall be 250mm in height and of double-layer (internal and external) polyester resin reinforced with fibreglass. The curb shall be formed with a 150mm flange with 9mm holes provided for securing to the roof deck.

Curb insulation: Shall be extruded polyurethane of 60mm thickness.

Operating mechanism: A single rotating actuator mounted on a sliding carriage capable of opening the cover to the fire open position of 180 degrees (note: roof obstructions should be considered).

Finishes: Factory finish shall be:
Polycarbonate: Clear Finish
Glass: Clear Finish
PVC Profiles: White
Metal Profiles: White Powder Coating
Upstand: White

Options: See Ladders pages 48-51.

STANDARD SIZES and WEIGHTS

Type	Size - clear internal dimensions	Overall dimensions	Weight
SKY-1M	1000mm x 1500mm	1300mm x 1800mm	170kg
SKY-SS	Special sizes on request		



Double Leaf (NSHEV)

UDF-50REM Smoke Vent - Double Leaf 90°



Type UDF-50REM - shown without wind deflector



UDF-50REM

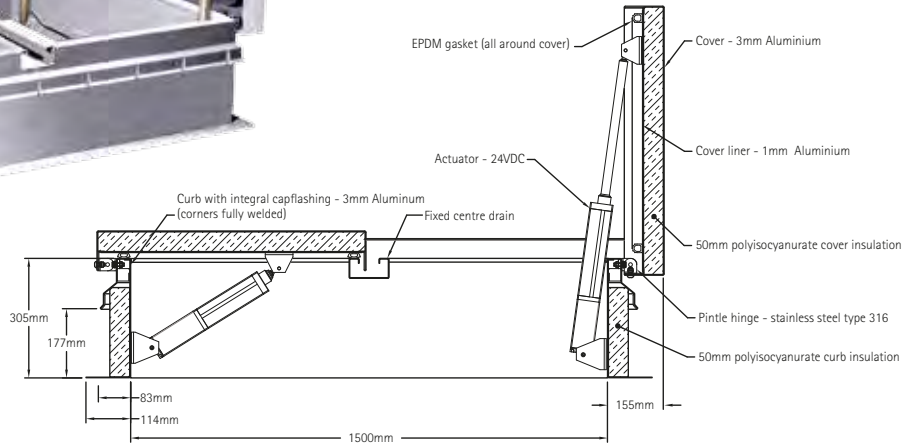

SPECIFICATIONS

The smoke vent shall be double leaf and provide 1.5m² clear vent area. The smoke vent shall be pre-assembled from the manufacturer.

Performance characteristics: Covers shall be reinforced to support a minimum live load of 195 kg/m² with a maximum deflection of 1/150th of the span. Operation of the covers shall be through a 24VDC battery backed control system that will open the covers to the fire open position within 60 seconds and be capable of closing the covers. Operation of the covers shall not be affected by temperature. Entire vent shall be weathertight with fully welded corner joints on covers and curb.

Cover: Shall be 3mm aluminium with a 100mm beaded flange with formed reinforcing members. Cover shall have a heavy extruded EPDM rubber gasket that is bonded to the cover interior to ensure a continuous seal when compressed to the top surface of the curb.

Cover insulation: Shall be polyisocyanurate of 50mm thickness. Insulation shall be fully covered and protected by an aluminium liner.

Curb: Shall be 305mm in height and of 3mm aluminium. The curb shall be formed with a 114mm flange with 11mm holes provided for securing to the roof deck. The curb shall be equipped with an integral metal capflashing of 2mm aluminium, fully welded at the corners, that features the Bil-Clip® flashing system, including stamped tabs, 153mm on centre, to be bent inward to hold single ply roofing membrane securely in place. There shall be a fixed central drip channel through the centre section of the curb.

Wind deflectors: Wind deflectors shall be 4mm aluminium with 3mm EPDM gasket.

Curb insulation: Shall be polyisocyanurate of 50mm thickness.

Operating mechanism: Two 24VDC linear actuators per cover (four actuators total) capable of opening the cover to the fire open position of 90°.

Hardware: Heavy pintle hinges shall be provided. Curb mounted junction box (2 no.) with terminal blocks enclosed for power cable connection.

Finish: Factory finish shall be mill finish aluminium.

PERFORMANCE CHARACTERISTICS to EN12101-2

Free Aerodynamic area	1.5m ²
Reliability	RE 1000 (10,000*)
Snow Load	SL 500
Low Ambient Temp	T (-15)
Wind Load	WL 1500
Resistance to Heat	B 300

*10,000 when used as a day to day ventilator.

STANDARD SIZES and WEIGHTS

Type	Size - clear internal dimensions	Overall dimensions	Weight	Clear Vent Area
UDF-50REM	1500mm x 1620mm	1728mm x 1848mm	215kg	1.5m ²
UDF-50REM CL	1500mm x 1620mm	1728mm x 1848mm	230kg	1.5m ²

Special sizes available on request.

Smoke Vents – Acoustic

Type ACDSH – Double Leaf 90°

Mechanically operated smoke vents. Ideal for concert halls, theatres, casinos, sporting arenas and other applications.

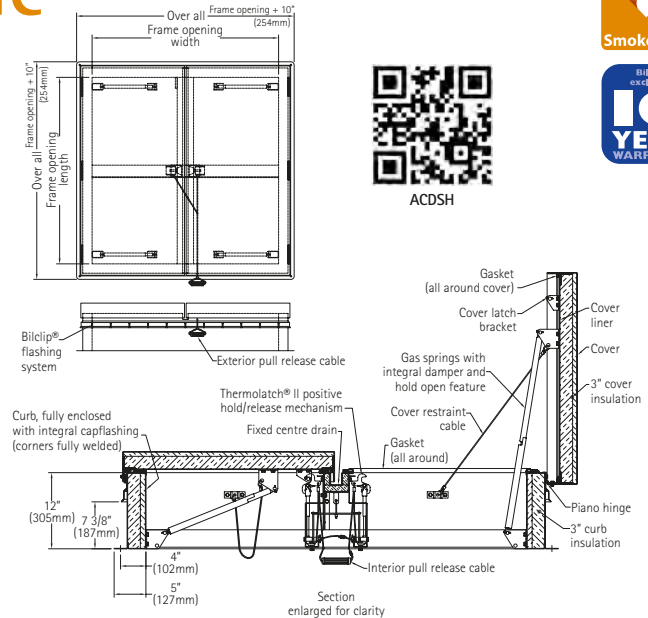
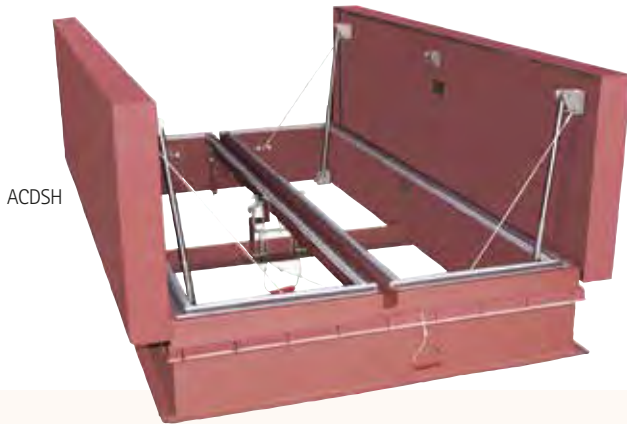

SPECIFICATIONS

Furnish and install where indicated on plans metal fire vent Type ACDSH, size [insert: width () x length ()]. Length denotes hinge side. The roof fire vent shall be double leaf. The roof fire vent shall be pre-assembled from the manufacturer.

Performance:	Vent(s) shall be UL listed.
Characteristics:	Covers shall be reinforced to support a minimum live load of 40 psf (195 kg/m ²) with a maximum deflection of 1/150th of the span or 90 psf (439 kg/m ²) wind uplift. Corrosion resistant gas springs shall open the vent covers simultaneously when latch is manually released or when heat breaks the UL listed fusible link. Opening shall be in a controlled manner to avoid damage to surrounding roof surfaces. Entire roof fire vent shall be weathertight with fully welded corner joints on cover and curb. Latch mechanisms shall hold the covers in the closed position without overstressing the fusible link and withstand 90 psf (439 kg/m ²) wind uplift forces acting on the cover.
Latch Operation:	When heat parts the UL listed fusible link, the latch shall release instantaneously, allowing vent covers to open. The latch shall be designed for easy resetting, after a fire or test, so that the covers cannot be latched closed unless the mechanism has been reset properly. Manufacturer shall provide instructions for resetting the latch with each unit.
Transmission Sound Rating:	Vent(s) shall carry STC-46 sound rating.
Covers:	14 gauge (2mm) paint bond G-90 galvanized steel with a 5" (127mm) beaded flange with formed reinforcing members.
Gasket:	PVC gaskets shall be permanently adhered to the underside of the covers and on top of the curb.

Cover insulation:	Fiberglass of 3" (76mm) in thickness, fully covered and protected by a 14 gauge (2mm) paint bond G-90 galvanized steel liner.
Curb:	12" (305mm) in height and of 14 gauge (2mm) paint bond G-90 galvanized with a fixed centre channel. Curb shall be formed with a 5" (127mm) flange with 7/16" (11mm) holes provided for securing to roof deck. Curb shall be equipped with integral metal capflashing of the same gauge and material as the curb and feature the Bil-Clip® flashing system, including stamped tabs, 6" (153mm) on centre, to be bent inward to hold single-ply roofing membrane securely in place.
Curb insulation:	3" (76mm) fiberglass insulation, fully enclosed by a 14 gauge (2mm) paint bond G-90 galvanized steel liner.
Lifting Mechanisms:	Corrosion resistant gas springs open covers automatically against a 10 lb/ft ² (49Kg/m ²) snow/wind load. Gas springs shall have built in dampers to assure a controlled rate of opening and automatically lock the covers in the full open position. A release mechanism shall be provided to allow the covers to be closed.
Latch Mechanism:	Shall be the BILCO Thermolatch® II positive hold/release mechanism with a separate latching point for each cover controlled by a single UL listed 165°F (74°C) fusible link. Fusible link shall be curb mounted on a non-hinged end to allow the latching mechanism to be easily reset from the roof level.
Hardware:	Corrosion resistant gas springs and hot dip galvanized steel stop cables. All other hardware is zinc plated/chromate sealed.
Finish:	Factory finish shall be alkyd base red oxide primer.
Options:	Motorised Operation.

STANDARD SIZES and WEIGHTS

Type	Size – clear internal dimensions	Overall dimensions	Weight
ACDSH4848	1220mm x 1220mm	1398mm x 1398mm	295kg
ACDSH4872	1220mm x 1830mm (H)	1398mm x 2008mm	383kg
ACDSH4890	1220mm x 2290mm (H)	1398mm x 2468mm	447kg
ACDSH4896	1220mm x 2440mm (H)	1398mm x 2618mm	474kg
ACDSH6060	1520mm x 1520mm	1698mm x 1698mm	395kg
ACDSH6096	1520mm x 2440mm (H)	1698mm x 2618mm	508kg
ACDSH66144*	1680mm x 3660mm (H)	1858mm x 3838mm	749kg
ACDSH7272	1830mm x 1830mm	2008mm x 2008mm	476kg

(H) - Hinge Side

*This size has four covers.





Control Options

The heart of the system

Bilco controls and accessories are designed to work effectively with the range of natural smoke ventilators and roof hatches.

The OS2 control unit can be a stand-alone management system - in its own right, or it can be integrated into a fully networked fire alarm or BMS system. In the event of a fire, if the mains electrical supply to the building is cut the OS2 offers a failsafe option as it incorporates a backup battery system to ensure the natural smoke vents will still open. Special control units for unique applications can also be manufactured.

Other control accessories are available to independently open and close access equipment in non-emergency situations for example for roof inspection and maintenance, as well as making it easier to utilize the roof space for plant and recreational use.

There are a number of security accessories available and options for comfort ventilation. With the growing demand for buildings to be sustainable, energy efficient and environmentally friendly, a building that can ventilate solar heat gains in the summer and retain heat in the winter is vitally important.

Controls such as thermostats and rain sensors can for example, moderate a building 'over-heating' during the day, as well as providing additional revenue saving benefits in terms of reducing the use of energy hungry H&V equipment.



Dumb Reset Key
1RPREM-23



MCP

Designed to allow the Fire Officer to manually override the smoke control system through a user friendly interface. Design includes an open button and a close/reset button, which are accessed by lifting the clear front door. Dumb Reset Key required to close in accordance with PrEN 12101-9.



1RPREM-02



Typical
smoke vent



JUNCTION BOX
Fitted as standard to all smoke vents ready for wiring. Meets IP55

CONTROL PANEL

The OS2 control unit can be a stand-alone management system or it can be integrated into a fully networked fire alarm or BMS system.

OS2 accepts a supply of 230V AC 50/60 Hz from a 3A fused un-switched spur and has a current rating of 2A. Output is 24V DC 2-Channels. Combined output must not exceed 8A. Intermittent - 6 mins in any 1 hour; 5A continuous. Other options are available.

The 72 hour backup battery module comprises 2 x 12vDC 7.0AH sealed lead-acid batteries.

1RPREM-09



CONTROL PANEL KIT
Comprises- control panel, fireman's switch (MCP) and smoke detector.

1RPREM-01



MCP
Tamper-proof MCP
1RPREM-21



SMOKE DETECTOR
1RPREM-03



OPEN/CLOSE SMOKE VENT SWITCH
Stainless steel face plate, designed to be used as a keyed or paddle switch

1RPREM-08 (keyed)
1RPREM-08A (paddle)



OPEN/CLOSE SWITCH
10 amp durable white plastic retractable switch

1RPREM-10



WEATHERPROOF OPEN/CLOSE SWITCH
Made from steel the keyed switch is sprung to centre and cannot be operated with out the security key

1RPREM-11 (keyed)
1RPREM-11A (paddle)



PANIC BUTTON
For use above or below smoke vent for emergency escape

1RPREM-11B



AUTO/MANUAL CONTROL SWITCH
To be used in conjunction with thermostat and/or rain sensor. Stainless steel face plate, designed to be used as a 2 position switch

1RPREM-07



THERMOSTAT
Industry standard 10° to 30°C range

1RPREM-04



WIND SPEED SENSOR
1RPREM-26



RAIN SENSOR
Robust and cost effective

1RPREM-15



BMS
External Connections (eg. alarm and ventilation systems)

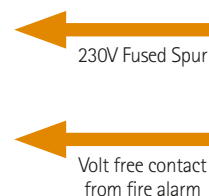
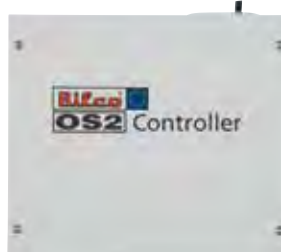
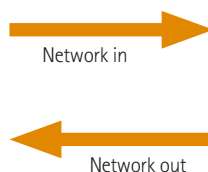



Floor Access

Floor Doors

EXTERIOR • INTERIOR • FIRE RATED

Bilco pit and floor doors are available in a wide range of sizes and configurations to meet virtually any floor access situation – exterior and interior in aluminium or steel.

DRAINAGE DOORS

Constructed for use in exterior applications or in those situations where there is concern of water or other liquids entering the access opening.

These doors are supplied with a threaded drain coupling fully welded to the channel frame for connection to a dry or wet well in the field.



NON-DRAINAGE DOORS

Generally for interior use or exterior applications where water or liquid infiltration is not a concern. Some models are designed to accept a wide variety of flooring materials, allowing them to blend into virtually any building environment.



FIRE DOORS

One and two hour fire rated doors with a choice of diamond pattern cover or 25mm pan for matching floor finishes.

Floor Door Key Features & Benefits

Engineered lift assistance for smooth, easy door operation, regardless of cover size and weight

Automatic hold-open arm that locks the cover in the open position to ensure safe egress

Even the largest door weighing anything up to 500kg can be easily opened by one person thanks to Bilco's unique counterbalance spring system

Type 316 stainless steel slam lock to prevent unauthorized access

Constructed with corrosion resistant materials and hardware.

Floor Door Typical Applications

Airports	Schools
Distribution Depots	Sewage Treatment Works
Factories	Telecommunications Vaults
Hospitals	Utilities
Manufacturing Facilities	Warehouses
Office Buildings	Water/Waste Treatment Works
Ports	Train Stations
Prisons	
Retail Centres	

Access Covers

Bilco floor access covers are designed to provide convenient, direct access to underground areas. The covers are designed to accept a wide variety of floor materials allowing them to go virtually unnoticed in the surrounding floor.

Covers are designed to be easily removed or operated and are available with reinforcing to satisfy nearly any loading requirement. Common applications include airports, underground railways, warehouses, hospitals, retail outlets, and general commercial interior building applications.



* The European standard EN 124 does not give a direct indication of the actual load in kN or tonnes. The load ratings are to be used as a guideline for product selection and are based on covers tested with full grade C34/45 concrete fill. Covers should never be subjected to the indicated test load in normal usage.

Access Covers Key Features & Benefits

Pans available in four depths: 27mm, 50mm, 66mm, and 102mm to accept brick, concrete, tile, paviers, carpeting and more

Models are available with reinforcing for pedestrian, 125 kN, 250 kN, and 400 kN loading conditions per EN 124 regulations*

Covers are precision manufactured and feature a full EPDM seal that is capable of withstanding up to a 1000mm head of water

Tapered cover design facilitates easy opening and secure closing and allows the covers to be virtually undetectable when installed

Lift off models feature the Golden Key Lift-Off system. System breaks the cover seal allowing it to be easily removed from the frame

Models are available in 2mm, cold-formed, hot-dip galvanized steel, grade 304 stainless steel, or aluminium construction

Manufactured to meet EN 22768-1 tolerance standard for length and corner dimensions

Products are supplied with installation instructions to ensure a trouble-free installation

BS-certified fire resistant and insulated access covers are available

Available in a hinged design that includes lift assistance for applications that require regular opening with minimal effort.



Golden Key lift-off system

Type J-AL door shown



Type 316 Stainless steel slam lock

Cover does not protrude into the channel frame



Top-side - Removable square key handle



Structurally reinforced cover. Withstands a live load of 1464kg/m² or more



Automatically locks in the vertical/open position

Unique counter opposing spring system means that all Bilco doors meet Manual Handling Regulations

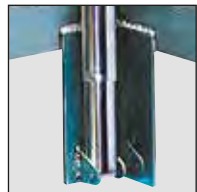

Lift-assisted counter-balanced cover. Lifting mechanism comprises reinforced Type 316 stainless steel springs and tubes

6mm aluminium diamond plate cover

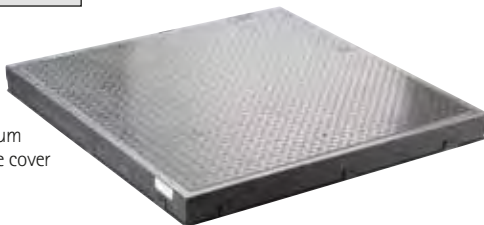

Top-side - Water drainage channel with drainage outlet



Underside - 38mm threaded drain coupling for pipe connection

Special finishes available

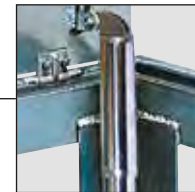

Heavy-duty hinges and opening system protected from the elements

Continuous EPDM debris gasket



All hardware corrosion resistant



Versatile Anchor Tabs for added support





Drainage Doors



Type J-AL and JD-AL. Aluminium – Single or Double Leaf

Ideal for most corrosive environments. Single or double leaf covers are constructed of 6mm diamond pattern plate and reinforced for a 1464kg/m² live load. Features anti-corrosion hardware, standard debris gasket, and a versatile anchoring system for ease of installation.



J-AL and JD-AL

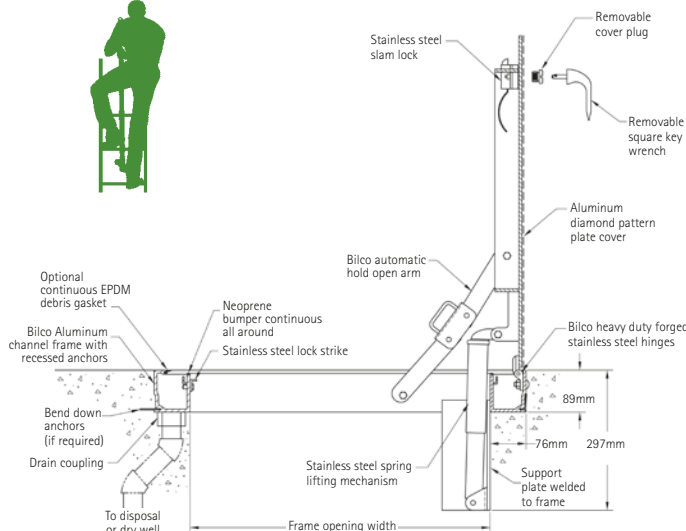

SPECIFICATIONS

Material:	6.3mm cover and extruded aluminium frame.
Cover:	Diamond-pattern tread plate reinforced for 1464kg/m ² live load.
Frame:	Extruded aluminium channel frame with bent down anchor tabs around the perimeter. A 38mm drain coupling is welded under the frame for a pipe connection to a dry well or disposal system.
Gasket:	EPDM gasket mechanically attached to the frame reduces the amount of dirt and debris that may enter the channel frame.
Hinges:	Type 316 stainless steel hinges.
Latch:	Type 316 stainless steel slam lock with fixed interior handle and removable exterior turn/lift handle. Latch release is protected by a flush, gasketed, removable screw plug.
Lift Assistance:	Compression spring operators enclosed in telescopic tubes. Automatic hold-open.
Finish:	Mill finish aluminium with a bituminous coating applied to the exterior of the frame.
Hardware:	All hardware stainless steel.
Options:	See page 65.

Features on all J/JD aluminium doors include



Debris Gasket



Adjustable Anchor Tabs

STANDARD SIZES and WEIGHTS

Type	Size – clear internal dimensions	Overall dimensions	Weight
J-1AL	610mm x 610mm	762mm x 762mm	30kg
J-2AL	760mm x 760mm	912mm x 912mm	40kg
J-3AL	915mm x 760mm (H)	1067mm x 912mm	44kg
J-4AL	915mm x 915mm	1067mm x 1067mm	49kg
J-5AL	1065mm x 1065mm	1217mm x 1217mm	61kg
JD-1AL	1220mm x 760mm (H)	1372mm x 912mm	66kg
JD-2AL	1220mm x 1220mm	1372mm x 1372mm	79kg
JD-3AL	1220mm x 1830mm (H)	1372mm x 1982mm	106kg
JD-4AL	1525mm x 1525mm	1677mm x 1677mm	109kg

(H) - Hinge Side

Models with "D" in the Model Type indicate double leaf configuration.



Drainage Doors



Type J-AL H20 and JD-AL H20. Aluminium – Single or Double Leaf

Designed to withstand vehicular traffic in off-street locations. Single or double leaf covers are constructed of 6mm diamond pattern plate and reinforced for AASHTO H-20 wheel loading (14,500kg. axle load). With all the same features as the Type J-AL, this door is also ideal for most corrosive environments.

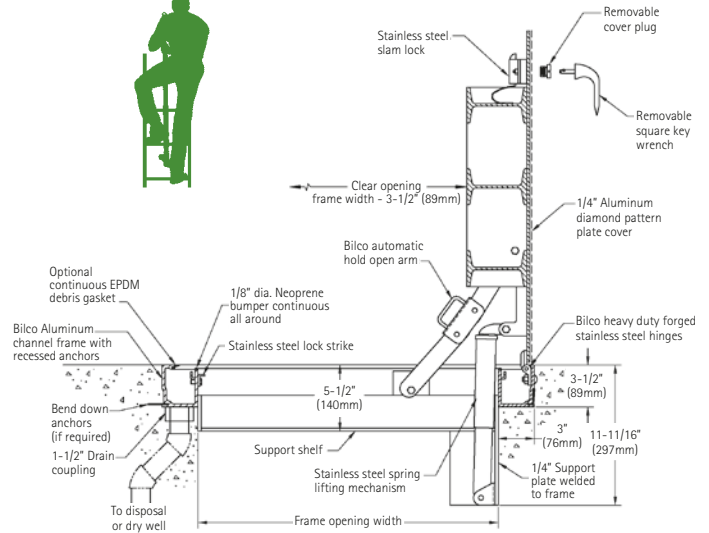

SPECIFICATIONS

Material:	6.3mm cover and extruded aluminium frame.
Cover:	Diamond-pattern tread plate reinforced for H-20 wheel loading. Designed for installation in off-street locations where the door is not subjected to high density, fast moving traffic. Structural calculations available upon request.
Frame:	Extruded aluminium channel frame with bent down anchor tabs around the perimeter. A 38mm drain coupling is welded under the frame for a pipe connection to a dry well or disposal system.
Gasket:	EPDM gasket mechanically attached to the frame reduces the amount of dirt and debris that may enter the channel frame.
Hinges:	Type 316 stainless steel hinge pins.
Latch:	Type 316 stainless steel slam lock with fixed interior handle and removable exterior turn/lift handle. Latch release is protected by a flush, gasketed, removable screw plug.
Lift Assistance:	Compression spring operators enclosed in telescopic tubes. Automatic hold-open arm.
Finish:	Mill finish aluminium with a bituminous coating applied to the exterior of the frame.
Hardware:	All hardware stainless steel.
Options:	See page 65.

STANDARD SIZES and WEIGHTS

Type	Size – clear internal dimensions	Overall dimensions	Weight
J-1AL H20	610mm x 610mm	762mm x 864mm	55kg
J-2AL H20	760mm x 760mm	912mm x 1014mm	64kg
J-3AL H20	915mm x 760mm (H)	1067mm x 1014mm	81kg
J-4AL H20	915mm x 915mm	1067mm x 1169mm	87kg
J-5AL H20	1065mm x 1065mm	1217mm x 1319mm	111kg
JD-1AL H20	1220mm x 760mm (H)	1372mm x 1014mm	91kg
JD-2AL H20	1220mm x 1220mm	1372mm x 1474mm	132kg
JD-3AL H20	1220mm x 1830mm (H)	1372mm x 2084mm	226kg
JD-4AL H20	1525mm x 1525mm	1677mm x 1779mm	207kg

(H) - Hinge Side

Models with "D" in the Model Type indicate double leaf configuration.

Features on all J/JD aluminium doors include



PERFORMANCE

Designed to withstand H-20 wheel loadings suitable for use in off-street locations where not subject to high density traffic.



Non-Drainage Doors



Type K and KD. Aluminium – Single or Double Leaf

Single or double leaf covers are constructed of 6mm diamond pattern plate and reinforced for a 732kg/m² live load. Features zinc plated and chromate sealed hardware, concealed hinges, and the T-CAM® lifting system for ease of operation.



K and KD

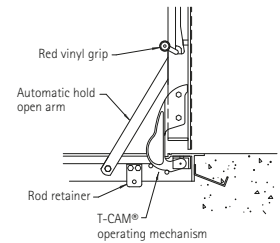
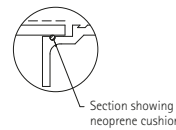
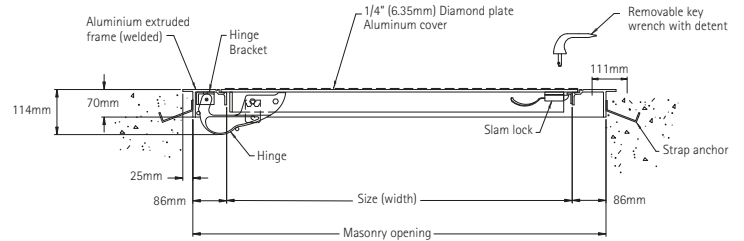
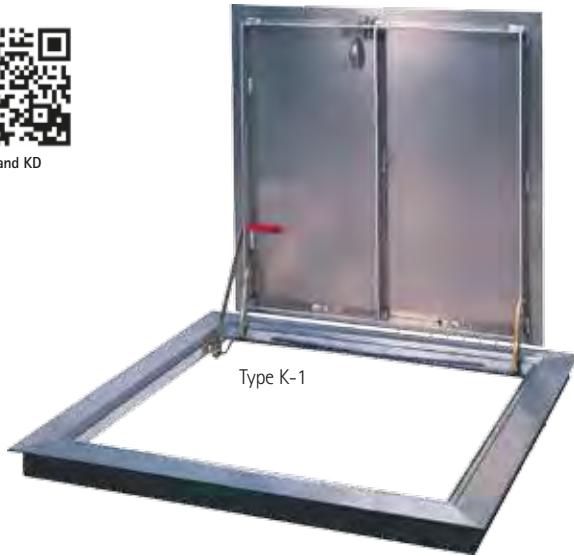

SPECIFICATIONS

- Material:** 6.3mm cover and extruded aluminium frame.
- Cover:** Diamond-pattern tread plate reinforced for 732kg/m² live load.
- Frame:** Extruded aluminium angle frame with strap anchors bolted around the perimeter.
- Hinges:** Cast steel cam-action hinges that are concealed from the exterior of the door.
- Latch:** Type 316 stainless steel slam lock with fixed interior handle and removable exterior turn/lift handle.
- Lift Assistance:** Torsion bars that pivot on cam-action hinges. Automatic hold-open arm with grip handle release.
- Finish:** Mill finish aluminium with a bituminous coating applied to the exterior of the frame.
- Hardware:** Zinc plated/chromate sealed.
- Options:** See page 65.



STANDARD SIZES and WEIGHTS

Type	Size – clear internal dimensions	Overall dimensions	Weight
K-1	610mm x 610mm	832mm x 832mm	23kg
K-2	760mm x 760mm	982mm x 982mm	30kg
K-3	915mm x 760mm (H)	1137mm x 982mm	35kg
K-4	915mm x 915mm	1137mm x 1137mm	39kg
K-5	1065mm x 1065mm	1287mm x 1287mm	50kg
KD-2	1220mm x 1220mm	1442mm x 1442mm	69kg
KD-3	1220mm x 1830mm (H)	1442mm x 2052mm	97kg
KD-4	1525mm x 1525mm	1747mm x 1747mm	101kg

(H) - Hinge Side

Models with "D" in the Model Type indicate double leaf configuration.

Non-Drainage Doors

Type TER and TRD. Aluminium – Single or Double Leaf. Accepts Architectural Flooring Material

These single and double leaf doors are designed with a pan cover to accept a variety of flooring materials up to 25mm in thickness. Each door is spring balanced at the factory to ensure smooth, easy operation upon installation of the specified flooring material in the field.



Type TER-1



TER and TRD

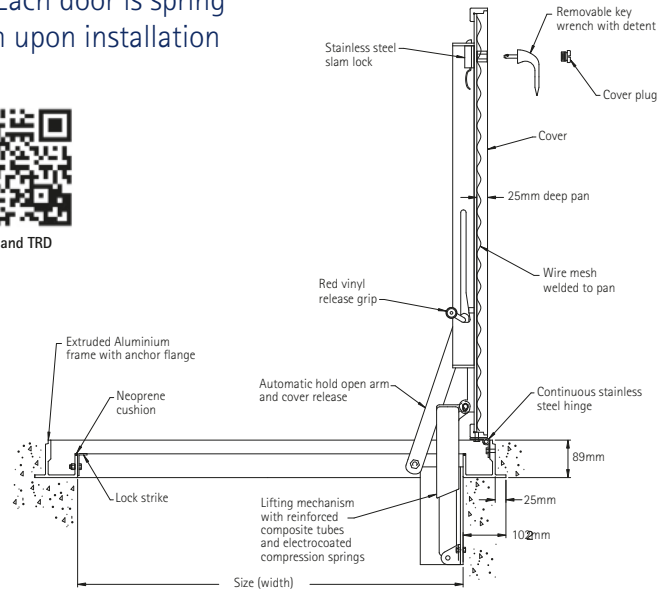

SPECIFICATIONS

Material:	6.3mm cover and extruded aluminium frame.
Cover:	Smooth plate reinforced for 732kg/m ² live load. Cover designed with 25mm fillable pan for field installation of architectural flooring material (specify flooring material including type, thickness, and weight).
Frame:	Extruded aluminium frame with built in anchor flange around the perimeter.
Hinges:	Continuous heavy-duty Type 316 stainless steel hinge.
Latch:	Type 316 stainless steel slam lock with fixed interior handle and removable exterior turn/lift handle. Latch release is protected by a flush, gasketed, removable screw plug.
Lift Assistance:	Compression spring operators enclosed in telescopic tubes. Automatic hold-open arm with grip handle release.
Finish:	Mill finish aluminium with a bituminous coating applied to the exterior of the frame.
Hardware:	Engineered composite compression spring tubes. Springs shall be manufactured from steel and packaged in grease for corrosion resistance. Type 316 stainless steel hinges. All other hardware is zinc plated/chromate sealed.
Options:	See page 65.

STANDARD SIZES and WEIGHTS

Type	Size – clear internal dimensions	Overall dimensions	Weight
TER-1	610mm x 610mm	814mm x 814mm	45kg
TER-2	760mm x 760mm	964mm x 964mm	50kg
TER-3	915mm x 760mm (H)	1119mm x 964mm	54kg
TER-4	915mm x 915mm	1119mm x 1119mm	59kg
TER-5	1065mm x 1065mm	1269mm x 1269mm	75kg
TRD-2	1220mm x 1220mm	1424mm x 1424mm	91kg
TRD-3	1220mm x 1830mm (H)	1424mm x 2034mm	125kg
TRD-4	1525mm x 1525mm	1729mm x 1729mm	129kg

(H) – Hinge Side

Models with "D" in the Model Type indicate double leaf configuration.

Note: Option available with drain coupling.

EXTERNAL APPLICATIONS

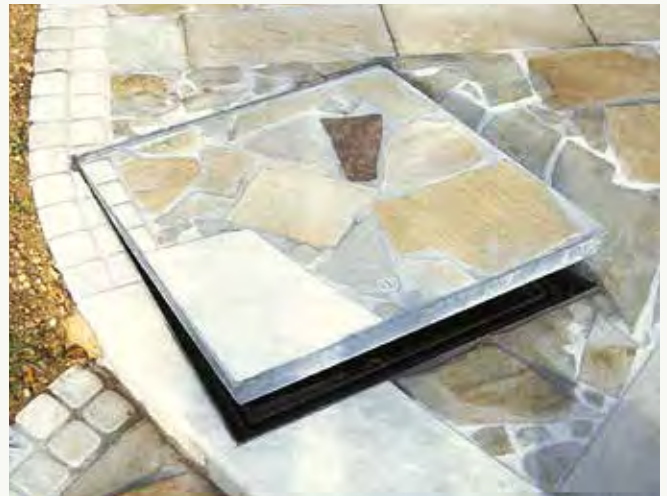



Fire Doors



Type JFR. Steel – Single Leaf – One Hour Fire-Rated

Fire-rated floor doors allow you to specify convenient access through a fire-rated floor without jeopardizing fire code compliance. Doors contain flames and limit heat transmission between fire-rated floor/ceiling assemblies, and feature fire-proof coating, balanced cover operation, and are available with a specially designed closing mechanism to ensure the door closes automatically when a fire occurs.



JFR

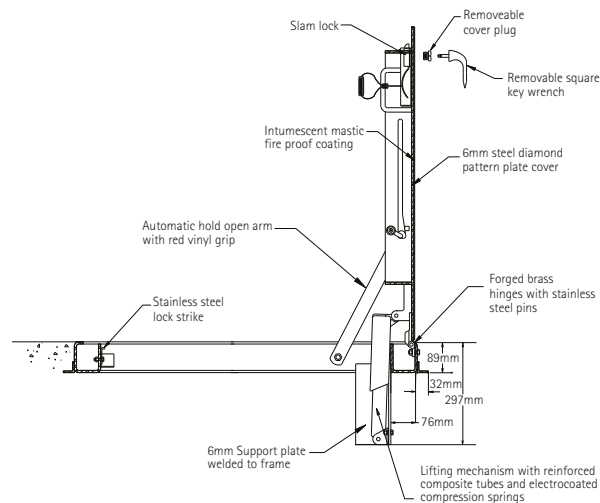

SPECIFICATIONS

Material:	Cover and frame are 6mm steel.
Cover:	Diamond pattern plate reinforced for 1464kg/m ² live load. Note: special sizes are available, but certification only available with a maximum size of 1.14m ² . Intumescent fire coating applied to the underside of the cover.
Frame:	Formed channel frame with anchor angle welded around the perimeter. Intumescent fire coating applied on the interior surfaces of the frame.
Hinges:	Heavy forged brass hinges with 10mm Type 316 stainless steel hinge pins.
Latch:	Type 316 stainless steel slam lock with fixed interior handle and removable exterior turn/lift handle. Note: can be supplied with self-closing mechanism on sizes 762mm in width and greater when specified.
Lift Assistance:	Compression spring operators enclosed in telescopic tubes. Automatic hold-open arm with grip handle release. Compression spring operators enclosed in telescopic tubes. Mechanical hold-open system with release button automatically holds the cover in the open position.
Performance Ratings:	Tested in accordance with BS476: Part 22 and approved for a 1-hour fire rating when exposed to fire from the underside.
Finish:	Alkyd base red oxide primer.
Hardware:	Engineered composite compression spring tubes. Springs shall be manufactured from steel and packaged in grease for corrosion resistance. All other hardware is zinc/plated and chromate sealed.
Options:	See page 65.

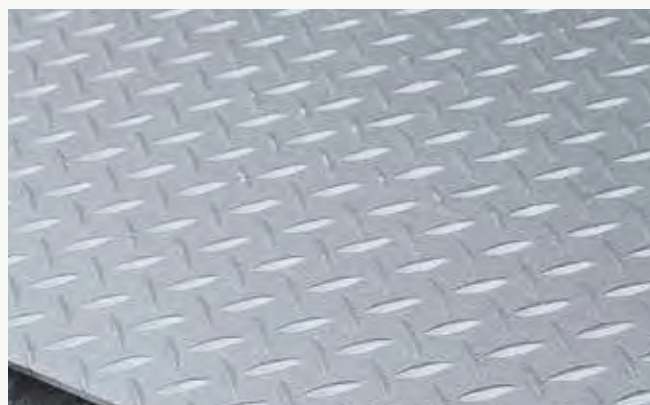

Diamond pattern cover

STANDARD SIZES and WEIGHTS

Type	Size – clear internal dimensions	Overall dimensions	Weight
JFR-1	610mm x 610mm	826mm x 826mm	99kg
JFR-2	760mm x 760mm	976mm x 976mm	132kg
JFR-3	915mm x 760mm (H)	1131mm x 976mm	158kg
JFR-4	915mm x 915mm	1131mm x 1131mm	176kg
JFR-5	1065mm x 1065mm	1281mm x 1281mm	236kg
JFR-6	760mm x 1220mm (H)	976mm x 1436mm	190kg
JFR-7	915mm x 1220mm (H)	1131mm x 1436mm	221kg
JFR-8*	760mm x 1525mm (H)	976mm x 1741mm	227kg
JFR-9*	915mm x 1525mm (H)	1131mm x 1741mm	265kg
JFR-10*	915mm x 1830mm (H)	1131mm x 2046mm	306kg

(H) - Hinge Side

*Models without BS476: Part 22 certification.

PERFORMANCE

BS476: Part 22 for integrity and insulation. Certified by Chiltern Fire International.

Fire Doors

Type FR. Aluminium – Single Leaf – Two Hour Fire-Rated

Maintains the fire rating of a 2-hour floor/ceiling assembly where access is required between building floors. Features include an optional UL Listed automatic closing system, intumescent fire resistant coating, and a pan cover designed to accept architectural flooring materials.



FR

Type FR-2

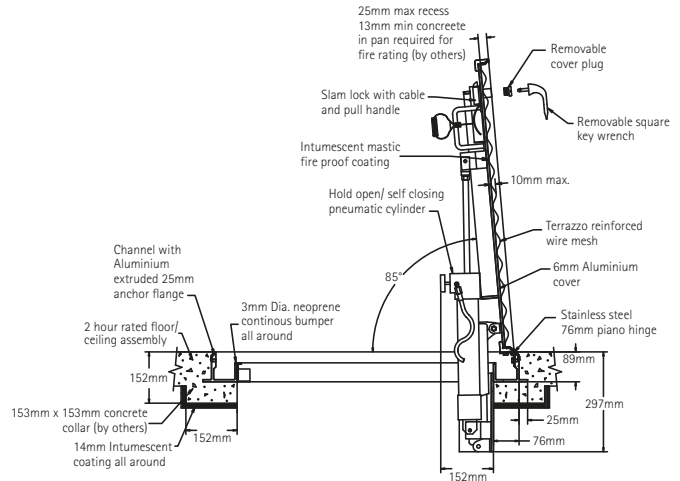

SPECIFICATIONS

Material:	6.3mm cover and extruded aluminium frame.
Cover:	Aluminium plate reinforced for 732kg/m ² live load. Intumescent fire coating applied to the underside of the cover. Designed with 25mm fillable pan for field installation of architectural flooring material up to 13mm thickness (specify flooring material including type, thickness, and weight). The remaining depth must be filled with concrete to maintain the fire rating of the door assembly (if finish flooring is not desired, the pan must be filled with 25mm of concrete).
Frame:	Extruded aluminium frame with built in anchor flange around the perimeter. Intumescent fire coating applied on the interior surfaces of the frame.
Hinges:	Continuous heavy-duty Type 316 stainless steel hinge.
Latch:	Pneumatic self closing system that automatically closes the door in the event of a fire when heat parts a UL-listed 74°C fusible link.
Lift Assistance:	Compression spring operators enclosed in telescopic tubes. Mechanical hold-open system with release button automatically holds the cover in the open position.
Performance Ratings:	Tested in accordance with BS476: Part 22, and UL-listed (file R15197) as having a 2-hour fire rating when exposed to fire from the underside.
Finish:	Mill finish aluminium with a bituminous coating applied to the exterior of the frame.
Hardware:	Engineered composite compression spring tubes. Springs shall be manufactured from steel and packaged in grease for corrosion resistance. Type 316 stainless steel hinges. All other hardware is zinc plated/chromate sealed.
Options:	See page 65.



Top side - ready to accept floor finish

New self-closing mechanism

- Simplified design takes up less frame area
- Requires lower maintenance
- More cost effective
- UL Listed

STANDARD SIZES and WEIGHTS

Type	Size - clear internal dimensions	Overall dimensions	Weight
FR-2	597mm x 711mm (H)	962mm x 962mm	123kg
FR-3	749mm x 711mm (H)	1117mm x 962mm	126kg
FR-4	749mm x 864mm (H)	1117mm x 1117mm	148kg
FR-5	902mm x 1016mm (H)	1267mm x 1267mm	167kg
FR-6	597mm x 1168mm (H)	962mm x 1422mm	149kg

(H) - Hinge Side

Available without self-closing mechanism suffix LC.

PERFORMANCE

BS476: Part 22 for integrity and insulation.
Certified by Chiltern Fire International.



Hinged Pan Covers

Type BV-GD, BVE-GD, BV-GDZ and BVH-GD Maxi. Pan Depths 50mm and 102mm with Gas Strut Lift Assist

Type BV-GD and BV-GDZ floor access panels feature a 50mm deep-hinged pan cover with gas strut lift assistance for ease of operation. The BV-GDZ includes an internal handle to allow access from the underside and is lockable. The panel is reinforced for a 125kN test load (per EN 124) and is available in galvanised steel or stainless steel (BVE-GD) construction. Type BVH-GD Maxi floor access panels feature a 102mm deep-hinged pan cover with lift assistance for ease of operation.

** Please note this product is not fully watertight. For external applications a drain coupling is included.*

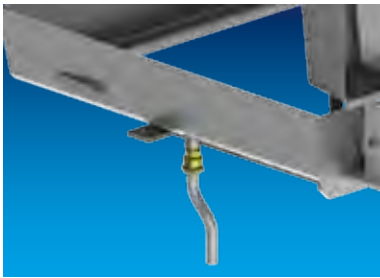

Drain coupling included for external applications



BV-GD Steel
BVE-GD Stainless Steel
Pan Depth: 50mm
Load Capacity: 125kN Test Load EN 124



BV-GDZ Steel Lockable Cover
Pan Depth: 50mm
Load Capacity: 125kN Test Load EN 124



BVH-GD Maxi Steel
Pan Depth: 102mm
Load Capacity: 125kN Test Load EN 124



STANDARD SIZES, WEIGHTS and LOAD

Type	Size - clear internal dimensions	Overall dimensions	Weight	Load
50mm Galvanised Steel				
BV-GD 66 Autom	600mm x 600mm	735mm x 752mm	29kg	125kN
BV-GD 86 Autom	800mm x 600mm	935mm x 752mm	36kg	125kN
BV-GD 88 Autom	800mm x 800mm	935mm x 952mm	42kg	125kN
BV-GD 106 Autom	1000mm x 600mm	1135mm x 752mm	40kg	125kN
BV-GD 110 Autom	1000mm x 1000mm	1135mm x 1152mm	55kg	125kN
50mm Stainless Steel				
BVE-GD 66 Autom	600mm x 600mm	735mm x 752mm	28kg	125kN
BVE-GD 86 Autom	800mm x 600mm	935mm x 752mm	35kg	125kN
BVE-GD 88 Autom	800mm x 800mm	935mm x 952mm	41kg	125kN
BVE-GD 106 Autom	1000mm x 600mm	1135mm x 752mm	40kg	125kN
BVE-GD 110 Autom	1000mm x 1000mm	1135mm x 1152mm	53kg	125kN
50mm Lockable Galvanised Steel*				
BV-GDZ 66 Autom	600mm x 600mm	735mm x 752mm	30kg	125kN
BV-GDZ 86 Autom	800mm x 600mm	935mm x 752mm	38kg	125kN
BV-GDZ 88 Autom	800mm x 800mm	935mm x 952mm	44kg	125kN
BV-GDZ 110 Autom	1000mm x 1000mm	1135mm x 1152mm	58kg	125kN
102mm Lockable Galvanised Steel*				
BVH-GD-Maxi 66	600mm x 600mm	752mm x 752mm	52kg	125kN
BVH-GD-Maxi 86	800mm x 600mm	952mm x 752mm	60kg	125kN
BVH-GD-Maxi 88	800mm x 800mm	952mm x 952mm	64kg	125kN
BVH-GD-Maxi 106	1000mm x 600mm	1152mm x 752mm	65kg	125kN

*also available in stainless steel.

Shallow Pan Covers



Type BV-Shallow

Type BV-Shallow floor access panels feature a 27mm deep pan cover to accept a wide variety of flooring materials. The panel is reinforced for pedestrian loading, for use inside buildings or in their surroundings where water tight covers are required, and is available in both galvanised steel and stainless steel construction.

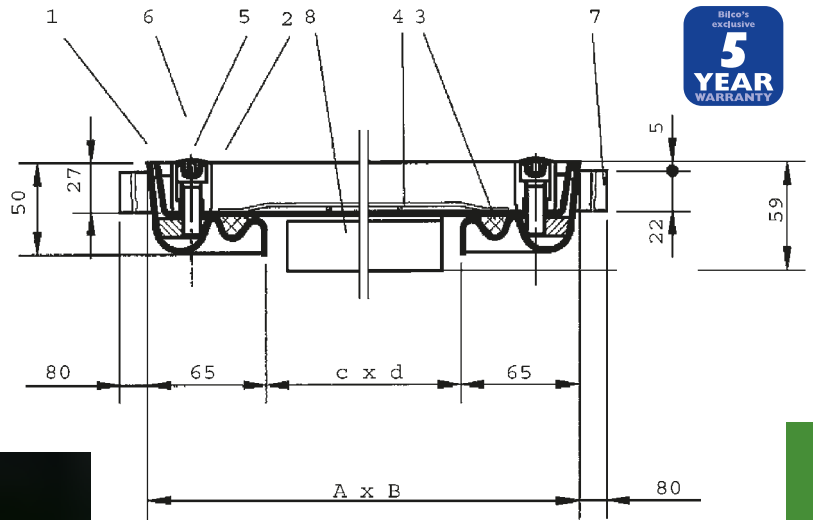

- 1. Frame
- 2. Cover
- 3. Seal
- 4. Reinforcement
- 5. Allen Screw
- 6. Plastic Cap
- 7. Anchor
- 8. Reinforcement



BV-Shallow Galvanised Steel
BVE-Shallow Stainless Steel
 Pan Depth: 27mm
 Load Capacity: Pedestrian use



Cover reinforced for pedestrian loading conditions

STANDARD SIZES, WEIGHTS and LOAD

Type	Size – clear internal dimensions	Overall dimensions	Weight	Load
Galvanised Steel				
BV-Shallow 22	200mm x 200mm	330mm x 330mm	5kg	Pedestrian
BV-Shallow 33	300mm x 300mm	430mm x 430mm	8kg	Pedestrian
BV-Shallow 44	400mm x 400mm	530mm x 530mm	12kg	Pedestrian
BV-Shallow 55	500mm x 500mm	630mm x 630mm	15kg	Pedestrian
BV-Shallow 64	600mm x 400mm	730mm x 530mm	15kg	Pedestrian
BV-Shallow 66	600mm x 600mm	730mm x 730mm	19kg	Pedestrian
BV-Shallow 86	800mm x 600mm	930mm x 730mm	24kg	Pedestrian
BV-Shallow 88	800mm x 800mm	930mm x 930mm	28kg	Pedestrian
BV-Shallow 106	1000mm x 600mm	1130mm x 730mm	27kg	Pedestrian
Stainless Steel				
BVE-Shallow 33	300mm x 300mm	430mm x 430mm	8kg	Pedestrian
BVE-Shallow 44	400mm x 400mm	530mm x 530mm	12kg	Pedestrian
BVE-Shallow 55	500mm x 500mm	630mm x 630mm	15kg	Pedestrian
BVE-Shallow 64	600mm x 400mm	730mm x 530mm	15kg	Pedestrian
BVE-Shallow 66	600mm x 600mm	730mm x 730mm	19kg	Pedestrian
BVE-Shallow 86	800mm x 600mm	930mm x 730mm	24kg	Pedestrian
BVE-Shallow 88	800mm x 800mm	930mm x 930mm	28kg	Pedestrian
BVE-Shallow 106	1000mm x 600mm	1130mm x 730mm	27kg	Pedestrian



Standard Pan Covers



Type BV, BVS250 and BVS400

Type BV and BVS floor access panels feature a 50mm deep pan cover designed to accept a wide variety of flooring materials. The panel is available with reinforcing for 125kN, 250kN, and 400kN test loads (per EN 124) and in steel and stainless steel construction.



BV Galvanised Steel
BVE Stainless Steel
Pan Depth: 50mm
Load Capacity: 125kN Test Load EN 124

STANDARD SIZES, WEIGHTS and LOAD

Type	Size – clear internal dimensions	Overall dimensions	Weight	Load
For Inside Door, Water Tight Use				
Galvanised Steel				
BV 33	300mm x 300mm	435mm x 435mm	10kg	125kN
BV 44	400mm x 400mm	535mm x 535mm	13kg	125kN
BV 45	450mm x 450mm	585mm x 585mm	16kg	125kN
BV 55	500mm x 500mm	635mm x 635mm	17kg	125kN
BV 64	600mm x 400mm	735mm x 535mm	17kg	125kN
BV 66	600mm x 600mm	735mm x 735mm	21kg	125kN
BV 635	635mm x 635mm	770mm x 770mm	22kg	125kN
BV 86	800mm x 600mm	935mm x 735mm	27kg	125kN
BV 88	800mm x 800mm	935mm x 935mm	31kg	125kN
BV 106	1000mm x 600mm	1135mm x 735mm	31kg	125kN
BV 108	1000mm x 800mm	1135mm x 935mm	37kg	125kN
BV 110	1000mm x 1000mm	1135mm x 1135mm	42kg	125kN
Stainless Steel				
BVE 33	300mm x 300mm	435mm x 435mm	9kg	125kN
BVE 44	400mm x 400mm	535mm x 535mm	13kg	125kN
BVE 55	500mm x 500mm	635mm x 635mm	17kg	125kN
BVE 64	600mm x 400mm	735mm x 535mm	16kg	125kN
BVE 66	600mm x 600mm	735mm x 735mm	20kg	125kN
BVE 86	800mm x 600mm	935mm x 735mm	24kg	125kN
BVE 88	800mm x 800mm	935mm x 935mm	30kg	125kN
BVE 106	1000mm x 600mm	1135mm x 735mm	29kg	125kN
BVE 108	1000mm x 800mm	1135mm x 935mm	33kg	125kN
BVE 110	1000mm x 1000mm	1135mm x 1135mm	40kg	125kN

1. Frame
2. Cover
3. Seal
4. Reinforcement
5. Allen Screw
6. Plastic Cap
7. Anchor

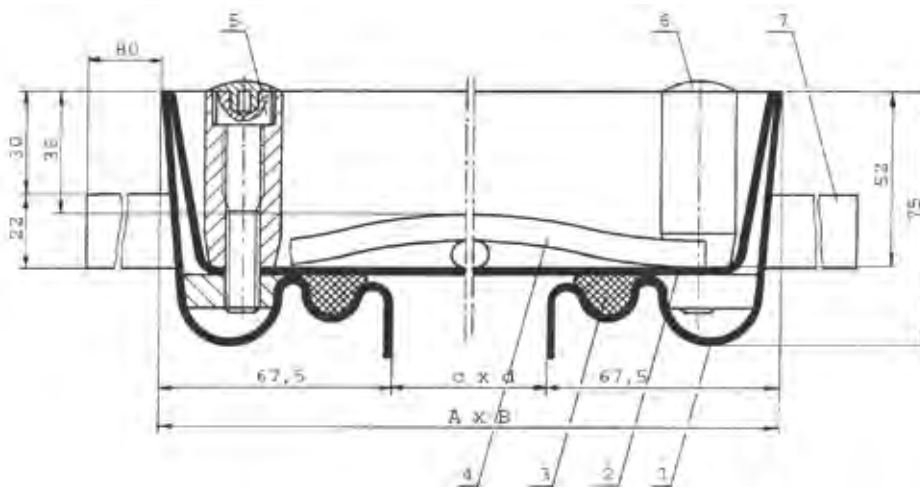

BVS-250 Galvanised Steel
BVES-250 Stainless Steel
 Pan Depth: 50mm
 Load Capacity: 250kN Test Load EN 124



BVS-400 Galvanised Steel
BVES-400 Stainless Steel
 Pan Depth: 50mm
 Load Capacity: 400kN Test Load EN 124

STANDARD SIZES, WEIGHTS and LOAD

Type	Size - clear internal dimensions	Overall dimensions	Weight	Load
For Warehouses and Loading Bays				
Galvanised Steel				
BVS 250/44	400mm x 400mm	535mm x 535mm	17kg	250kN
BVS 250/55	500mm x 500mm	635mm x 635mm	26kg	250kN
BVS 250/64	600mm x 400mm	735mm x 535mm	25kg	250kN
BVS 250/66	600mm x 600mm	735mm x 735mm	31kg	250kN
BVS 250/86	800mm x 600mm	935mm x 735mm	50kg	250kN
BVS 250/88	800mm x 800mm	935mm x 935mm	52kg	250kN
BVS 250/106	1000mm x 600mm	1135mm x 735mm	52kg	250kN
BVS 250/108	1000mm x 800mm	1135mm x 935mm	78kg	250kN
BVS 250/110	1000mm x 1000mm	1135mm x 1135mm	78kg	250kN
Stainless Steel				
BVES 250/44	400mm x 400mm	535mm x 535mm	17kg	250kN
BVES 250/55	500mm x 500mm	635mm x 635mm	26kg	250kN
BVES 250/64	600mm x 400mm	735mm x 535mm	25kg	250kN
BVES 250/66	600mm x 600mm	735mm x 735mm	32kg	250kN
BVES 250/86	800mm x 600mm	935mm x 735mm	38kg	250kN
BVES 250/88	800mm x 800mm	935mm x 935mm	51kg	250kN
BVES 250/106	1000mm x 600mm	1135mm x 735mm	49kg	250kN
BVES 250/108	1000mm x 800mm	1135mm x 935mm	52kg	250kN
BVES 250/110	1000mm x 1000mm	1135mm x 1135mm	73kg	250kN
For Heavy Duty Loading				
Galvanised Steel				
BVS 400/55	500mm x 500mm	635mm x 715mm	52kg	400kN
BVS 400/64	600mm x 400mm	735mm x 615mm	50kg	400kN
BVS 400/66	600mm x 600mm	735mm x 815mm	62kg	400kN
BVS 400/86	800mm x 600mm	935mm x 815mm	103kg	400kN
BVS 400/88	800mm x 800mm	935mm x 1015mm	105kg	400kN
BVS 400/106	1000mm x 600mm	1135mm x 815mm	119kg	400kN
BVS 400/108	1000mm x 800mm	1135mm x 1015mm	125kg	400kN
BVS 400/110	1000mm x 1000mm	1135mm x 1215mm	175kg	400kN
Stainless Steel				
BVES 400/44	400mm x 400mm	535mm x 615mm	38kg	400kN
BVES 400/55	500mm x 500mm	635mm x 715mm	48kg	400kN
BVES 400/64	600mm x 400mm	735mm x 615mm	46kg	400kN
BVES 400/66	600mm x 600mm	735mm x 815mm	58kg	400kN
BVES 400/86	800mm x 600mm	935mm x 815mm	77kg	400kN
BVES 400/88	800mm x 800mm	935mm x 1015mm	92kg	400kN
BVES 400/106	1000mm x 600mm	1135mm x 815mm	115kg	400kN
BVES 400/108	1000mm x 800mm	1135mm x 1015mm	144kg	400kN
BVES 400/110	1000mm x 1000mm	1135mm x 1215mm	170kg	400kN

Standard Pan Covers



Standard Pan Covers



Type BVA

Type BVA floor access panels feature a 66mm deep pan cover designed to accept a wide variety of flooring materials. The panel is reinforced for a 125kN test load (per EN 124) and features all aluminium construction. For use inside buildings or in their surroundings where water tight covers are required.

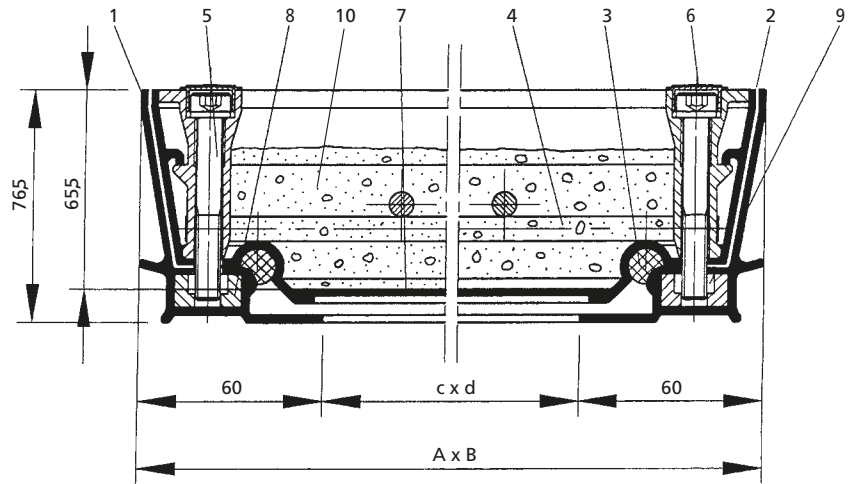

BVA Aluminium

Pan Depth: 66mm
Load Capacity: 125kN Test Load EN 124

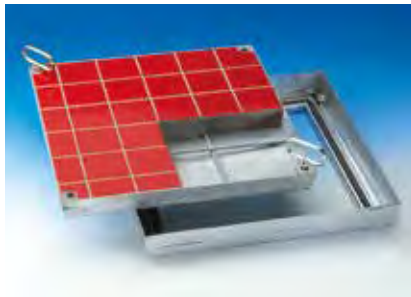

Partially filled with tiles



1. Frame
2. Cover
3. Seal
4. Reinforcement Screw
5. Allen Screw
6. Plastic Cap
7. Base Plate, Die Cast Corner, Square Boss



Filled with granite finish

STANDARD SIZES, WEIGHTS and LOAD

Type	Size - clear internal dimensions	Overall dimensions	Weight	Load
BVA 22	200mm x 200mm	320mm x 320mm	3kg	125kN
BVA 33	300mm x 300mm	420mm x 420mm	5kg	125kN
BVA 44	400mm x 400mm	520mm x 520mm	7kg	125kN
BVA 45	450mm x 450mm	570mm x 570mm	8kg	125kN
BVA 55	500mm x 500mm	620mm x 620mm	9kg	125kN
BVA 64	600mm x 400mm	720mm x 520mm	9kg	125kN
BVA 66	600mm x 600mm	720mm x 720mm	10kg	125kN
BVA 635	635mm x 635mm	755mm x 755mm	11kg	125kN
BVA 77	700mm x 700mm	820mm x 820mm	12kg	125kN
BVA 86	800mm x 600mm	920mm x 720mm	12kg	125kN
BVA 88	800mm x 800mm	920mm x 920mm	15kg	125kN
BVA 106	1000mm x 600mm	1120mm x 720mm	15kg	125kN
BVA 108	1000mm x 800mm	1120mm x 920mm	21kg	125kN
BVA 110	1000mm x 1000mm	1120mm x 1120mm	23kg	125kN

Deep Pan Covers



Type BVH-Maxi and Type BVEH-Maxi

Type BVH and BVEH Maxi floor access panels feature a 102mm deep pan cover designed to accept a wide variety of flooring materials. The panel is available with reinforcing for 125kN test loads (per EN 124) and in steel and stainless steel construction.

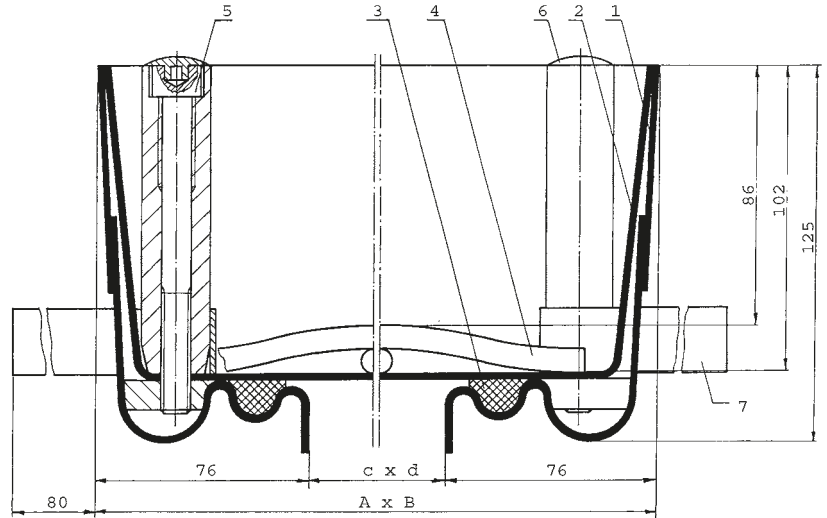

1. Frame
2. Cover
3. Seal
4. Reinforcement
5. Allen Screw
6. Plastic Cap
7. Anchor



BVH-Maxi Galvanised Steel
BVEH-Maxi Stainless Steel
 Pan Depth: 102mm
 Load Capacity: 125kN Test Load EN 124*

* When filled with a minimum 50mm layer of grade C35/45 concrete (EN 206)

STANDARD SIZES, WEIGHTS and LOAD

Type	Size - clear internal dimensions	Overall dimensions	Weight	Load
Galvanised Steel				
BVH-Maxi 44	400mm x 400mm	552mm x 552mm	22kg	125kN
BVH-Maxi 55	500mm x 500mm	652mm x 652mm	27kg	125kN
BVH-Maxi 66	600mm x 600mm	752mm x 752mm	28kg	125kN
BVH-Maxi 86	800mm x 600mm	952mm x 752mm	35kg	125kN
BVH-Maxi 88	800mm x 800mm	952mm x 952mm	40kg	125kN
BVH-Maxi 106	1000mm x 600mm	1152mm x 752mm	40kg	125kN
BVH-Maxi 110	1000mm x 1000mm	1152mm x 1152mm	60kg	125kN
Stainless Steel				
BVEH-Maxi 44	400mm x 400mm	552mm x 552mm	19kg	125kN
BVEH-Maxi 55	500mm x 500mm	652mm x 652mm	22kg	125kN
BVEH-Maxi 66	600mm x 600mm	752mm x 752mm	26kg	125kN
BVEH-Maxi 86	800mm x 600mm	952mm x 752mm	31kg	125kN
BVEH-Maxi 88	800mm x 800mm	952mm x 952mm	38kg	125kN
BVEH-Maxi 106	1000mm x 600mm	1152mm x 752mm	37kg	125kN
BVEH-Maxi 110	1000mm x 1000mm	1152mm x 1152mm	50kg	125kN



Deep Pan Covers

Type BVHS and BVEHS. Suitable for warehouses, loading bays and heavy duty loading

Type BVHS and BVEHS floor access panels feature a 102mm deep pan cover designed to accept a wide variety of flooring materials. The panel is available with reinforcing for 250kN and 400kN test loads (per EN 124) and in steel and stainless steel construction.

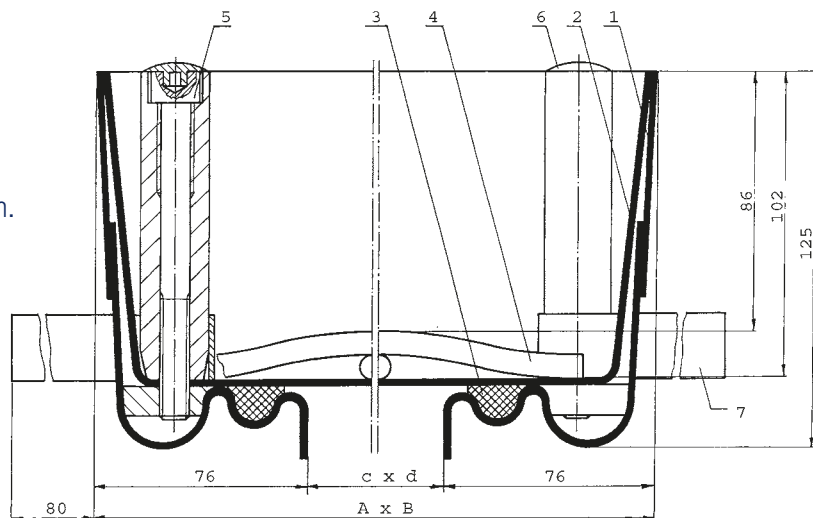

1. Frame
2. Cover
3. Seal
4. Reinforcement
5. Allen Screw
6. Plastic Cap
7. Anchor



BVHS-250 Galvanised Steel
BVEHS-250 Stainless Steel
 Pan Depth: 102mm
 Load Capacity: 250kN Test Load EN 124*



BVHS-400 Galvanised Steel
BVEHS-400 Stainless Steel
 Pan Depth: 102mm
 Load Capacity: 400kN Test Load EN 124*

STANDARD SIZES, WEIGHTS and LOAD

Type	Size – clear internal dimensions	Overall dimensions	Weight	Load
Warehouses & Loading Bays				
Galvanised Steel				
BVHS 250/44	400mm x 400mm	552mm x 552mm	25kg	250kN
BVHS 250/55	500mm x 500mm	652mm x 652mm	30kg	250kN
BVHS 250/64	600mm x 400mm	752mm x 552mm	31kg	250kN
BVHS 250/66	600mm x 600mm	752mm x 752mm	36kg	250kN
BVHS 250/88	800mm x 800mm	952mm x 952mm	61kg	250kN
BVHS 250/106	1000mm x 600mm	1152mm x 752mm	73kg	250kN
BVHS 250/110	1000mm x 1000mm	1152mm x 1152mm	85kg	250kN
Stainless Steel				
BVEHS 250/44	400mm x 400mm	552mm x 552mm	22kg	250kN
BVEHS 250/55	500mm x 500mm	652mm x 652mm	27kg	250kN
BVEHS 250/64	600mm x 400mm	752mm x 552mm	29kg	250kN
BVEHS 250/66	600mm x 600mm	752mm x 752mm	33kg	250kN
BVEHS 250/88	800mm x 800mm	952mm x 952mm	56kg	250kN
BVEHS 250/106	1000mm x 600mm	1152mm x 752mm	70kg	250kN
BVEHS 250/110	1000mm x 1000mm	1152mm x 1152mm	80kg	250kN
Heavy Duty Loading				
Galvanised Steel				
BVHS 400/44	400mm x 400mm	552mm x 632mm	47kg	400kN
BVHS 400/55	500mm x 500mm	652mm x 732mm	56kg	400kN
BVHS 400/64	600mm x 400mm	752mm x 632mm	57kg	400kN
BVHS 400/66	600mm x 600mm	752mm x 832mm	69kg	400kN
BVHS 400/88	800mm x 800mm	952mm x 1032mm	90kg	400kN
BVHS 400/106	1000mm x 600mm	1152mm x 832mm	124kg	400kN
BVHS 400/110	1000mm x 1000mm	1152mm x 1232mm	179kg	400kN
Stainless Steel				
BVEHS 400/44	400mm x 400mm	552mm x 632mm	45kg	400kN
BVEHS 400/55	500mm x 500mm	652mm x 732mm	53kg	400kN
BVEHS 400/64	600mm x 400mm	752mm x 632mm	55kg	400kN
BVEHS 400/66	600mm x 600mm	752mm x 832mm	67kg	400kN
BVEHS 400/88	800mm x 800mm	952mm x 1032mm	88kg	400kN
BVEHS 400/106	1000mm x 600mm	1152mm x 832mm	123kg	400kN
BVEHS 400/110	1000mm x 1000mm	1152mm x 1232mm	178kg	400kN

* When filled with a minimum 50mm layer of grade C35/45 concrete (EN 206)

Fire Rated and Insulated Covers



Type BV-F90 and BV-Thermo

Type BV-F90 fire-rated and Type BV-Thermo insulated floor access panels feature a watertight 50mm deep pan cover. The panel is reinforced for a 125kN test load (per EN 124) and is available in galvanised steel construction. Fire-rated accepts concrete/concrete + ceramic tiles infill. Thermo accepts concrete with architectural flooring infill.

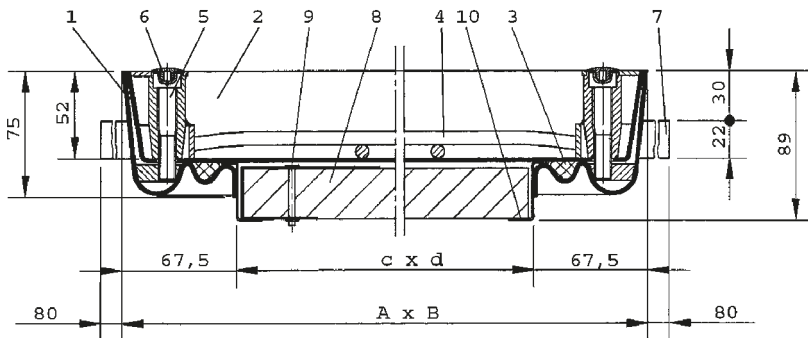

BV-F90 GALVANISED STEEL

- | | |
|--------------------------|-------------------------------|
| 1. Frame | 6. Plastic Cap |
| 2. Cover | 7. Anchor |
| 3. Seal (Fire Resistant) | 8. Fire-Protection Panel |
| 4. Reinforcement | 9. Lifting Handle |
| 5. Allen Screw | 10. Stainless Steel Z-Bracket |

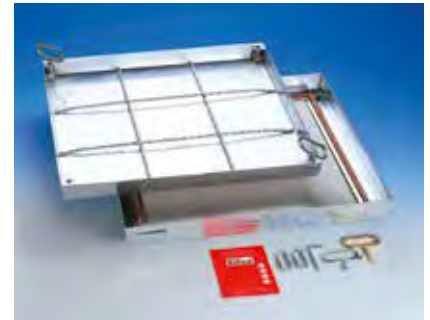

BV-F90 Fire Resistant

Pan Depth: 50mm
 Load Capacity: 125kN Test Load EN 124
 Fire Test Certificate: Resists fire for 90 minutes following a live fire-test by the Institute for Fire Protection Technology and Safety Research (IBS).

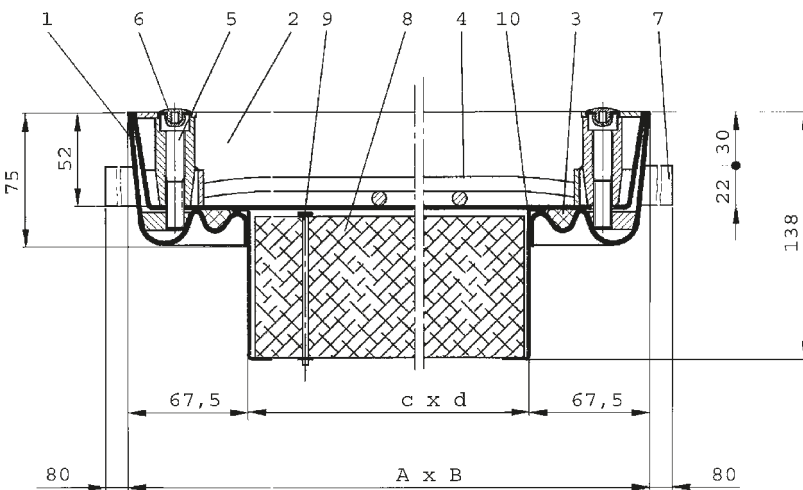

BV-THERMO GALVANISED STEEL

- | | |
|------------------|--|
| 1. Frame | 7. Anchor |
| 2. Cover | 8. Insulation Plate in Z-Bracket |
| 3. Seal | 9. Lifting Handle for Insulation Plate |
| 4. Reinforcement | 10. Alu Z-Bracket |
| 5. Allen Screw | |
| 6. Plastic Cap | |



BV Insulated

Pan Depth: 50mm
 Load Capacity: 125kN Test Load EN 124
 Thermal Properties:
 Resistance = 3.2m² K/W
 Coefficient = 0.3 W/m² K (=RC Warde).

STANDARD SIZES, WEIGHTS and LOAD

Type	Size - clear internal dimensions	Overall dimensions	Weight	Load
Fire Rated Covers - 90 Minutes				
BV-F 90 33	300mm x 300mm	435mm x 435mm	13kg	125kN
BV-F 90 44	400mm x 400mm	535mm x 535mm	18kg	125kN
BV-F 90 45	450mm x 450mm	585mm x 585mm	21kg	125kN
BV-F 90 55	500mm x 500mm	635mm x 635mm	23kg	125kN
BV-F 90 64	600mm x 400mm	735mm x 535mm	23kg	125kN
BV-F 90 66	600mm x 600mm	735mm x 735mm	30kg	125kN
BV-F 90 635	635mm x 635mm	770mm x 770mm	32kg	125kN
BV-F 90 86	800mm x 600mm	935mm x 735mm	38kg	125kN
BV-F 90 88	800mm x 800mm	935mm x 935mm	45kg	125kN
BV-F 90 106	1000mm x 600mm	1135mm x 735mm	45kg	125kN
BV-F 90 108	1000mm x 800mm	1135mm x 935mm	54kg	125kN
BV-F 90 110	1000mm x 1000mm	1135mm x 1135mm	63kg	125kN
Insulated Cover and Pan				
BV-thermo 55	500mm x 500mm	635mm x 635mm	19kg	125kN
BV-thermo 66	600mm x 600mm	735mm x 735mm	23kg	125kN
BV-thermo 86	800mm x 600mm	935mm x 735mm	29kg	125kN
BV-thermo 88	800mm x 800mm	935mm x 935mm	33kg	125kN
BV-thermo 106	1000mm x 600mm	1135mm x 735mm	33kg	125kN
BV-thermo 110	1000mm x 1000mm	1135mm x 1135mm	45kg	125kN



Metal Plate Access Covers



Type RV, RVE and RVA

Metal plate access panels feature a tread plate cover for slip resistance. The panel is watertight and is reinforced for pedestrian loading and is available in steel, stainless steel and aluminium construction.

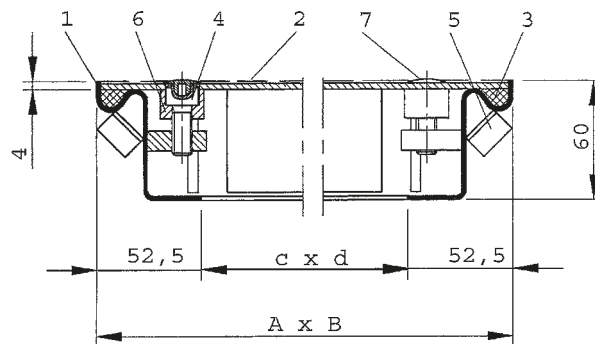

RV STEEL

1. Frame
2. Plate
3. Seal
4. Allen Screw
5. Anchor
6. Socket
7. Plastic Cap

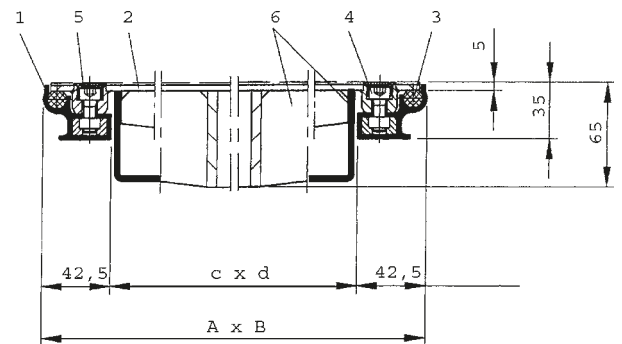

RVA ALUMINIUM

1. Frame
2. Cover
3. Seal
4. Allen Screw
5. Plastic Cap
6. Cover Reinforcement

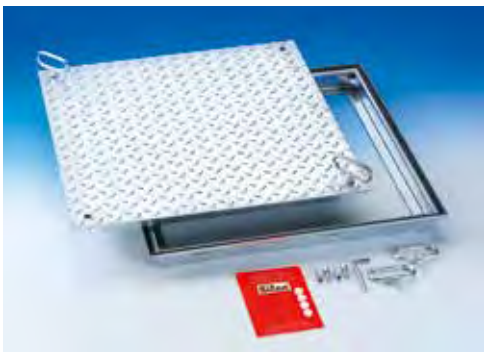

RV Galvanised Steel
RVE Stainless Steel
Load Capacity: 15kN Test Load EN 124

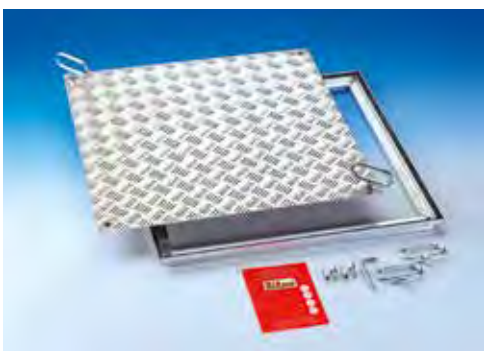

RVA Aluminium
Load Capacity: 15kN Test Load EN 124

STANDARD SIZES, WEIGHTS and LOAD

Type	Size - clear internal dimensions	Overall dimensions	Weight	Load
Galvanised Steel				
RV 64	600mm x 400mm	705mm x 505mm	22kg	Pedestrian
RV 66	600mm x 600mm	705mm x 705mm	29kg	Pedestrian
RV 86	800mm x 600mm	905mm x 705mm	37kg	Pedestrian
RV 88	800mm x 800mm	905mm x 905mm	45kg	Pedestrian
Stainless Steel				
RVE 33	300mm x 300mm	405mm x 405mm	9kg	Pedestrian
RVE 44	400mm x 400mm	505mm x 505mm	13kg	Pedestrian
RVE 55	500mm x 500mm	605mm x 605mm	15kg	Pedestrian
RVE 64	600mm x 400mm	705mm x 505mm	15kg	Pedestrian
RVE 66	600mm x 600mm	705mm x 705mm	24kg	Pedestrian
RVE 86	800mm x 600mm	905mm x 705mm	30kg	Pedestrian
RVE 88	800mm x 800mm	905mm x 905mm	36kg	Pedestrian
RVE 106	1000mm x 600mm	1105mm x 705mm	36kg	Pedestrian
RVE 110	1000mm x 1000mm	1105mm x 1105mm	54kg	Pedestrian
Aluminium				
RVA 22	200mm x 200mm	285mm x 285mm	2kg	Pedestrian
RVA 33	300mm x 300mm	385mm x 385mm	3kg	Pedestrian
RVA 44	400mm x 400mm	485mm x 485mm	4kg	Pedestrian
RVA 55	500mm x 500mm	585mm x 585mm	5kg	Pedestrian
RVA 64	600mm x 400mm	685mm x 485mm	5kg	Pedestrian
RVA 66	600mm x 600mm	685mm x 685mm	8kg	Pedestrian
RVA 86	800mm x 600mm	885mm x 685mm	10kg	Pedestrian
RVA 88	800mm x 800mm	885mm x 885mm	12kg	Pedestrian
RVA 106	1000mm x 600mm	1085mm x 685mm	12kg	Pedestrian
RVA 110	1000mm x 1000mm	1085mm x 1085mm	18kg	Pedestrian

Sealed Duct Covers



Type BVA Multi and BVA-RA

Type BVA multi floor access panels are designed for use on ducts that require a larger access area. This 66mm deep aluminium product is available in two and three section models that feature a patented cross-beam that can be easily removed without tools to give clear access to the duct.

** Please note this product is not fully watertight.*

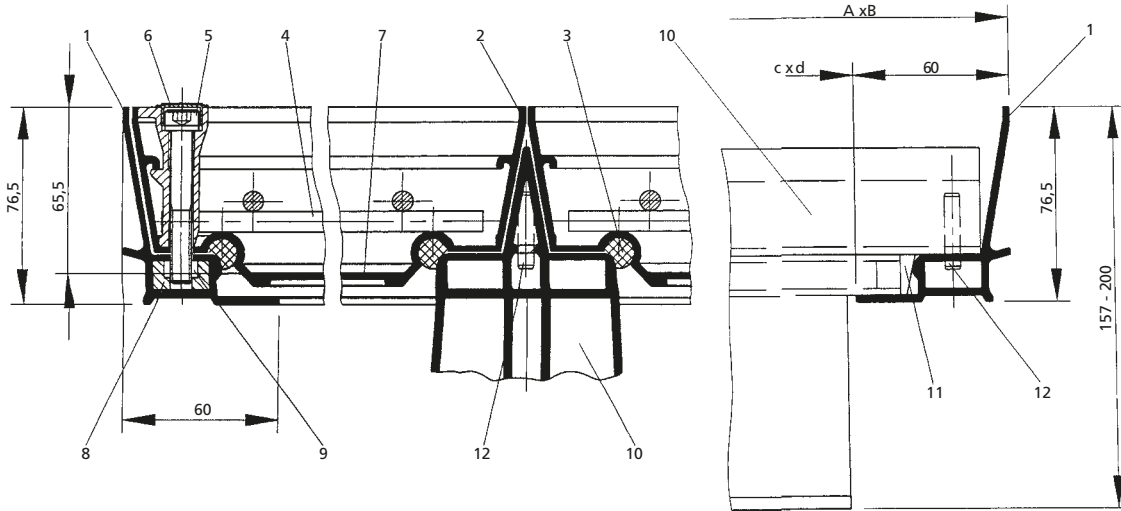

1. Frame
2. Cover
3. Seal
4. Reinforcement
5. Allen Screw
6. Plastic Cap
7. Base Plate
8. Die Cast Corner
9. Square Boss
10. Cross-Beam
11. Seal for Cross-Beam
12. Location Pin

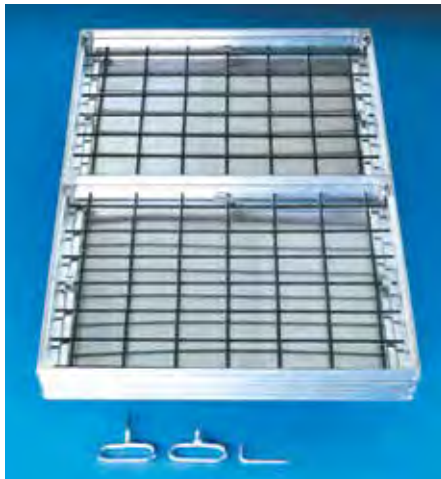

BVA Multi Aluminium
Pan Depth: 66mm
Load Capacity: 125kN Test Load EN 124



Filled with tiles - continuous run of covers through length of corridor

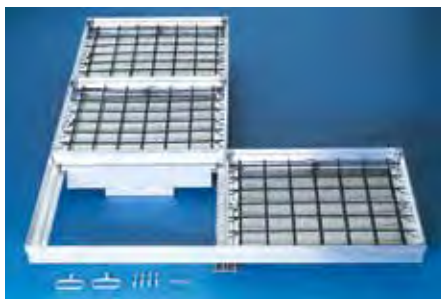

BVA-RA Aluminium
Pan Depth: 66mm
Load Capacity: 125kN Test Load EN 124



Cross Beam - can be filled and removed without tools

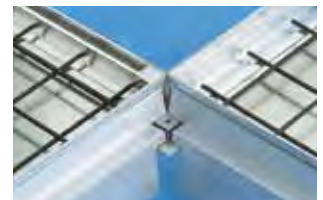

Connection of cover assemblies

STANDARD SIZES, WEIGHTS and LOAD

Type	Size - clear internal dimensions	Overall dimensions	Weight	Load
Duct Cover - 2 part				
BVA-RA Multi 2	600mm x 1320mm	720mm x 1440mm	23kg	125kN
BVA-RA Multi 2	600mm x 2030mm	720mm x 2150mm	32kg	125kN
Duct Cover - 3 part				
BVA-RA Multi 3	800mm x 1720mm	920mm x 1840mm	33kg	125kN
BVA-RA Multi 3	800mm x 2630mm	920mm x 2750mm	47kg	125kN

Also available in stainless or galvanised steel.



Composite Floor Access Cover

Innovative, easier and up to 70% lighter than concrete-filled!

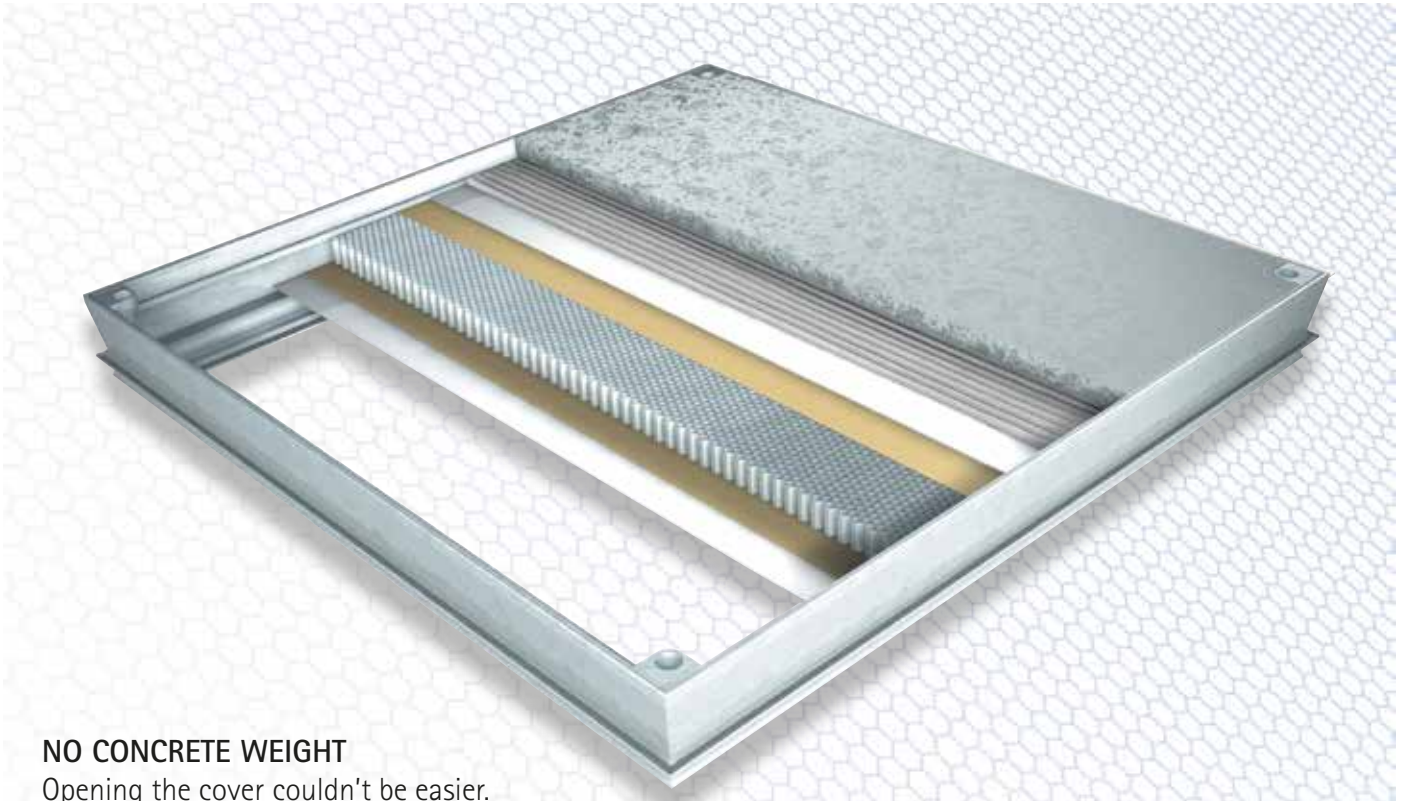

NO CONCRETE WEIGHT

Opening the cover couldn't be easier. You save up to 85kgs of weight in concrete (at a size of 80 x 80cm).

FAST INSTALLATION

Floor coverings (tiles, slabs, parquet) can be bonded on directly. No concrete filling. No concrete drying time.

NEW INNOVATION

A modern patented (European patent) access cover. Composite aluminium honeycomb plates and adhesive technology as used in aircraft construction.

Bilco have a brand new access cover range using technology from lightweight construction for aircraft.

The consistent use of lightweight construction (featherweight honeycomb panel) means maximum weight savings (no concrete filling) and easy opening.

The frame does not need to be filled with concrete. This makes installation quicker and simpler, and there's no need to wait for the concrete to dry.



Stone slabs



Tiles



Parquet

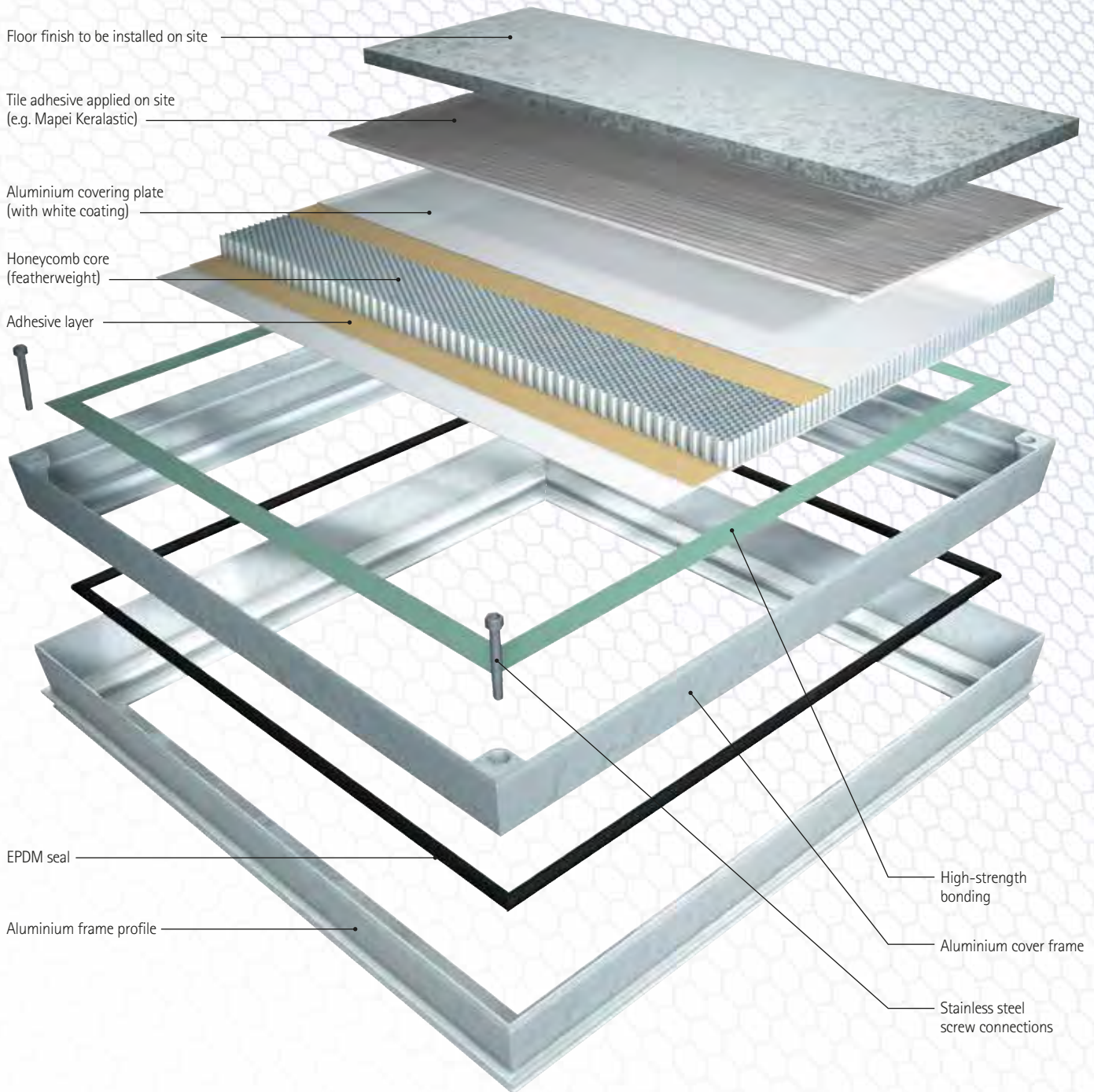



Slim Lightweight Covers

Type BVA-Slim

Type BVA-slim floor access panels feature a 14mm (plus 25mm screed) slim pan cover designed to accept a wide variety of flooring materials. The panel is reinforced for a 15kN test load (per EN 124) and features all aluminium construction for use inside buildings or in their surroundings where water-tight covers are required.

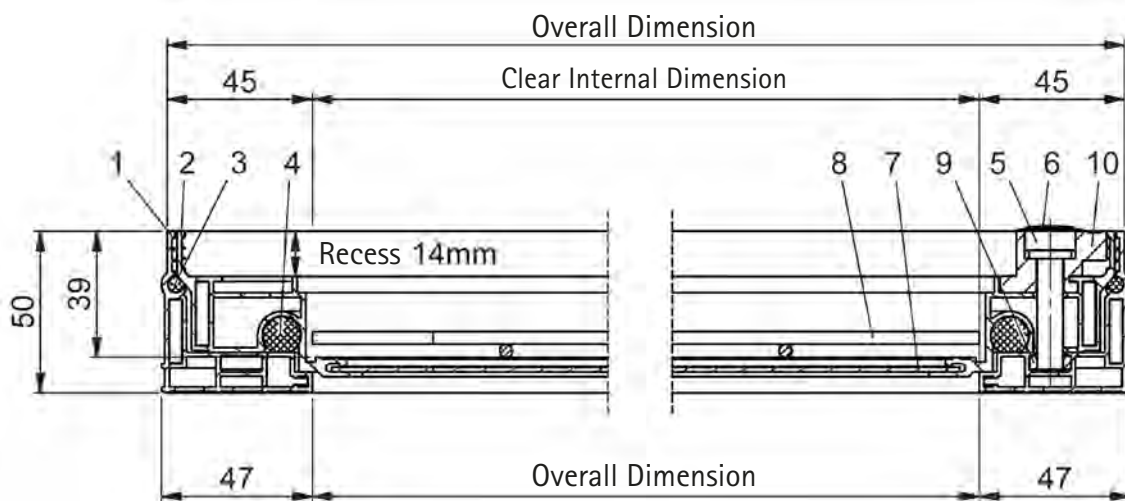

1. Frame
2. Cover
3. Top seal
4. Bottom seal
5. Allen screw (stainless steel)
6. Plastic cap
7. Cover plate (aluminium)
8. Reinforcement
9. Nut (stainless steel)
10. Casting (aluminium)

SPECIFICATIONS

Load Capacity: 15kN test load EN 124.

Material: Frame and cover sections in extruded aluminium. Stainless steel screws.

Features: Odour and waterproof access cover in high-quality finish.
 Only 5 cm installation depth. Particularly suitable for situations where greater installation depths are not possible. The shallow trough results in a weight reduction when filled - so less effort is required to lift the cover. An unrestricted height of 14mm is available for laying slabs, tiles or parquet flooring etc.
 Two chemical-resistant special seals. The cover is reinforced with a clamped steel mesh reinforcement.

Opening: Every Type BVA-Slim comes with a set of lifting keys and precise installation instructions.

Jammed covers are lifted by simply turning in the golden lifting key.

Recommended Applications: For indoor access shafts, for which a pleasant appearance is required. Also, in places where floor finishes may require grinding or where particular attention must be paid to corrosion resistance.

Installation: Installation must be carried out according to our instructions.

With water-tight models, care must be taken to seal the outer frame into the surrounding flooring and to fill the cover with water-tight concrete.



STANDARD SIZES, WEIGHTS and LOAD

Type	Size - clear internal dimensions	Overall dimensions	Weight	Load
BVA-Slim 22	200mm x 200mm	290mm x 290mm	2kg	15kN
BVA-Slim 33	300mm x 300mm	390mm x 390mm	3kg	15kN
BVA-Slim 44	400mm x 400mm	490mm x 490mm	4kg	15kN
BVA-Slim 45	450mm x 450mm	540mm x 540mm	5kg	15kN
BVA-Slim 55	500mm x 500mm	590mm x 590mm	6kg	15kN
BVA-Slim 64	600mm x 400mm	690mm x 490mm	6kg	15kN
BVA-Slim 66	600mm x 600mm	690mm x 690mm	7kg	15kN
BVA-Slim 635	635mm x 635mm	725mm x 725mm	8kg	15kN
BVA-Slim 77	700mm x 700mm	790mm x 790mm	9kg	15kN
BVA-Slim 86	800mm x 600mm	890mm x 690mm	9kg	15kN
BVA-Slim 88	800mm x 800mm	890mm x 890mm	10kg	15kN
BVA-Slim 106	1000mm x 600mm	1090mm x 690mm	10kg	15kN
BVA-Slim 108	1000mm x 800mm	1090mm x 890mm	12kg	15kN
BVA-Slim 110	1000mm x 1000mm	1090mm x 1090mm	14kg	15kN

Slim Lightweight Covers



Type CLA-Slim

Type CLA-slim floor access panels feature a 14mm deep composite light aluminium pan with reinforcing for 15kN test load. New lightweight design is much easier to lift and concrete fill is not required as the floor coverings (tiles, slabs, parquet) can be bonded directly to cover. Installation time is significantly reduced as there is no need to wait for concrete to dry.

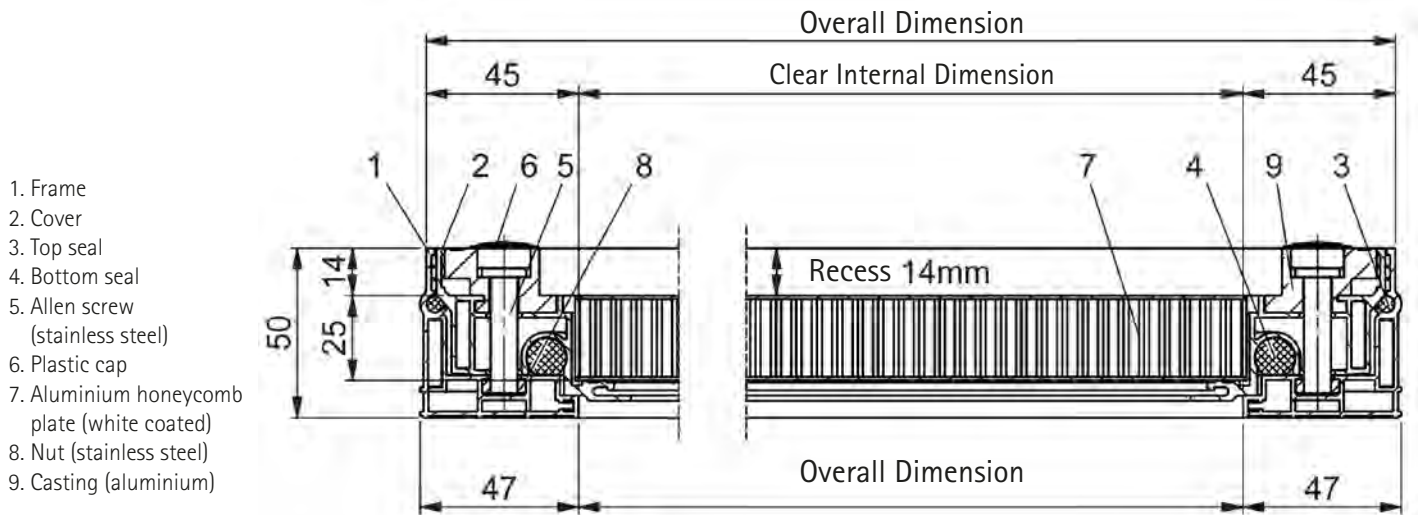

SPECIFICATIONS

Load Capacity: 15kN test load EN 124.

Material: Frame made of extruded aluminium sections. Cover made of extruded aluminium sections with composite aluminium honeycomb plate (white coated). Stainless steel screws 2 EPDM seals.

Features: Modern lightweight access cover. High weight reduction when compared with concrete filled access covers. Opening the light cover is just child's play. Since the concrete filling of the cover is omitted, the installation is much quicker and simpler. An unrestricted height of 14 mm is available for laying slabs, tiles or parquet flooring etc. Odour and waterproof access cover in high-quality finish. Pleasant visible edges. Unobtrusive corner joints ease the joining of tiles or slabs etc.

Opening: Type CLA-SL slim composite light Alu is delivered with a set of lift-out keys and precise installation instructions. Jammed covers are lifted up by simply turning the golden lift-out key.

Recommended Applications: For indoor access shafts (only accessible), which can be opened without applying excessive force.

Installation: Installation must be carried out according to our instructions. With water-tight models, care must be taken to seal the outer frame into the surrounding flooring. Connect slabs or tiles (full area) with suitable tile adhesive (MAPEI Keralastic). For thin tiles or slabs use waterproof construction panels for height compensation.



STANDARD SIZES, WEIGHTS and LOAD

Type	Size - clear internal dimensions	Overall dimensions	Weight	Load
CLA-Slim 22	200mm x 200mm	290mm x 290mm	2kg	15kN
CLA-Slim 33	300mm x 300mm	390mm x 390mm	3kg	15kN
CLA-Slim 44	400mm x 400mm	490mm x 490mm	5kg	15kN
CLA-Slim 55	500mm x 500mm	590mm x 590mm	6kg	15kN
CLA-Slim 64	600mm x 400mm	690mm x 490mm	6kg	15kN
CLA-Slim 66	600mm x 600mm	690mm x 690mm	8kg	15kN
CLA-Slim 86	800mm x 600mm	890mm x 690mm	10kg	15kN
CLA-Slim 88	800mm x 800mm	890mm x 890mm	12kg	15kN
CLA-Slim 106	1000mm x 600mm	1090mm x 690mm	12kg	15kN
CLA-Slim 108	1000mm x 800mm	1090mm x 890mm	13kg	15kN
CLA-Slim 110	1000mm x 1000mm	1090mm x 1090mm	16kg	15kN



Lightweight Covers

Type CLA

Type CLA (Composite Light Aluminium) floor access panels feature a 24mm deep pan with reinforcing for 15kN test load. New lightweight design is much easier to lift and concrete fill is not required as the floor coverings (tiles, slabs, parquet) can be bonded directly to cover. Installation time is significantly reduced as there is no need to wait for concrete to dry.

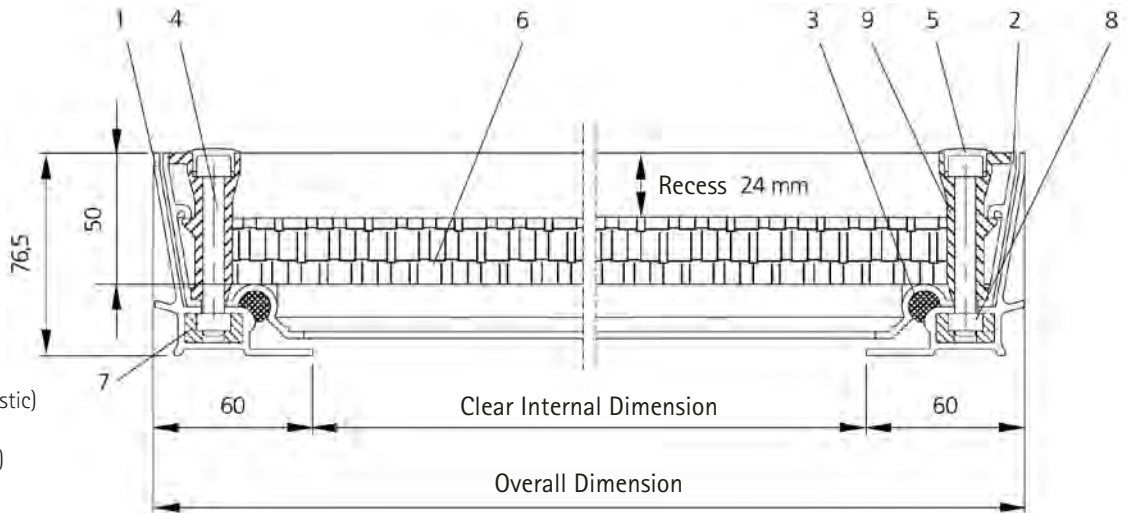

1. Frame
2. Cover
3. Seal
4. Allen screw (stainless steel)
5. Plastic cap
6. Aluminium-honeycomb plate (with white coating)
7. Injection-moulded part (plastic)
8. Square boss (stainless steel)
9. Die-cast corner (aluminium)

SPECIFICATIONS

Load Capacity: Class A (15kN test load) EN 124.

Materials: Frame in extruded aluminium. Cover in extruded aluminium bonded to a composite aluminium honeycomb panel (with a white coating). Stainless steel screw connections. EPDM sealing.

Features: Modern lightweight-construction access cover. Major weight-savings compared to concrete-filled access covers. Opening the light cover couldn't be easier. As the cover is not filled with concrete, installation is quicker and simpler. There is a recess of 24mm for laying slabs, tiles, parquet etc. In the case of thin tiles, the difference in height can be compensated for by using a suitable tile adhesive (MAPEI Keralastic) and waterproof building board. Sealed design with a very high-quality finish. Very attractive surface, particularly the visible edges. Inconspicuous corner joints make it easy to connect tiles, slabs etc.

Opening: Type CLA composite light aluminium comes with a set of lifting keys and detailed installation instructions. Jammed covers are lifted by simply turning in the golden lifting key.

Recommended Applications: As a cover inside buildings (pedestrian traffic only), which can be opened by 1-2 persons (depending on the size of the cover) without great effort.

Installation: Installation has to be carried out according to our installation instructions. In the case of water tight covers, care must be taken to seal the outer frame into the surrounding floor. Attach slabs or tiles fully (over the whole surface) with a suitable tile adhesive (MAPEI Keralastic). In the case of thin tiles or slabs, use waterproof building board to compensate for the difference in height.



STANDARD SIZES, WEIGHTS and LOAD

Type	Size - clear internal dimensions	Overall dimensions	Weight	Load
CLA-22	200mm x 200mm	320mm x 320mm	3kg	15kN
CLA-33	300mm x 300mm	420mm x 420mm	5kg	15kN
CLA-44	400mm x 400mm	520mm x 520mm	7kg	15kN
CLA-55	500mm x 500mm	620mm x 620mm	9kg	15kN
CLA-64	600mm x 400mm	720mm x 520mm	9kg	15kN
CLA-66	600mm x 600mm	720mm x 720mm	10kg	15kN
CLA-86	800mm x 600mm	920mm x 720mm	12kg	15kN
CLA-88	800mm x 800mm	920mm x 920mm	15kg	15kN
CLA-106	1000mm x 600mm	1120mm x 720mm	15kg	15kN
CLA-108	1000mm x 800mm	1120mm x 920mm	20kg	15kN
CLA-110	1000mm x 1000mm	1120mm x 1120mm	25kg	15kN

Hinged Composite Covers



Type CCA-GD with Gas Strut Lift Assist

Type CCA-GD floor access panels feature a 24mm deep hinged pan cover with gas lift assistance for ease of operation and reinforcing for 15kN test load. New lightweight aluminium design is much easier to lift and concrete fill is not required as the floor coverings (tiles, slabs, parquet) can be bonded directly to cover. Installation time is significantly reduced as there is no need to wait for concrete to dry.

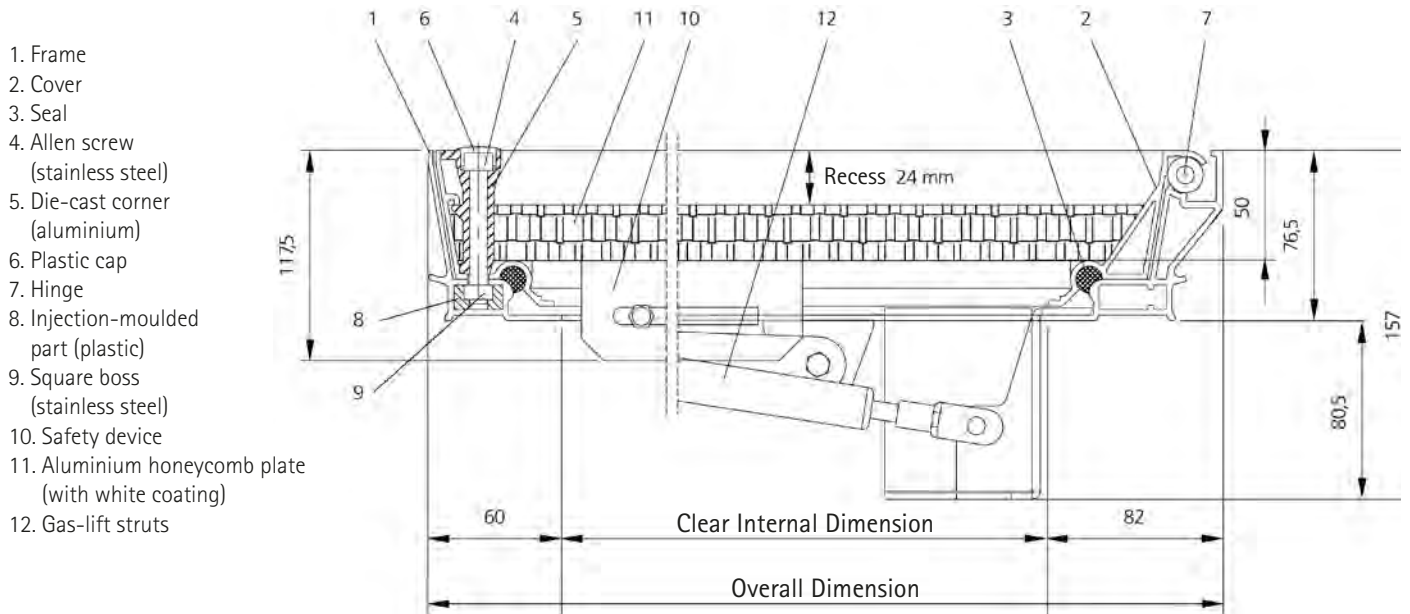

SPECIFICATIONS

Load Capacity: Class A (15kN test load) EN 124.

Materials: Frame in extruded aluminium. Cover in extruded aluminium bonded to a composite aluminium honeycomb panel (with a white coating). Stainless steel screw connections. EPDM seal. High-quality gas-lift struts.

Features: Modern lightweight-construction access cover with maximum ease of opening. Major weight-savings compared to concrete-filled access covers. Extremely easy to open thanks to gas-lift struts. A safety device is fitted, locking the cover in the raised position. As the cover is not filled with concrete, installation is quicker and simpler. There is a recess of 24mm for laying slabs, tiles, parquet etc. In the case of thin tiles, the difference in height can be compensated for by using a suitable tile adhesive (MAPEI Keralastic) and waterproof building board. Sealed design with a very high-quality finish. Very attractive surface, particularly the visible edges. Inconspicuous corner joints make it easy to connect tiles, slabs etc.

Opening: Type CCA-GD composite comfort aluminium comes with a set of lifting keys and detailed installation instructions. Jammed covers are lifted up by simply turning the golden lift-out key.

Recommended Applications: As a cover inside buildings which can be very easily opened by one person.

Installation Installation should be carried out according to our installation instructions. In the case of water tight covers, care must be taken on site to tightly seal the outer frame into the surrounding floor. Attach slabs or tiles fully (over the whole surface) with a suitable tile adhesive (MAPEI Keralastic). In the case of thin tiles or slabs, use waterproof building board to compensate for the difference in height.

STANDARD SIZES, WEIGHTS and LOAD

Type	Size - clear internal dimensions	Overall dimensions	Weight	Load
CCA-GD-66	600mm x 600mm	720mm x 742mm	13kg	15kN
CCA-GD-86	800mm x 600mm	920mm x 742mm	15kg	15kN
CCA-GD-88	800mm x 800mm	920mm x 942mm	18kg	15kN
CCA-GD-106	1000mm x 600mm	1120mm x 742mm	18kg	15kN



Safety Products

Ideal for safer access and a safer working environment

LadderUp® Safety Post

LadderUp® Safety Posts provide easier, safer ladder access through roof hatches, floor doors, and manholes.

This telescopic post permanently mounts to the top two rungs of any fixed ladder, providing a positive hand-hold and enabling the user to enter or exit an opening in an upright and balanced position.

Available in four different finishes.

SPECIFICATIONS

Install on fixed ladder(s) below hatch cover(s), LadderUp® safety post Model as manufactured by The Bilco Company. Device shall be (refer to chart for material/finish* of model specified).

It shall be designed with a telescoping tubular section that locks automatically when fully extended. Upward and downward movement shall be controlled by a stainless steel spring balancing mechanism. Unit shall be completely assembled with fasteners for securing to the ladder rungs in accordance with the manufacturer's instructions.

**If installation is to be in corrosive atmosphere, specify Model LU-2, LU-3 or LU-4 as conditions warrant.*

STANDARD SIZES and WEIGHTS

Type	Description	Weight
LU-1 BLK	Steel/black enamel	11 kg
LU-2	Steel hot dip galv	11 kg
LU-3	Stainless type 304	11 kg
LU-4	Aluminium mill finish	7 kg

LadderUps are not suitable for BL-Z or BL-Z Box products.

KEY FEATURES and BENEFITS

- Telescopic design is spring balanced for ease of operation
- Adjustable mounting hardware accommodates virtually any ladder rung size or spacing
- Automatically locks in the fully raised position to provide the user with a firm and steady hand-hold
- Handy release lever allows the post to be easily lowered to its retracted position
- Available in four levels of corrosion resistance to provide many years of trouble free, dependable service.



Adjustable mounting



Automatically locks off



Telescopic design



Handy release lever

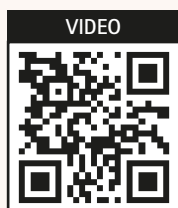

VIDEO



LadderUp® Safety Post

Fall Protection

Bilco's Fall Protection Grating System has been redesigned to offer the same level of protection at a much lower price. New features include a standard powder coat paint finish and a unique pintle hinge design that allows the grating to open to the full 90° position, maximizing the area available for access.

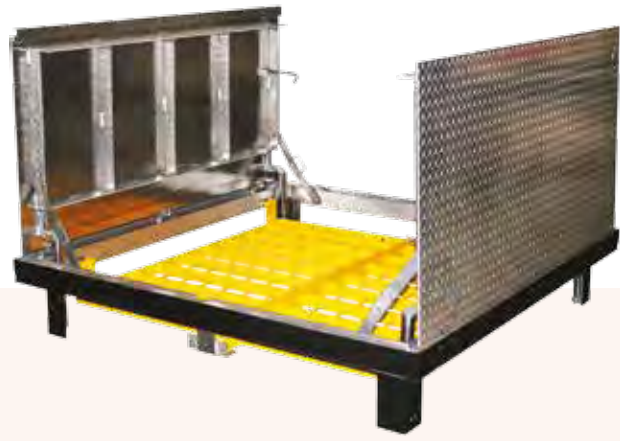

FP

The Fall Protection Grating System permanently mounts under access door covers and is available as a factory installed option on the following Bilco models:

- Type J, JD, J-AL, JD-AL-300 PSF (1464 kg/m²) and H20 reinforced Doors
- Available on all standard sizes
- Available for special sizes (contact Bilco for more information)

Retrofit kits are also available for field installation (for door models noted above)

SPECIFICATIONS

Grating panel(s) shall be aluminum with a powder coat paint finish that is safety yellow in colour. Panel shall be designed to meet the requirements of OSHA standard 29 CFR 1910.23 and be equipped with a hold open device to lock the grating panel(s) in the open position. Hold open device and all hardware shall be Type 316 stainless steel. Manufacturer shall provide a twenty-five year warranty against defects in material and workmanship.

KEY FEATURES and BENEFITS

Provides a permanent means of fall protection under access doors
Aluminum grating features a safety-yellow powder coat paint finish for added visibility
Equipped with a stainless steel automatic hold-open device that securely locks the panel in the full open position
Stainless steel hardware for corrosion resistance
Grating panel is supplied with a padlock hasp for added security
Backed by a 25-Year manufacturer's warranty

Bil-Guard® Hatch Rail System

Bil-Guard® is a fixed railing system that provides a permanent means of fall protection for hatch and smoke vent openings. It can also help provide continuous protection especially where mansafe systems have been installed on the roof area.

Bil-Guard® features an innovative attachment system that does not penetrate the roofing membrane and on standard hatches pre-drilled holes in the capflashing accept the mounting brackets.

Bil-Guard® can be installed quickly and easily using basic tools.



Self-closing stainless steel hinges

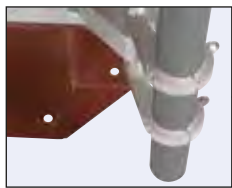

Pivoting mounting sleeve



Self-closing gate latch



RL

SPECIFICATIONS

Posts and rails are manufactured with clear lacquered aluminium.

Spring hinges are manufactured from stainless steel and the latch mechanism is aluminium and stainless steel.

STANDARD SIZES and WEIGHTS

Type	Size - clear internal dimensions	Weight	Hatch type
2RL2-STBC	915mm x 760mm (H)	28kg	S
2RL2-ETBC	915mm x 915mm	30kg	E
2RL2F-TBC	1220mm x 1220mm	32kg	F
2RL2-CSTBC	760mm (H) x 1500mm	34kg	CS
2RL2-LTBC	760mm (H) x 2440mm	40kg	L
2RLW-SSYTBC	760mm (H) x 3360mm	48kg	SSY

(H) - Hinge Side. Special sizes can also be manufactured.

KEY FEATURES and BENEFITS

Corrosion resistant - 5-year warranty
Non-penetrating attachment
Pivoting mounting sleeve for installation flexibility
Standard self-closing and latching gate feature
Available in a variety of sizes
Fits all Bilco roof hatches
Easily installed on new or existing hatches and smoke vents



Ladders



Ladder Products

Ladder access solutions for all your requirements

As a leading manufacturer and supplier of roof access hatches, Bilco UK have now introduced a range of ladders which provide suitable access solutions for most situations. With access hatches being used increasingly frequently to allow safe and regular access to roofs to carry out inspection, maintenance and repairs, and also to allow for a means of escape to/from a roof area, the need for safe and suitable ladders was obvious to Bilco.

The range of ladders available include fixed vertical ladders manufactured in either aluminium or galvanized steel which are ideal for personnel access and these can be provided with a safety cage and also a guardrail if required to meet the relevant British Standards. All of our fixed vertical ladders are manufactured to comply with BS 4211:2005 and A1 2008 and offer a much safer alternative to using movable ladders for access through a roof hatch.

We also offer a companionway ladder (ships stair) which provides a more robust solution when used with our larger hatches (e.g. the CS-50TB) and is intended for use in applications where more regular access is required. As with the fixed vertical ladders, the companionway ladder is manufactured to comply with the relevant British Standard (BS 5395: Part 3) and is available in either aluminium or mild steel.

For internal use where space/security may be an issue, we also have a retractable ladder manufactured from die-cast aluminium alloy. This is also available with a laminated wood trapdoor and lining with the option of having a fire rated steel lining and trap to either F30 or F90. The BLZ ladder is an ideal solution for occasions when access is required where floor space is at a premium and the ladder can be folded up into a roof space under the hatch. The BLZ has a number of options available including operation from above and also an electrical operation if this should be required.



Key Features and Benefits

Fixed vertical ladder available in either aluminium or galvanized steel

Complies with BS 4211:2005 + A1 2008

BL-Z and BL-ZBOX manufactured from die-cast aluminium alloy

Manufactured to EN-14975 (DN 4570)

Special sizes available on request

A range of optional extras are available for all ladders.

Typical Applications

Fixed vertical ladders for use in personnel access situations with roof access hatches (S-50TB, E-50TB, GS-50TB)

Fixed vertical ladders for exterior or interior use for roof access

Companionway ladder for more frequent access requirements using a larger access hatch (e.g. CS-50TB) or where

tools/small plant may have to be taken onto a roof to carry out maintenance

Retractable ladder for use in areas where the floor space must be kept clear in normal circumstances

Used in a variety of situations including schools, hospitals etc. to provide a secondary means of escape or access in the event of fire.

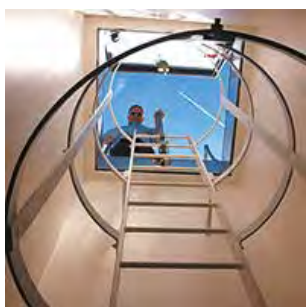

BL



BL-WH



BL-WG



BL-COMP



BL-Z



BL-Z BOX

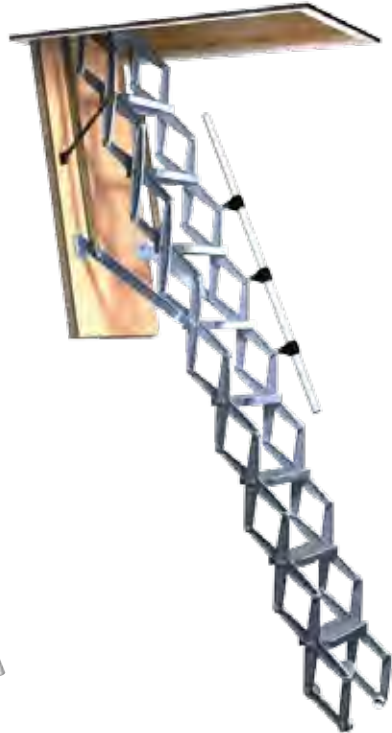



Fixed Vertical Ladder

Type BL. Without Safety Cage.
To BS 4211:2005 + A1 2008



BL

SPECIFICATIONS - ALUMINIUM

Ladder: Alloy Class 1 Stiles : 73 x 25mm
Class 1 heavy duty rung
Stand off brackets from 50 x 10mm alloy bar
Fixings in stainless steel

Ladder Width: 488mm

Finish: All alloy mill finish

Options: LadderUp® Safety Post

ALUMINIUM VERTICAL LADDER

Type	Size	Approx. Weights
BL-A-1	2.0 -2.8m	12-14kg
BL-A-2	Above 2.8 - 3.6m	14-18kg
BL-A-3	Above 3.6 - 4.4m	18-22kg
BL-A-4	Above 4.4 - 5.2m	22-26kg
BL-A-5	Above 5.2 - 6.0m	26-30kg
BL-A-SS	Special sizes available on request	

SPECIFICATIONS - MILD STEEL

Ladder: Mild Steel
Stand off brackets from 50mm x 10mm flat bar

Stiles: 50mm x 10mm flat bar

Rung: 20mm round bar

Ladder Width: 488mm

Finish: Galvanised

Options: LadderUp® Safety Post

MILD STEEL VERTICAL LADDER

Type	Size	Approx. Weights
BL-S-1	2.0 -2.8m	35-41kg
BL-S-2	Above 2.8 - 3.6m	41-53kg
BL-S-3	Above 3.6 - 4.4m	53-65kg
BL-S-4	Above 4.4 - 5.2m	65-76kg
BL-S-5	Above 5.2 - 6.0m	76-88kg
BL-S-SS	Special sizes available on request	



DON'T FORGET YOUR LADDERUP® SAFETY POST

VIDEO



Fixed Vertical Ladder

Type BL-WH. With Safety Cage.
To BS 4211:2005 + A1 2008



BL-WH



SPECIFICATIONS - ALUMINIUM

Ladder: Alloy Class 1 Stiles:
73 x 25mm box section
Class 1 heavy duty rung
Stand off brackets from 50 x 10mm alloy bar
Fixings in stainless steel
Guardrail Height: 1100mm

Ladder Width: 488mm

Finish: All alloy mill finish

Safety Cage: Cages above 2200-3000mm

Strap: 50 x 10mm alloy bar
5 x straps as BS4211: 2005 + A1 2008

Fixings: Dome head bolts

Finish: All alloy mill finish

Options: LadderUp® Safety Post

ALUMINIUM VERTICAL LADDER with SAFETY CAGE

Type	Size	Approx Weights
BL-A-WH1	2.0 -2.8m	15-18kg
BL-A-WH2	Above 2.8 - 3.6m	18-20kg
BL-A-WH3	Above 3.6 - 4.4m	20-26kg
BL-A-WH4	Above 4.4 - 5.2m	26-32kg
BL-A-WH5	Above 5.2 - 6.0m	32-37kg
BL-A-WHSS	Special sizes available on request	

SPECIFICATIONS - MILD STEEL

Ladder: Mild Steel
Stand off brackets from
50mm x 10mm bar
Guardrail Height: 1100mm

Stiles: 50mm x 10mm flat bar

Rung: 20mm round bar

Ladder Width: 488mm

Finish: Galvanised

Safety Cage: Cages above 2200-3000mm

Strap: 50mm x 10mm flat bar
5 x straps as BS4211: 2005 + A1 2008

Fixings: Dome head bolts

Finish: Galvanised

Options: LadderUp® Safety Post

MILD STEEL VERTICAL LADDER with SAFETY CAGE

Type	Size	Approx Weights
BL-S-WH1	2.0 -2.8m	45-53kg
BL-S-WH2	Above 2.8 - 3.6m	53-60kg
BL-S-WH3	Above 3.6 - 4.4m	60-77kg
BL-S-WH4	Above 4.4 - 5.2m	77-94kg
BL-S-WH5	Above 5.2 - 6.0m	94-111kg
BL-S-WHSS	Special sizes available on request	



DON'T FORGET YOUR LADDERUP® SAFETY POST

VIDEO





Fixed Vertical Ladder

Type BL-WG. With Safety Cage and Guardrail.
To BS 4211:2005 + A1 2008



BL-WG

SPECIFICATIONS - ALUMINIUM

Ladder: Alloy Class 1 Stiles: 73 x 25mm box section
Class 1 Heavy Duty Rung
Stand off brackets from 50 x 10mm alloy bar
Fixings in stainless steel
Guardrail height: 1100mm

Ladder Width: 488mm

Finish: All alloy mill finish

Safety Cage: Cages above 2200-3000mm

Strap: 50 x 10mm alloy bar
5 x straps as BS4211: 2005 + A1 2008

Fixings: Dome head bolts

Finish: All alloy mill finish

Options: LadderUp® Safety Post

In order to meet the recommendations of BS4211:2005 + A1 2008 where a ladder breaks existing handrail a self-closing gate should be fitted

ALUMINIUM VERTICAL LADDER with SAFETY CAGE and GUARDRAIL

Type	Size	Approx Weights
BL-A-WG1	2.0 -2.8m	36-38kg
BL-A-WG2	Above 2.8 - 3.6m	38-40kg
BL-A-WG3	Above 3.6 - 4.4m	40-46kg
BL-A-WG4	Above 4.4 - 5.2m	46-51kg
BL-A-WG5	Above 5.2 - 6.0m	51-57kg
BL-A-WG-SS	Special sizes available on request	

SPECIFICATIONS - MILD STEEL

Ladder: Mild Steel
Stand off brackets from 50mm x 10mm bar
Guardrail Height: 1100mm

Stiles: 50mm x 10mm flat bar

Rung: 20mm solid bar

Ladder Width: 488mm

Finish: Galvanised

Safety Cage: Cages above 2200-3000mm

Strap: 50mm x 10mm flat bar
5 x straps as BS4211: 2005 + A1 2008

Fixings: Dome head bolts

Finish: Galvanised

In order to meet the recommendations of BS4211:2005 + A1 2008 where a ladder breaks existing handrail a self-closing gate should be fitted

MILD STEEL VERTICAL LADDER with SAFETY CAGE and GUARDRAIL

Type	Size	Approx Weights
BL-S-WG1	2.0 -2.8m	105-112kg
BL-S-WG2	Above 2.8 - 3.6m	112-119kg
BL-S-WG3	Above 3.6 - 4.4m	119-136kg
BL-S-WG4	Above 4.4 - 5.2m	136-153kg
BL-S-WG5	Above 5.2 - 6.0m	153-170kg
BL-S-WGSS	Special sizes available on request	



DON'T FORGET YOUR LADDERUP® SAFETY POST

VIDEO



Companionway Ladder

Type BL-COMP. Complying with the recommendations of BS 5395: Part 3



BL-COMP



SPECIFICATIONS - ALUMINIUM

Stiles: Aluminium

Punched aluminium treads

Brackets from 50 x 10mm alloy bar

Fixings in stainless steel

All alloy in mill finish

Grabrail height: 300mm (nom)

Overall ladder width: 600mm

Ladder angle: 75 degree (nom)

ALUMINIUM COMPANIONWAY LADDER

Type	Size	Approx Weights
BL-COMPA1	Up to 1.5m	Up to 32kg
BL-COMPA2	Above 1.5 - 2.0m	32-37kg
BL-COMPA3	Above 2.0 - 2.5m	37-41kg
BL-COMPA4	Above 2.5 - 3.0m	41-46kg
BL-COMPAS	Special sizes available on request	

SPECIFICATIONS - MILD STEEL

Stiles: Mild steel

Punched mild steel treads

Brackets from 50 x 10mm flat bar

Fixings in stainless steel

Finish: Galvanised

Grabrail height: 300mm (nom)

Overall ladder width: 600mm

Ladder angle: 75 degree (nom)

MILD STEEL COMPANIONWAY LADDER

Type	Size	Approx Weights
BL-COMPS1	Up to 1.5m	Up to 88kg
BL-COMPS2	Above 1.5 - 2.0m	88-101kg
BL-COMPS3	Above 2.0 - 2.5m	101-114kg
BL-COMPS4	Above 2.5 - 3.0m	114-128kg
BL-COMPSS	Special sizes available on request	

Note:

For climb height of above 3m a rest platform is required.

An additional bracket must be specified if a LadderUp Safety Post is being used. Please call Bilco UK office for details.





Industrial Grade Retractable Ladder

Type BL-Z BOX Retractable Ladder. With laminated insulated wood trapdoor and lining



BL-Z BOX

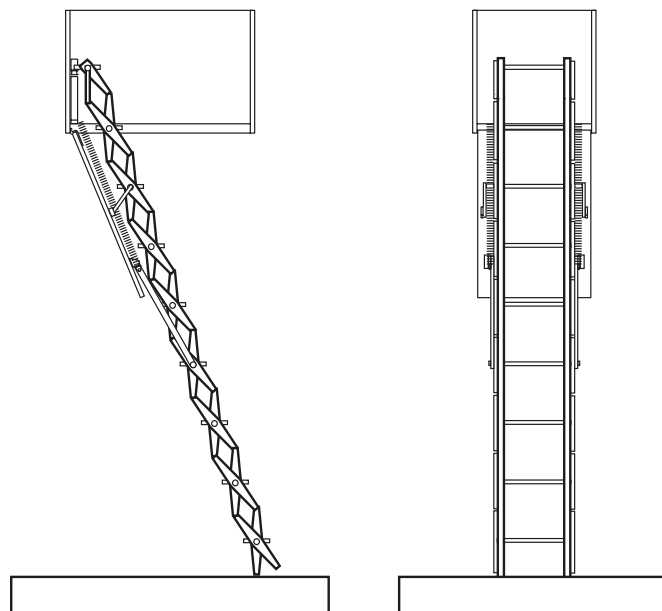
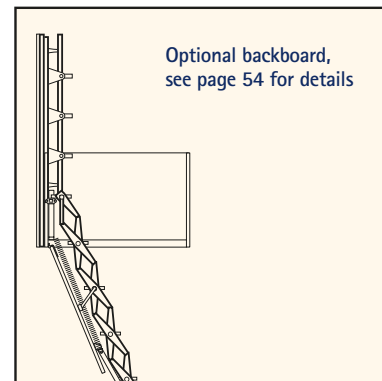

SPECIFICATIONS

References:	The BL-ZBOX industrial grade model is manufactured to EN 14975 (DN 4570) .
Materials:	The ladders are manufactured from die-cast aluminium alloy. The lining and trapdoor are manufactured from 18mm thick laminated wood (see options for fire rated box construction). Insulation – 63mm high.
Depth of Lining:	500mm (from underside of hatch to bottom of closed trapdoor). Load bearing: 200kg per tread – overall unit 500kg/m ²
Tread Size:	200/250/300/350/380/430/530/580mm wide (the 200 – 380mm wide are 140mm deep and the 430 – 580mm are 160mm).
Tread Rise:	Subject to the floor to ceiling height the usual tread rise will be between 277mm to 280mm.
Lift Mechanism:	Two heavy duty counter-balanced springs incorporated into pivot brackets.

Options:

- Telescopic handrail (Please note that this requires minimum ceiling opening length of 915mm)
- Lining depth up to 860mm deep
- Operation from above – cable/ring pull operation
- Electrically operated trapdoor and stair
- Protective varnish coating for trap door and lining
- Grabrail
- Backboard.

Fire Rated Options:

- F30 – steel lining and trap door
- F90 – steel lining and trap door
- 1.5mm thick steel hatchbox with a steel trapdoor. The trapdoor is made from 2 layers of 1.5mm thick sheet steel infilled with 38mm of mineral wool to give a 30 minute fire resistance or 75mm of mineral wool to give a 90 minute fire resistance. There is a 29mm wide lip to the bottom of the lining around the external edge, which is designed to butt up against the ceiling to help prevent flame and smoke ingress. Similarly, there is also a lip to the bottom of the steel trapdoor, which extends to within 15mm of the lip on the lining.

SIZES

Type	Floor to Ceiling Height	No of Treads	Minimum Hatch Length
BL-ZBOX-1	Up to 2500mm	9	750mm
BL-ZBOX-2	2501-2790mm	10	800mm
BL-ZBOX-3	2791-3090mm	11	900mm
BL-ZBOX-4	3091-3390mm	12	1000mm
BL-ZBOX-5	3391-3690mm	13	1300mm
BL-ZBOX-SS	Special sizes available on request		

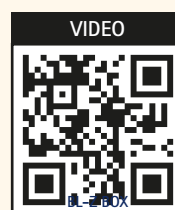

VIDEO

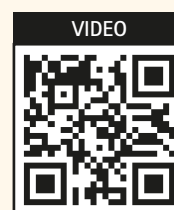

VIDEO

BL-Z BOX WITH ELECTRICALLY OPERATED TRAPDOOR

Industrial Grade Retractable Ladder

Type BL-Z Retractable Ladder

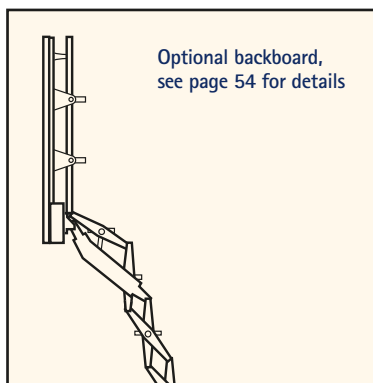

BL-Z

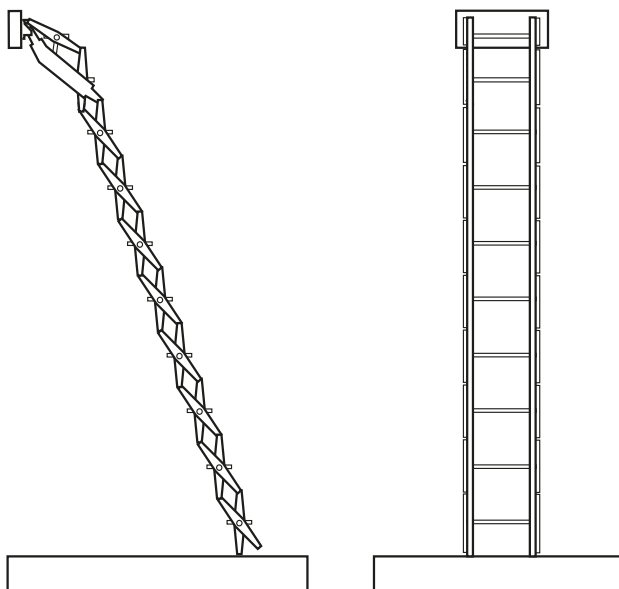

SPECIFICATIONS

References: The BL-Z industrial grade model is manufactured to EN 14975 (DN 4570).

Materials: The ladders are manufactured from die-cast aluminium alloy. The backboards are made from 18mm block wood.

Load Bearing: 200 kg per tread – overall unit 500kg/m².

Tread Size: BL-Z-1, 2 Et 3 – tread sizes 350 x 140mm.
BL-Z-4 – tread sizes 300 x 140mm.
Alternative size treads available – contact office.
Please note that where 250 mm wide treads are required these do not comply with EN 14975 (DN 4570).

Tread Rise: Subject to the floor to ceiling height the usual tread rise will be between 277mm to 280mm.

Lift Mechanism: Two heavy duty counter-balanced springs incorporated into pivot brackets.

Note: The mounting backboard width of the stairway is 580mm. This should be attached to a structural support, not the internal face of the hatch.

Options:

- Telescopic handrail (Please note that this requires a minimum ceiling opening length of 915mm)
- Grabrail
- Backboard.

SIZES

Type	Floor to Ceiling Height	No of Treads	Minimum Hatch Length
BL-Z-1	Up to 2500mm	9	620mm
BL-Z-2	2501-2790mm	10	670mm
BL-Z-3	2791-3090mm	11	750mm
BL-Z-4	3091-3390mm	12	870mm



RETRACTABLE LADDER OPTIONS

- Telescopic handrail (Please note that this requires minimum ceiling opening length of 915mm)
- Lining depth up to 860mm deep
- Operation from above – cable/ring pull operation
- Electrically operated trapdoor and stair
- Protective varnish coating for trap door and lining
- Grabrail
- Additional step (if required).



Retractable Ladder Backboard

BL-ZBOX Backboard

The BL-ZBOX Backboard provides the essential steps and safety holds required between the BL-ZBOX Ladder and the top of the structural opening or top of Roof Hatch if fitted.

The backboard comprises of a white Multiplex board, reinforced with steel uprights where required, fitted with adjustable steps (quantity of steps depends on height of backboard) fitted with 2 grab rails.

Note: The Backboard is mounted separate to the BL-ZBOX.
The use of the backboard requires the BL-ZBOX liner to be a height of 240mm so should only be ordered at the time of ordering the ladder. For retrofit please call the Bilco office.

Type	Height	Width	No of Treads	Grabrails
BL-ZBOX-BB1	1000mm	650-1200mm	2-3	2
BL-ZBOX-BB2	1001-1250mm	650-1200mm	3-4	2
BL-ZBOX-BB3	1251-1500mm	650-1200mm	4-5	2
BL-ZBOX-BB4	1501-2000mm	650-1200mm	5-6	2

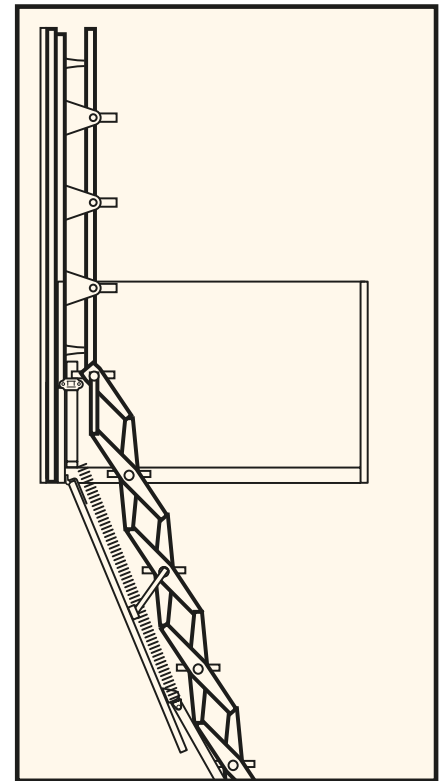

BL-Z Backboard

The BL-Z Backboard provides the essential steps and safety holds required between the BL-Z Ladder and the top of the structural opening or top of Roof Hatch if fitted.

The backboard comprises of a white Multiplex board, reinforced with steel uprights where required, fitted with adjustable steps (quantity of steps depends on height of backboard) fitted with 2 grab rails.

Note: When ordered with a BL-Z the backboard will be delivered fitted to the ladder.

Type	Height*	Width	No of Treads	Grabrails
BL-ZBB1	1000mm	650-1200mm	2	2
BL-ZBB2	1001-1250mm	650-1200mm	3	2
BL-ZBB3	1251-1500mm	650-1200mm	4	2
BL-ZBB4	1501-2000mm	650-1200mm	5	2

** BL-Z ladder will be fitted at bottom of backboard.

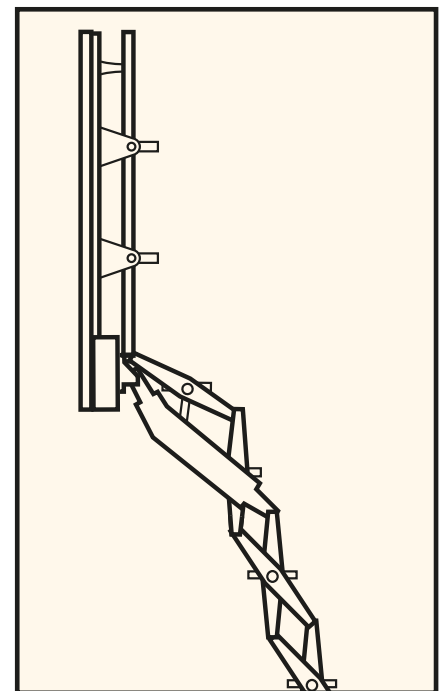

Fixed Vertical Ladder Options



Retractable Section – Fixed Vertical Ladders

Push Up or Rope Operation

Lower 2.5m (nom) of ladder can be pushed up and will automatically hook into place. Operation can be via a pole or rope and pulley operation.

Retractable Ladder is **ONLY** available on aluminium ladders.

LADDER SPECIFICATIONS

- Alloy Class 1 Stiles
- Class 1 Heavy Duty Rung
- Stand off brackets from 50 x 10mm alloy bar
- Fixings in stainless steel A4 grade
- All alloy in mill finish.

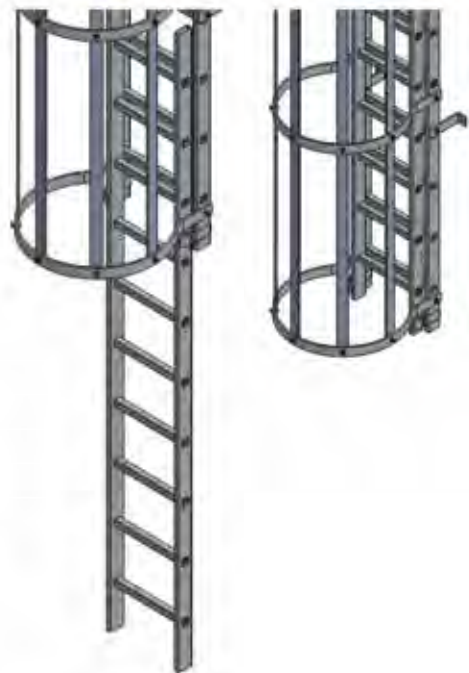

SECURITY GATE OPTIONS



◀ Hinged Gate Type 1

Aluminium 4.5mm plate gate complete with stainless steel hinge. Gate supplied with facility for padlock (padlock not included).

Hinged Gate Type 2 ▶

Aluminium 4.5mm plate gate complete with stainless steel hinge and aluminium plate blocking off access to the hoop section. Gate supplied with facility for padlock (padlock not included).



◀ Hook-on Gate

Aluminium 4.5mm plate complete with hooks and removable hasp piece. Please note this gate is a hook-on panel, no hinge is included or required. Gate supplied with facility for padlock (padlock not included).

Magnetic Locking Gate ▶

Available as an option for hinged gate types 1 or 2, gate can be fitted with a magnetic lock to allow operation from above or below, all equipment to allow gate to be unlocked from above or below is supplied, excluded is any wiring required to integrate with the existing electrical supply.





Fixed Step-over Unit

BP45-A-F and BP45-S-F

Wherever transit is required over ducting, parapet walls, conduit or any roof obstruction a step over unit, freestanding or fixed to the ground, is the safest access available.

Complying with the Work at Height Regulations and, where applicable, BS5395: Part 3 step over units give flexible access over a range of widths and heights while keeping the operative safe and enclosed in handrail at all times.

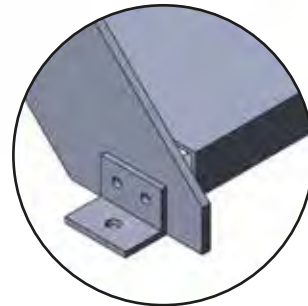
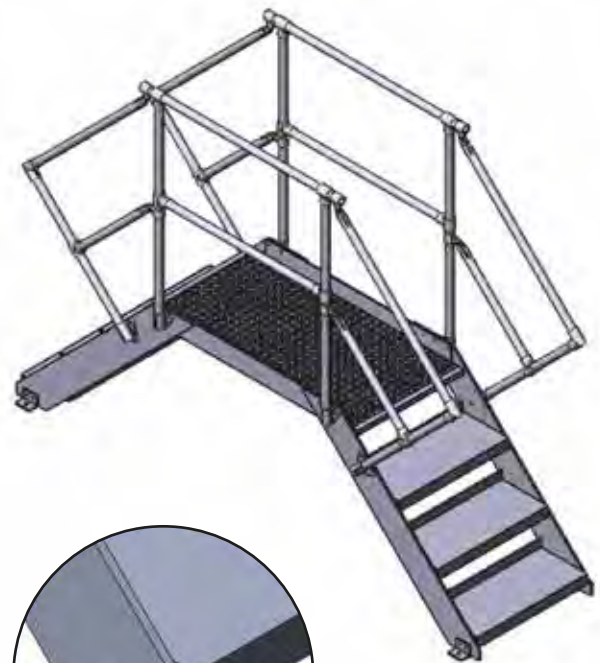

Fixing Points

BP45-A-F

SPECIFICATIONS - ALUMINIUM

Ladder:	Aluminium Stiles Aluminium folded chequerplate treads
Handrail Height:	900mm (nom)
Overall Ladder Width:	600mm
Ladder Angle:	45 degree (nom)
Fixings:	Stainless steel A4 grade
Finish:	All alloy in mill finish
Platform:	Platform to have handrails to both sides
Construction:	Aluminium section
Platform Deck:	Open mesh GRP
Handrail:	Handrails to be fitted to both sides of platform
Height:	1100mm above surface of decking
Top Rail:	35mm diameter tube
Midrail:	35mm diameter tube
Fixings:	All internal fixings to be dome
Finish:	Mill finish aluminium

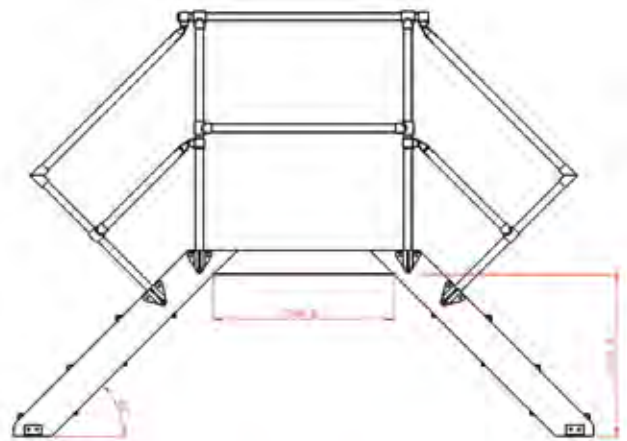

Free-standing Step-over Unit

BP45-A-FS and BP45-S-FS

Wherever transit is required over ducting, parapet walls, conduit or any roof obstruction a step over unit, freestanding or fixed to the ground, is the safest access available.

Complying with the Work at Height Regulations and, where applicable, BS5395: Part 3 step over units give flexible access over a range of widths and heights while keeping the operative safe and enclosed in handrail at all times.



Ladders



Bilco exclusive
12 MONTH WARRANTY



Adjustable Feet

BP45-A-FS

SPECIFICATIONS - ALUMINIUM

Ladder:	Aluminium Stiles Aluminium folded chequerplate treads
Handrail Height:	900mm (nom)
Overall Ladder Width:	600mm
Ladder Angle:	45 degree (nom)
Fixings:	Stainless steel A4 grade
Finish:	All alloy in mill finish

Platform:	Platform to have handrails to both sides
Construction:	Aluminium section
Platform Deck:	Open mesh GRP

Handrail:	Handrails to be fitted to both sides of platform
Height:	1100mm above surface of decking
Top Rail:	35mm diameter tube
Midrail:	35mm diameter tube
Fixings:	All internal fixings to be dome
Finish:	Mill finish aluminium

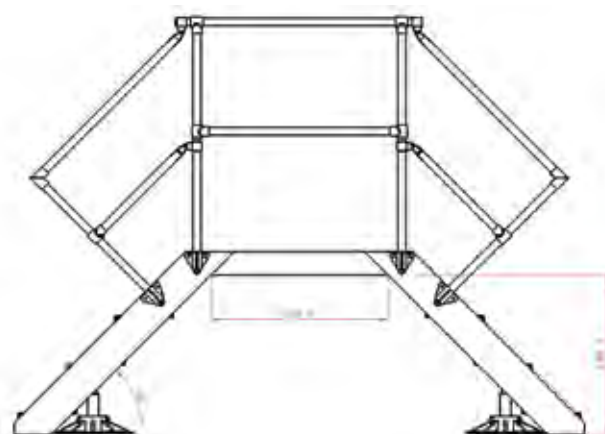



Ladders



Roof Mounted Walkway

BWALK-A

The Bilco walkway range is designed and manufactured following the recommendations of BS5395: Part 3.

This example illustrates our standard specification, our design team can produce bespoke designs to suit most situations.



SPECIFICATIONS - ALUMINIUM

Walkway:

Overall Walkway Width:	700mm
Walkway Width (inside handrails):	600mm
Finish:	Mill finish aluminium

GRP Walkway Panels:

GRP panels 1.22 x 0.6m with non-slip glass fibre surface

Panel Mesh Size:	30 x 30mm open mesh
Bars:	25 x 2mm bars
Edge:	25 x 2mm on all four sides

Handrail:

Handrails to be fitted to both sides of walkway

Height:	1100mm above surface of decking
Top Rail:	50mm diameter tube
Midrail:	Aluminium box section
Fixings:	All internal fixings to be dome
Finish:	Mill finish aluminium

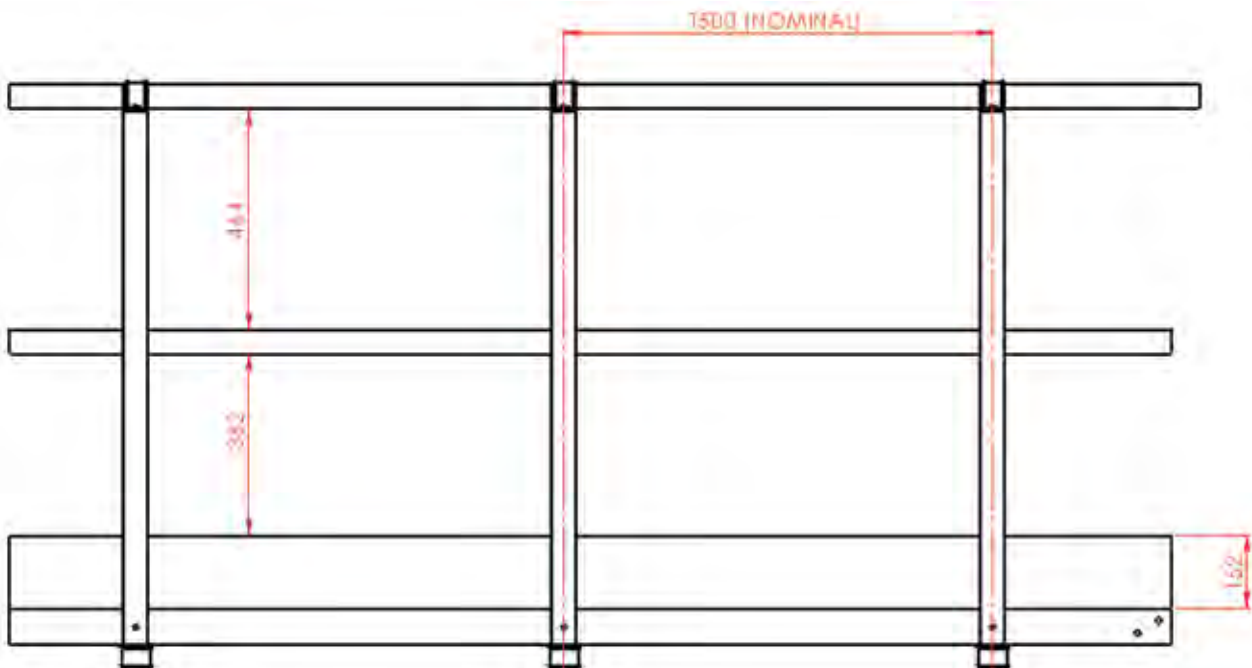
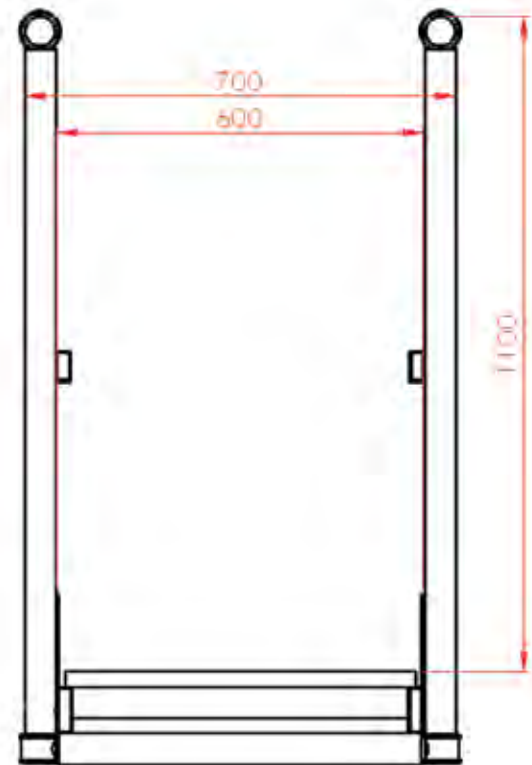



BILCO BWALK-A WALKWAY SYSTEM FIXING OPTIONS

Pedestal Fixing

Often used for gutter cleaning or access; a bespoke pedestal can be manufactured to allow the maximum possible walkway width even on narrow gutters.

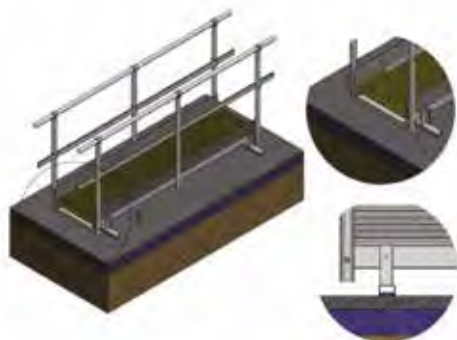
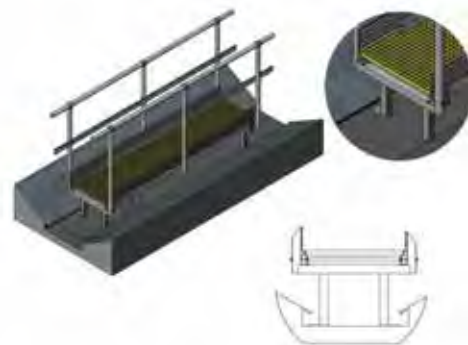

Free-Standing

Where a roof cannot be penetrated i.e. membrane or asbestos roofs, a spreader bar can be used to effectively spread the loads.

Penetrative Fixing

If the roof is of a suitable structure, i.e. steel profile or concrete roof, bespoke fixing brackets can be manufactured to secure the walkway directly to the roof structure.

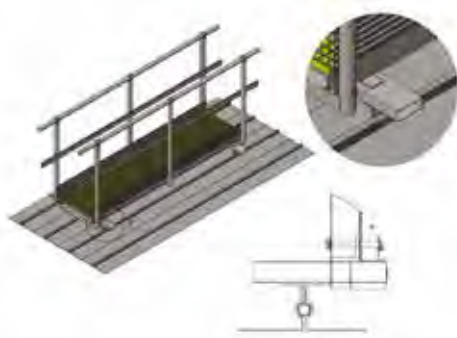
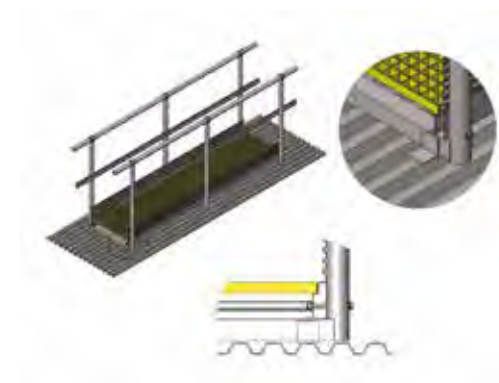

Raised Seam

For most raised seam profile roofs, a clamp bracket is used to quickly and securely fasten the walkway to the profile of the roof seam.



Roof Edge Protection



To fully comply with Work at Height Regulations 2005 handrails should be provided to prevent falls.

Bilco can now offer a system that provides a permanent or temporary solution but without the need to mechanically fix the system to the roof itself. This design overcomes the problems often associated with permanent fixing which can damage the roof membrane often causing water penetration and costly damage.

This system is a free-standing guard rail system and so it can be installed without affecting the integrity of the roof, it is intended for use as Permanent Roof Edge Protection.

KEY ADVANTAGES

- Aesthetically pleasing
- Maintenance-free
- No structural fittings
- Recycled rubber counterweights.

The height of the guardrail is set at 1100mm. All vertical supports are set at no more than 2.5m centres with counter weights set at no more than 5m centres on a straight run.

Counterweights are manufactured from recycled rubber, reducing any abrasion on the roof.

FEATURES

- Legs rotate 180 degrees and are telescopic or totally removable for complete roof access beneath the system
- Grubs screw fixing for speed of installation
- Swept corners enhance the aesthetic appeal of the system and can maintain the architectural lines of the roof.



ROOFEP-1

Galvanised steel handrail (including free-standing posts)

ROOFEP-2

Galvanised steel free-standing end including rubber counterweight



Double weight on free-standing end

Every other post, short leg without weight

Every other post, long leg including weight

Example of a STRAIGHT RUN

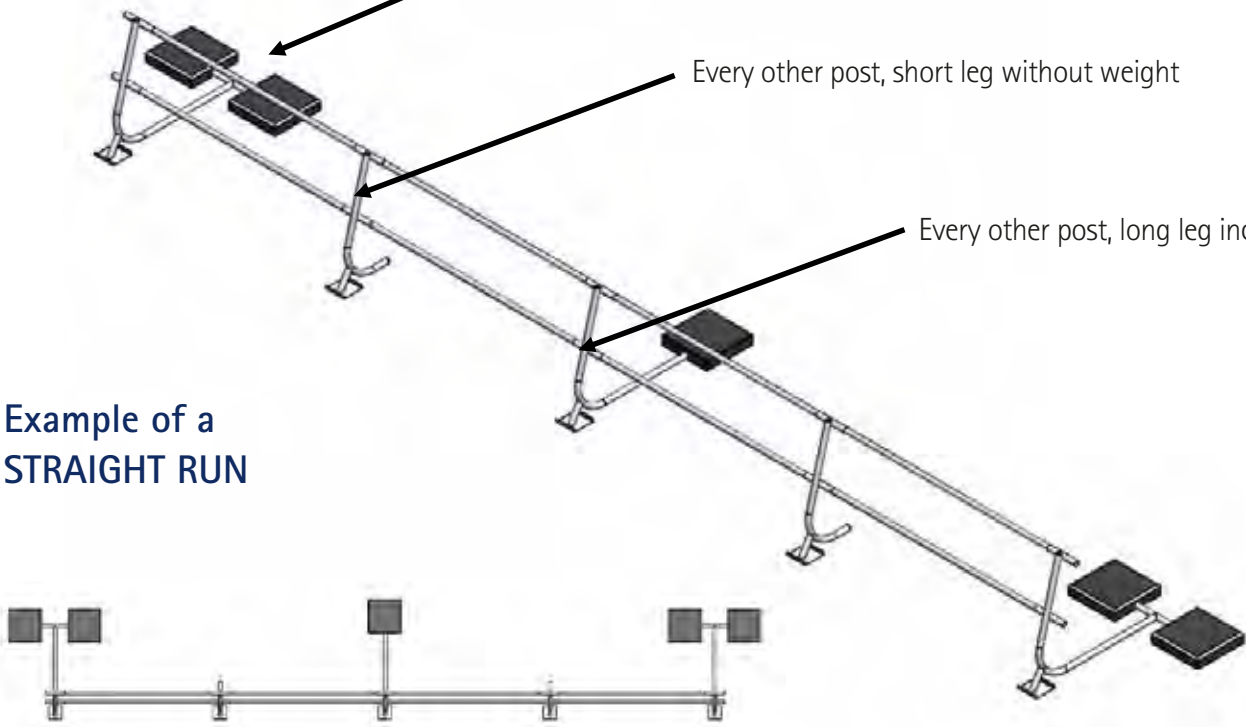

Every other post, short leg without weight

Every other post, long leg including weight

Example of a CONTINUOUS RUN

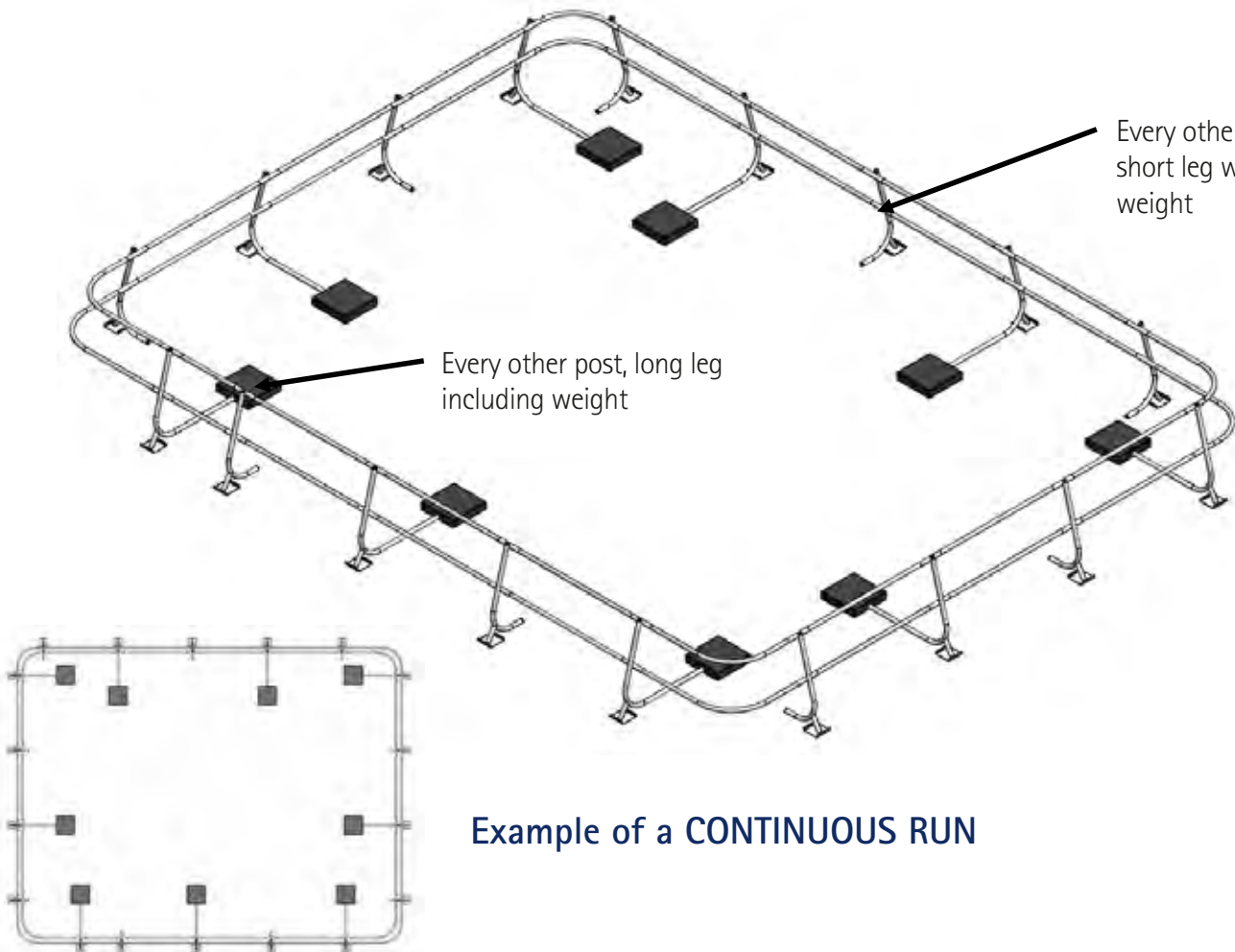

CURB OPTIONS

Curb Liner

Metal insulation liner of the same materials as the curb and capflashing. Ideal for applications where aggressive adhesives or torch applied weather proofing systems are being used.

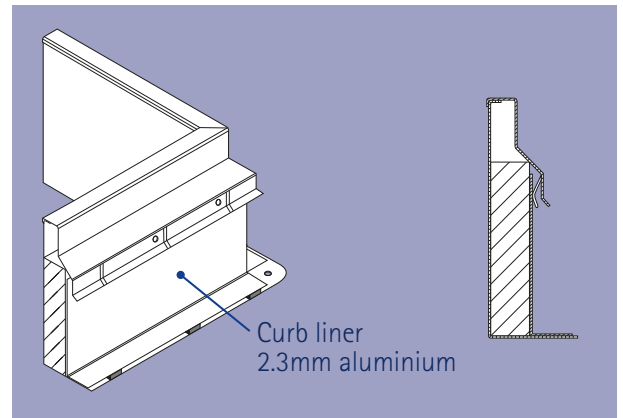

Fully Enclosed Curb

Insulation liner of the same materials as the curb, which replaces the capflashing. Used with hot applied systems or where the hatch is welded directly to the roofing panel.

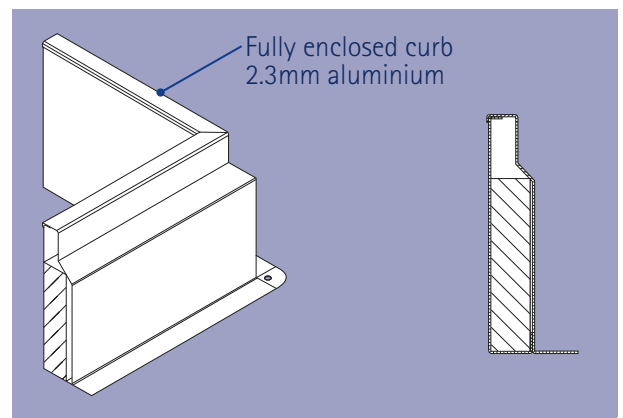

Flanged Apron Design

A 'top-hat' design which makes installation very easy and virtually eliminates the problems of water proofing on the roof. Ideal for situations where the roofing material is applied prior to the hatch or vent arriving on-site.

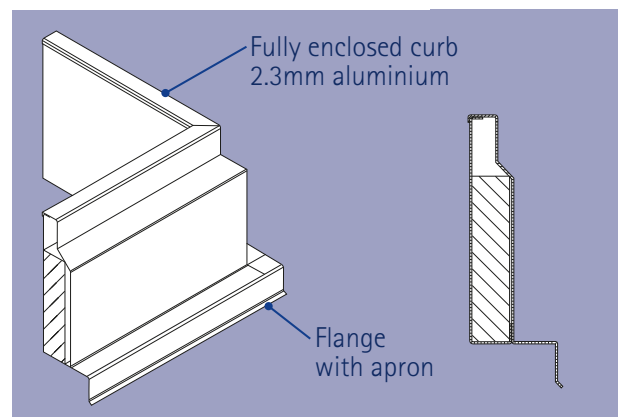

BUILT-IN LOUVERS

Useful for reducing condensation in buildings or for air displacement in lift shafts.



POWERED ACCESS OPTION – Single leaf

Control kit for powered access hatch (RPREM-D24).



POWERED ACCESS OPTION – Double leaf

Control kit for powered access hatch.

Control panel with synchronising unit (RPREM-22).



WIND DEFLECTORS

Replacement wind deflectors available for ESW or UDF-50REM.



PAINT FINISHES

Common options include polyester powder coating, anodizing aluminium as well as Tnemec® finishes. Stock items can be polyester powder coated to any standard RAL or BS colour within 2-3 weeks.



SECURITY OPTIONS

Keyed Cylinder Locks

Provide keyed exterior access and are available with either keyed or turn knob interior access. Ideal security enhancement for many applications. For added security and weathertightness, the lock cylinder is accessed from the exterior through a gasketed, threaded deck plate.



Detention Locks

Provide keyed interior and exterior access and are ideal for prisons and other buildings requiring a maximum level of security. For added security and weathertightness, the lock is accessed from the exterior through a gasketed, threaded deckplate. Bilco roof hatches can be prepared for field installation of many leading lock brands.



Emergency Egress

Bilco roof hatches can be supplied with a panic latch for rapid egress in an emergency situation. Available with keyed exterior access.

EXPLOSION RELIEF SMOKE VENTS

Bilco automatic smoke vents may also be equipped to operate as explosion vents or as combination fire/explosion vents. The explosion release mechanism is preset and factory-tested to release at between 122kg/m² and 146kg/m² of pressure on the underside of the covers.



STAINLESS STEEL HARDWARE

Installation in highly corrosive environments, Type 316 stainless steel hardware, including slam latch and lifting mechanism assemblies; hold-open arms and guides; all brackets, hinges, pins, and fasteners are standard on J-AL, JD-AL, J-ALH20 and JD-ALH20.

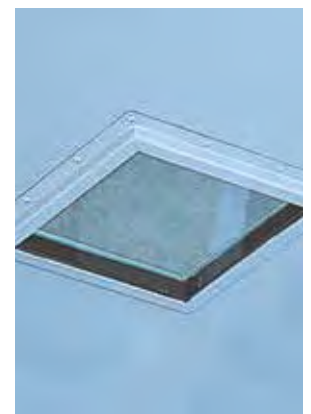
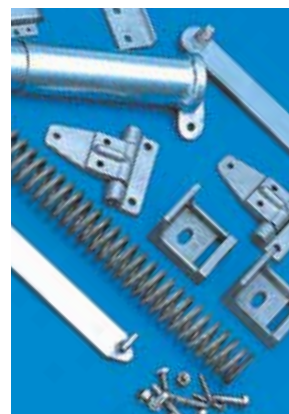

SECURITY GLAZING

Allows personnel to visibly scan a secure area before entering or exiting a roof area. Glazing is available in ballistic ratings.

Floor Access Options

Bilco floor access options can include any of the modifications shown below



STAINLESS STEEL

In highly corrosive environments or where there is prolonged exposure to hot water or steam all steel and aluminium doors are available with Type 316 stainless steel hardware. Included are all parts of the latch and lifting mechanism assemblies; hold-open and guide arm and guides; and all brackets, hinges, pins and fasteners.

Note: Standard on J-AL, JD-AL, JAL-H20, JD-ALH20.



Cylinder lock with a keyway protected by a threaded cover plug



Recessed padlock hasp covered by a flush hinged lid

PAINT FINISHES

All aluminium doors can be supplied with an anodized finish. Other custom finishes are available when specified.

LOCKS and LATCHES

Four standard lock options are available to add security and prevent unauthorized access. Additional lock options include padlock lugs welded to the exterior door surface, high security detention locks and magnetic locks are available on request.



Security cover McGuard plugs



Panic lock

OTHER OPTIONS

Handrails

Steel or aluminium grating

Slip resistant coatings

Submersible pump guide rail brackets

Metal enclosed insulation

Drop-in installation modifications

Snow and ice melting cables

Electric motor operation.

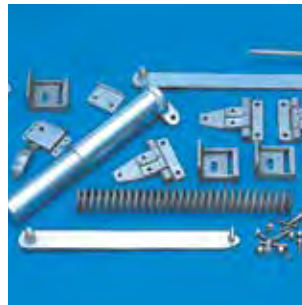

Stainless steel hardware



Special finishes

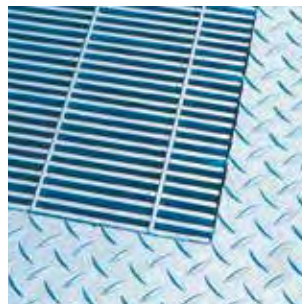

Grating panel covers



Handrails

Don't forget....

For BIM, CAD and NBS specifications see www.bilcouk.com



BIM

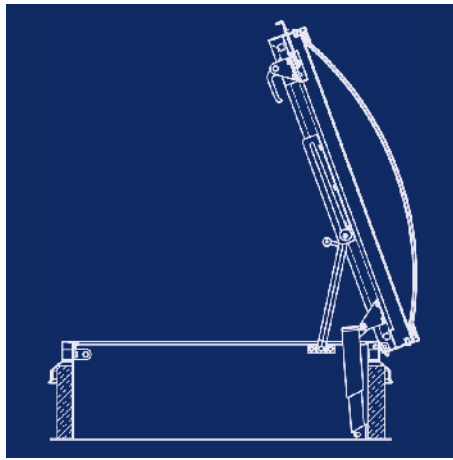

CAD



NBS

CPD from Bilco

Bilco have launched the "Access all Areas" CPD which examines the full range of access products from roof access hatches to floor doors and also looks at the use of smoke vents, ladders and safety products.

It looks at the most appropriate solutions for access requirements and examines what considerations should be made when specifying these for a project.

The CPD, whilst not being overly technical, is intended to give the audience a good understanding of what needs to be thought about when looking for the most appropriate, cost effective, and safest solution when specifying access products. It is ideal for Architects, Facility Managers, Project Managers, - in fact, for anyone who is involved in the specification, selection or procurement of access products.

Bilco will also offer a tailored CPD to your specific requirements should you wish more detailed information on Smoke Vents (covering the latest legislation on CE marking), or on Roof access hatches.

Contact the Bilco office on 01284 701696 to find out more.





Assist



Online Guidance



Telephone Advice



Request a Meeting



Request a CPD

USE BILCO ASSIST

to identify the essential design considerations required to ensure safe access points on to flat roof areas.

Visit www.bilcoul.com or scan the QR code





Bilco UK Ltd

Park Farm Business Centre, Fornham St. Genevieve
Bury St. Edmunds Suffolk, IP28 6TS, United Kingdom

Tel: +44 (0) 1284 701696

Fax: +44 (0) 1284 702531

E-Mail: bilcouk@bilco.com

Web: www.bilcouk.com



The Bilco Company reserves the right to make design changes or to withdraw designs and products shown throughout this brochure without notice as we deem advisable.